



Mini-Wire-Wrap-Stifte

Chevilles-Mini-Wire-Wrap

Mini-Wire-Wrap-pins

Werkstoff:

BZ = Bronze
MS = Messing

Oberflächenbehandlung: Code

bl = blank (0)
ag = versilbert (1)
au = vergoldet (2)
sn = verzinkt (8)

Bestellbeispiel:
Exemple de commande:
Example of order:

1003W.28
(1003W BZ sn)

Matière:

BZ = bronze
MS = laiton

Traitements de surface: Code

bl = brut (0)
ag = argenté (1)
au = doré (2)
sn = étamé (8)

Material:

BZ = bronze
MS = brass

Surface-plating: Code

bl = clean (0)
ag = silver-plated (1)
au = gold-plated (2)
sn = tin-plated (8)

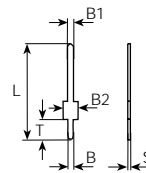
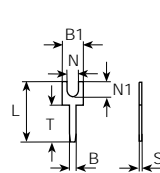

Artikel-Nr. Numéro d'article Part-No.	1003W.2() BZ	1003P.2() BZ	1003R.2() BZ	999.2() BZ	995.6() MS	993.2() BZ	1001D.2() BZ
Print Bohrung Trou Hole	Ø 0.7 T 3.8 L 6.8 B1 2.8 N 1.5 N1 2.0 D - B 0.63 S 0.63	Ø 0.7 T 5.0 L 8.0 B1 2.8 N 1.5 N1 2.0 D - B 0.63 S 0.63	Ø 0.7 T 7.6 L 10.6 B1 2.8 N 1.5 N1 2.0 D - B 0.63 S 0.63	Ø 0.7 T 3.0 L 11.8 B1 0.63 B2 1.1 N - D - B 0.63 S 0.63	Ø 0.7 T 3.2 L 12.7 B1 0.63 B2 1.1 N - D - B 0.63 S 0.63	Ø 0.7 T 15.0 L 20.5 B1 0.63 B2 1.1 N - D - B 0.63 S 0.63	Ø 0.8 T 2.2 L 12.7 B1 0.9 B2 2.0 N - D - B 0.8 S 0.56
Stand.-Packg.	2000	2000	2000	2000	2000	2000	2000
Werkzeuge Outils / Tools	1035/62	1035/62	1035/62	1035/55	1035/55	1035/3	1035/1

Artikel-Nr. Numéro d'article Part-No.	1001E.2() BZ	1001H.2() BZ	1001F.6() MS	1000E.2() BZ	1002V.6() MS	1002X05.6() MS
Print Bohrung Trou Hole	Ø 0.8 T 3.5 L 29.0 B1 0.9 B2 2.0 N - D - B 0.8 S 0.56	Ø 0.9 T 2.7 L 12.7 B1 0.9 B2 2.0 N - D - B 0.9 S 0.56	Ø 0.9 T 3.5 L 38.0 B1 0.9 B2 2.0 N - D - B 0.9 S 0.56	Ø 1.0 T 1.6 L 9.6 B1 0.6 B2 1.5 N - D - B 1.0 S 0.6	Ø 1.0 T 2.8 L 9.0 B1 0.9 B2 1.2 N - D - B 1.0 S 0.5	Ø 1.0 T 2.5 L 11.5 B1 1.5 B2 - N - D - B 1.0 S 0.5
Stand.-Packg.	1000	2000	500	2000	2000	2000
Werkzeuge Outils / Tools	1035/20	1035/1	1035/51	1035/3	1035/1	1035/59



Vogt Verbindungstechnik

Mini-Wire-Wrap-Stifte

Chevilles-Mini-Wire-Wrap

Mini-Wire-Wrap-pins

Werkstoff:

BZ = Bronze
 MS = Messing

Oberflächenbehandlung: Code

bl = blank (0)
 ag = versilbert (1)
 au = vergoldet (2)
 sn = verzinkt (8)

Bestellbeispiel:
Exemple de commande:
Example of order:

1001Z.28
 (1001Z BZ sn)

Matière:

BZ = bronze
 MS = laiton

Traitements de surface: Code

bl = brut (0)
 ag = argenté (1)
 au = doré (2)
 sn = étamé (8)

Material:

BZ = bronze
 MS = brass

Surface-plating: Code

bl = clean (0)
 ag = silver-plated (1)
 au = gold-plated (2)
 sn = tin-plated (8)

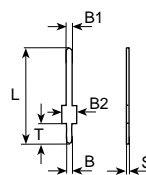

Artikel-Nr. Numéro d'article Part-No.	1001Z.2() BZ	1001C.2() BZ	1002Z.2() BZ	1003Z.2() BZ	1001B.2() BZ 1001B.6() MS	1002X08.6() MS	1003V.6() MS
Print Bohrung Trou Hole	Ø 1.0 T 3.0 L 11.3 B1 0.7 B2 1.8 N - D - B 1.0 S 0.5	Ø 1.0 T 3.0 L 11.4 B1 0.7 B2 2.7 N - D - B 1.1 S 0.5	Ø 1.0 T 3.0 L 12.0 B1 0.6 B2 1.8 N - D - B 1.0 S 0.6	Ø 1.0 T 3.0 L 15.0 B1 0.6 B2 1.8 N - D - B 1.0 S 0.6	Ø 1.0 T 3.5 L 18.5 B1 0.9 B2 2.1 N - D - B 1.0 S 0.56	Ø 1.1 T 2.5 L 11.5 B1 1.5 B2 - N - D - B 1.0 S 0.8	Ø 1.2 T 4.5 L 18.0 B1 1.5 B2 3.0 N - D - B 1.2 S 0.8
Stand.-Packg.	2000	2000	2000	2000	2000	2000	2000
Werkzeuge Outils / Tools	1035/3	1035/3	1035/55	1035/55	1035/1	1035/59	1035/58

Termi-Point

Artikel-Nr. Numéro d'article Part-No.	1003X.2() BZ	1019D.6() MS	1000M.6() MS	1000C.2() BZ	1000D.2() BZ	1000G.2() BZ
Print Bohrung Trou Hole	Ø 1.3 T 3.5 L 17.0 B1 1.0 B2 3.0 N - D - B 1.1 S 1.0	Ø 1.5/1.6 T 3.3 L 17.0 B1 1.6 B2 4.0 N - D - B 1.6 S 0.8	Ø 1.4-1.6 T 2.7 L 23.3 B1 □1.0 B2 Ø1.8 N 0.8 N1 2.5 B Ø1.4-1.6 S -	Ø 0.7 T 2.5 L 13.0 B1 0.9 B2 1.5 N - D - B 0.7 S 0.56	Ø 0.8 T 3.0 L 13.5 B1 0.9 B2 1.5 N - D - B 0.8 S 0.56	Ø 0.9 T 3.0 L 13.5 B1 0.9 B2 1.5 N - D - B 0.9 S 0.56
Stand.-Packg.	2000	2000	500	2000	2000	2000
Werkzeuge Outils / Tools	1035/69	1035/72	-	1035/1	1035/1	1035/1



Wire-Wrap-Zungen

Languettes-Wire-Wrap

Wire-Wrap-tabs

Werkstoff:

BZ = Bronze
 MS = Messing
 NS = Neusilber

Oberflächenbehandlung: Code

bl = blank (0)
 ag = versilbert (1)
 au = vergoldet (2)
 sn = verzinkt (8)

Bestellbeispiel:

Exemple de commande:
Example of order:

1019K.28
 (1019K BZ sn)

Matière:

BZ = bronze
 MS = laiton
 NS = maillechort

Traitements de surface: Code

bl = brut (0)
 ag = argenté (1)
 au = doré (2)
 sn = étamé (8)

Material:

BZ = bronze
 MS = brass
 NS = german silver

Surface-plating: Code

bl = clean (0)
 ag = silver-plated (1)
 au = gold-plated (2)
 sn = tin-plated (8)

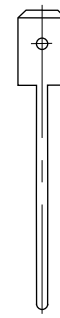
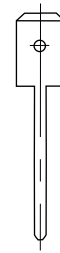
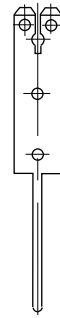
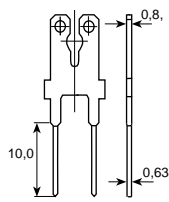

Artikel-Nr. Numéro d'article Part-No.	1019K.2() BZ	1019E.6() MS	1019F.2() BZ 1019F.6() MS	1019H.6() MS	1019M.6() MS	1019R.6() MS	1019U.7() NS
Print Bohrung Trou Hole	Ø 1.3 T 13.0 L 24.0 B1 2.8/6.3 B2 8.0 N - D 1.65 B 0.63/1.2 S 0.63/0.8	Ø 1.6 T 7.5 L 14.2 B1 2.8 B2 - N - D 1.2 B 1.5 S 0.8	Ø 1.6 T 21.0 L 28.0 B1 2.8 B2 - N - D 1.2 B 1.5 S 0.8	Ø 1.6 T 18.0 L 40.2 B1 2.8/6.3 B2 - N - D 2.1 B 1.5 S 0.8	Ø 1.6 T 20.0 L 30.0 B1 6.3 B2 - N - D 1.8 B 1.5 S 0.8	Ø 1.6 T 30.0 L 40.0 B1 6.3 B2 - N - D 1.8 B 1.5 S 0.8	Ø 1.7 T 13.7 L 25.0 B1 6.3 B2 7.5 N - D 1.65 B 1.6 S 0.8
Stand.-Packg.	500	2000	1000	500	500	500	1000
Werkzeuge Outils / Tools	1037/23	1035/16	1035/16	-	-	-	-

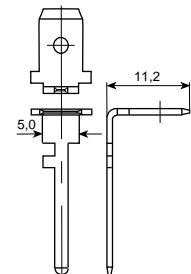
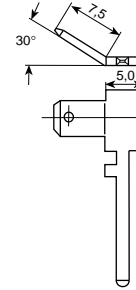
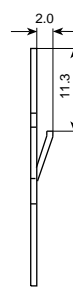
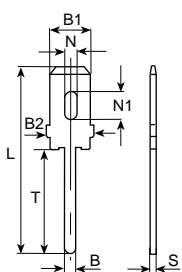

Artikel-Nr. Numéro d'article Part-No.	1019W.7() NS	1019X.7() NS	1019Z.7() NS	1019P.6() MS	1019S.6() MS	1019T.6() MS
Print Bohrung Trou Hole	Ø 1.7 T 13.7 L 25.0 B1 6.3 B2 7.5 N 1.65 N1 3.8 B 1.6 S 0.8	Ø 1.7 T 20.5 L 32.0 B1 6.3 B2 7.5 N - D 1.65 B 1.6 S 0.8	Ø 1.7 T 20.5 L 32.0 B1 6.3 B2 7.5 N 1.65 N1 3.8 B 1.6 S 0.8	Ø 1.7 T 11.0 L 33.0 B1 6.3 B2 8.0 N - D 1.8 B 1.6 S 0.8	Ø 1.7 T 14.5 L 26.0 B1 4.8 B2 - N - D 1.45 B 1.6 S 0.8	Ø 1.7 T 14.5 L 22.0 B1 6.3 B2 8.0 N - D 1.65 B 1.6 S 0.8
Stand.-Packg.	1000	1000	1000	1000	1000	1000

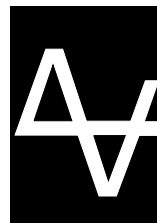

Winkelstifte, Winkel-Wrap-Stifte für gedruckte Schaltungen

Chevilles angulaires, Chevilles angulaires Wire-Wrap pour circuits imprimés

Angle pins, Wire-Wrap angle pins for printed circuitry

Werkstoff:

BZ = Bronze
MS = Messing
NS = Neusilber

Oberflächenbehandlung: Code

bl = blank (0)
ag = versilbert (1)
au = vergoldet (2)
sn = verzinkt (8)

Bestellbeispiel:
Exemple de commande:
Example of order:

1080V.68 lose / en vrac / in bulk
(1080V MS sn)

magaziniert / emmagasiné / wired

01080V.68
(01080V MS sn)

Matière:

BZ = bronze
MS = laiton
NS = maillechort

Traitements de surface: Code

bl = brut (0)
ag = argenté (1)
au = doré (2)
sn = étamé (8)

Material:

BZ = bronze
MS = brass
NS = german silver

Surface-plating: Code

bl = clean (0)
ag = silver-plated (1)
au = gold-plated (2)
sn = tin-plated (8)

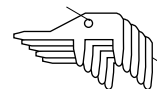
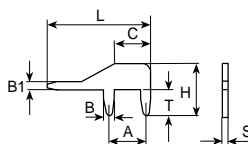

lose / en vrac / in bulk

magaziniert / emmagasiné / wired

Artikel-Nr. Numéro d'article Part-No.	1080U.6() MS	1081L.6() MS	01081L.6() MS	1080Q.6() MS	1080H.6() MS	1080C.6() MS	1080P.6() MS
Print Bohrung → Trou Hole	Ø 0.8 T 2.1 H 3.5 L 9.5 C 6.7 A 2.5 B1 0.6 B 0.8 S 0.5	Ø 0.8 T 2.4 H 5.8 L 11.85 C - A 2.5 B1 0.7 B 0.7 S 0.6	Ø 0.8 T 2.4 H 5.8 L 11.85 C - A 2.5 B1 0.7 B 0.7 S 0.6	Ø 0.8 T 3.0 H 4.4 L 8.5 C 5.0 A 2.5 B1 0.7 B 0.7 S 0.6	Ø 0.8 T 3.0 H 4.4 L 11.2 C 5.0 A 2.5 B1 0.7 B 0.7 S 0.6	Ø 1.0 T 2.5 H 4.5 L 8.0 C 3.5 A 3.0 B1 1.0 B 1.0 S 0.5	Ø 1.0 T 2.5 H 4.5 L 8.8 C 3.5 A 3.0 B1 1.0 B 1.0 S 0.5
Stand.-Packg.	5000	2000	5400	5000	2000	5000	5000
Werkzeuge Outils / Tools	1037/34	1037/34	1051B	1037/34	1037/34	1037/25	1037/25

Artikel-Nr. Numéro d'article Part-No.	1080V.6() MS	01080V.6() MS	1080S.6() MS	01080S.6() MS	1080Y.6() MS	1080W.6() MS	1080R.6() MS
Print Bohrung → Trou Hole	Ø 1.0 T 2.5 H 5.5 L 7.2 C 2.3 A 2.5 B1 1.0 B 1.0 S 0.5	Ø 1.0 T 2.5 H 5.5 L 7.2 C 2.3 A 2.5 B1 1.0 B 1.0 S 0.5	Ø 1.0 T 2.5 H 5.5 L 8.8 C 2.3 A 2.5 B1 1.0 B 1.0 S 0.5	Ø 1.0 T 2.5 H 5.5 L 8.8 C 2.3 A 2.5 B1 1.0 B 1.0 S 0.5	Ø 1.1 T 3.0 H 4.6 L 18.5 C - A 5.0 B1 1.6 B 0.9 S 0.8	Ø 1.1 T 3.0 H 5.0 L 18.5 C 5.5 A 5.0 B1 1.6 B 0.9 S 0.8	Ø 1.1 T 3.0 H 5.0 L 28.0 C 5.5 A 5.0 B1 1.6 B 0.9 S 0.8
Stand.-Packg.	5000	4800	5000	4800	2000	2000	1000
Werkzeuge Outils / Tools	1037/25	1051V	1037/25	1051S	1037/44	1037/39	1037/39



Vogt Verbindungstechnik

Winkelstifte, Winkel-Wrap-Stifte für gedruckte Schaltungen

Chevilles angulaires, Chevilles angulaires Wire-Wrap pour circuits imprimés

Angle pins, Wire-Wrap angle pins for printed circuitry

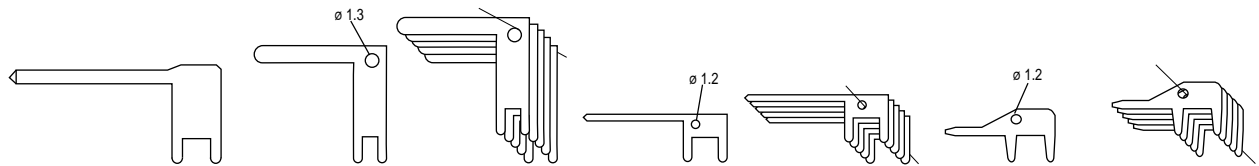

Artikel-Nr. Numéro d'article Part-No.	1080E.6() MS	1080G.6() MS	01080G.6() MS	1080T.6() MS	01080T.6() MS	1080M08.6() MS	01080M08.6() MS
Print Bohrung Trou Hole	Ø 1.1 T 3.0 H 13.0 L 28.0 C 5.5 A 5.0 B1 1.6 B 0.9 S 0.8	Ø 1.1 T 3.0 H 17.5 L 15.5 C - A 2.5 B1 1.6 B 0.8 S 1.0	Ø 1.1 T 3.0 H 17.5 L 15.5 C - A 2.5 B1 1.6 B 0.8 S 1.0	Ø 1.1/1.2 T 3.0 H 6.3 L 19.0 C - A 5.0 B1 0.8 B 1.0 S 0.8	Ø 1.1/1.2 T 3.0 H 6.3 L 19.0 C - A 5.0 B1 0.8 B 1.0 S 0.8	Ø 1.2 T 3.5 H 7.0 L 14.5 C 4.4 A 5.0 B1 1.0 B 1.1 S 0.8	Ø 1.2 T 3.5 H 7.0 L 14.5 C 4.4 A 5.0 B1 1.0 B 1.1 S 0.8
Stand.-Packg.	2000	2000	1600	2000	2000	2000	2000
Werkzeuge Outils / Tools	1037/24	1037/24	1051C	1037/39	1051T	1037/24	1051G

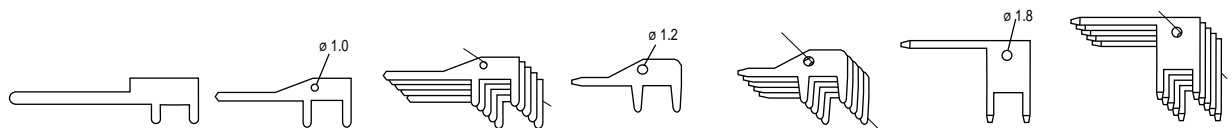

Artikel-Nr. Numéro d'article Part-No.	1080K.6() MS	1080A.6() MS	01080A.6() MS	1080M.6() MS	01080M.6() MS	1080X.6() MS 1080X.9() ST	01080X.6() MS 01080X.9() ST
Print Bohrung Trou Hole	Ø 1.2/1.3 T 2.5 H 6.0 L 25.0 C 9.0 A 5.0 B1 1.5 B 1.0 S 0.8	Ø 1.3 T 3.5 H 6.5 L 18.0 C 4.5 A 5.0 B1 1.0 B 1.1 S 1.0	Ø 1.3 T 3.5 H 6.5 L 18.0 C 4.5 A 5.0 B1 1.0 B 1.1 S 1.0	Ø 1.3 T 3.5 H 7.0 L 14.5 C 4.4 A 5.0 B1 1.0 B 1.1 S 1.0	Ø 1.3 T 3.5 H 7.0 L 14.5 C 4.4 A 5.0 B1 1.0 B 1.1 S 1.0	Ø 1.3 T 4.2 H 10.8 L 17.0 C - A 5.0 B1 1.0 B 1.0 S 1.0	Ø 1.3 T 4.2 H 10.7 L 17.0 C - A 5.0 B1 1.0 B 1.0 S 1.0
Stand.-Packg.	1000	2000	1600	2000	1600	2000	1600
Werkzeuge Outils / Tools	1037/39	1037/24	1051A	1037/24	1051M	1037/24	1051X



Artikel-Nr. Numéro d'article Part-No.	1080B.2() BZ 1080B.6() MS	1080L.6() MS	1080D.6() MS	1080Z.2() BZ	1082.6() MS	1084.6() MS	1081.7() NS
Print Bohrung Trou Hole	Ø 1.3 T 5.0 H 8.0 L 18.0 C 4.5 A 5.0 B1 1.0 B 1.1 S 1.0	Ø 1.2/1.3 T 2.5 H 6.0 L 17.5 C 9.0 A 5.0 B1 3.5 B 1.0 S 0.8	Ø 1.65 T 4.8 H 8.3 L 22.8 C - A 6.4 B1 3.5 B 1.6 S 0.8	Ø 0.8 T 0.9/1.7 H 2.45 L 12.7 C 5.4 A 3.0 B1 0.6 B 0.55 S 0.65	Ø 1.2 T 3.0 H 9.0 L 8.0 C - A 5.0 B1 - B 1.0 S 0.8	Ø 1.4/1.5 T 3.2 H 5.7 L 9.0 C - A - B1 2.5 B 1.45 S 0.6	Ø 1.1 T 3.5 H 6.05 L 4.0 C - A - B1 - B 1.1 S 0.5
Stand.-Packg.	2000	1000	1000	2000	2000	2000	5000
Werkzeuge Outils / Tools	1037/24	1037/39	-	-	-	-	-