

0.250" (6.35mm) Quick Disconnect Terminals

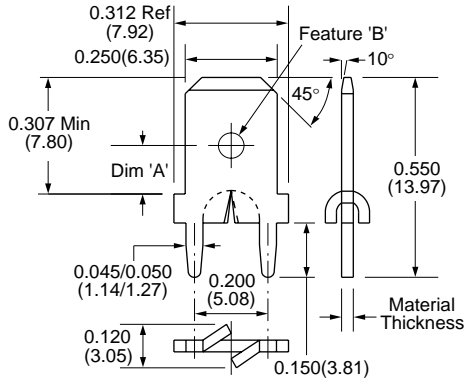

U.S. Patent No. 4,688,866

For exact finish specifications and available special finishes, see Finish Table (page 91).

Loose Part No.	1021	1198
Reeled Part No.	6021-6	6198-6
Feature 'B'	0.070" (1.78mm) Hole	0.070" (1.78mm) Dimple
Dim 'A'	0.134" (3.40mm)	0.160" (4.06mm)
Mounting Type	Stable-Lok™ Splay Outward or Inward	
Material Thickness/ Type	0.032" (0.81mm) Brass	
Standard Finish	Loose: 100% Matt Tin over Copper Reeled: 95/5 Matt Tin/Lead over Copper	
Mounting Hole Diameter	0.058" ±0.003" (1.47mm ±0.076mm)	
Applicator System	Loose: ZPT81-A Reeled: Model 7000, 9700, 9718	

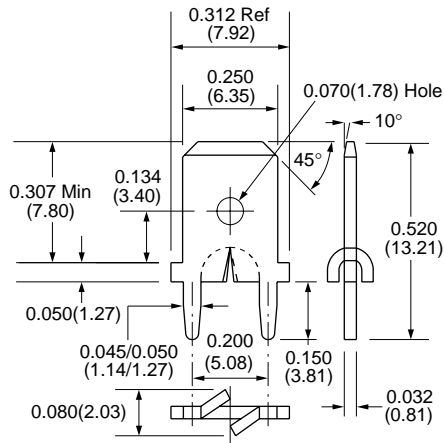

Loose Part No.	1061
Reeled Part No.	6061-6
Mounting Type	Stable-Lok™ Splay Outward or Inward
Material Thickness/ Type	0.032" (0.81mm) Brass
Standard Finish	Loose: 100% Matt Tin over Copper Reeled: 95/5 Matt Tin/Lead over Copper
Mounting Hole Diameter	0.058" ±0.003" (1.47mm ±0.076mm)
Applicator System	Loose: ZPT81-A Reeled: Model 7000, 9700, 9718

U.S. Patent No. 4,688,866

For exact finish specifications and available special finishes, see Finish Table (page 91).

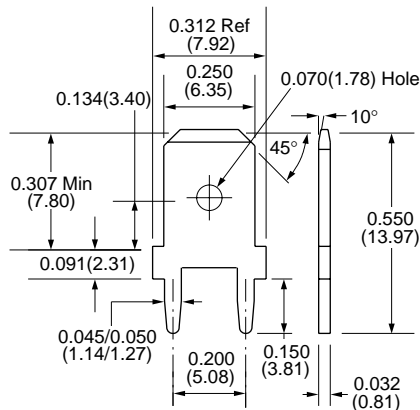

Loose Part No.	836/836-Tape
Reeled Part No.	6836-6
Mounting Type	Outward or Inward Splay
Material Thickness/ Type	0.032" (0.81mm) Brass
Standard Finish	Loose: 100% Matt Tin over Copper Reeled: 95/5 Matt Tin/Lead over Copper
Mounting Hole Diameter	0.058" ±0.003" (1.47mm ±0.076mm)
Applicator System	Loose: ZPT81-A, Model 8000 Reeled: Model 7000, 9700, 9718

For exact finish specifications and available special finishes, see Finish Table (page 91).

0.250" (6.35mm) Quick Disconnect Terminals

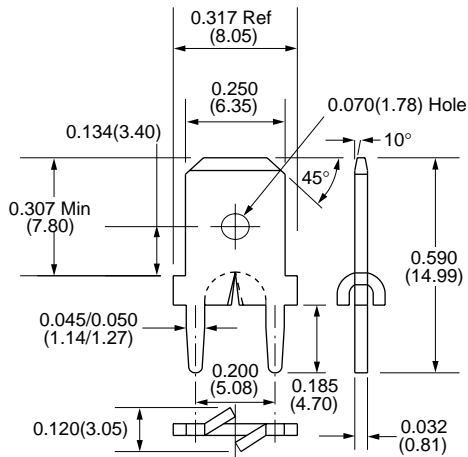

Loose Part No.	1060
Reeled Part No.	6060-6
Mounting Type	Stable-Lok™ Splay Outward or Inward
Material Thickness/Type	0.032" (0.81mm) Brass
Standard Finish	Loose: 100% Matt Tin over Copper Reeled: 95/5 Matt Tin/Lead over Copper
Mounting Hole Diameter	0.058" ± 0.003" (1.47mm ± 0.076mm)
Applicator System	Loose: ZPT81-A Reeled: Model 7000, 9700, 9718

U.S. Patent No. 4,688,866

For exact finish specifications and available special finishes, see Finish Table (page 91).

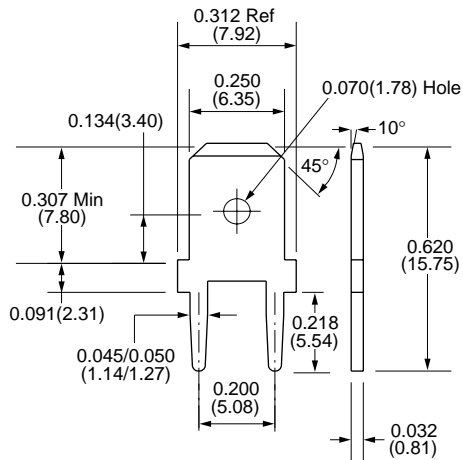

Loose Part No.	906
Reeled Part No.	N/A
Mounting Type	Outward or Inward Splay
Material Thickness/Type	0.032" (0.81mm) Brass
Standard Finish	100% Matt Tin over Copper
Mounting Hole Diameter	0.058" ± 0.003" (1.47mm ± 0.076mm)
Applicator System	Loose: ZPT81-A

For exact finish specifications and available special finishes, see Finish Table (page 91).

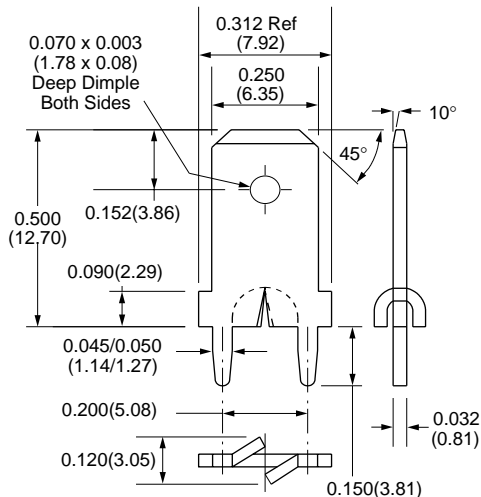

Loose Part No.	1045
Reeled Part No.	6045-6
Mounting Type	Stable-Lok™ Splay Outward or Inward
Material Thickness/Type	0.032" (0.81mm) Brass
Standard Finish	Loose: 100% Matt Tin over Copper Reeled: 95/5 Matt Tin/Lead over Copper
Mounting Hole Diameter	0.058" ± 0.003" (1.47mm ± 0.076mm)
Applicator System	Loose: ZPT81-A Reeled: Model 7000, 9700, 9718

U.S. Patent No. 4,688,866

For exact finish specifications and available special finishes, see Finish Table (page 91).

0.250" (6.35mm) Quick Disconnect Terminals

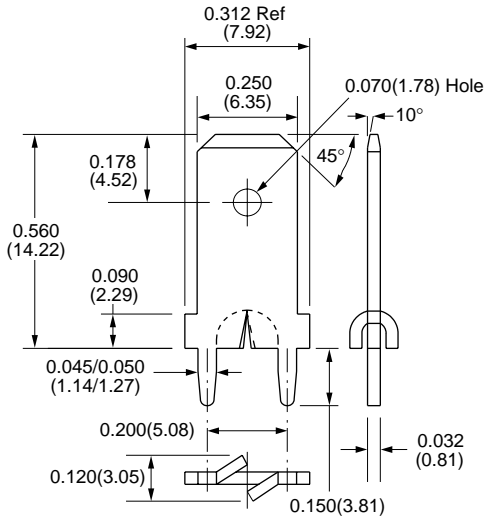

Loose Part No.	1041
Reeled Part No.	6041-6
Mounting Type	Stable-Lok™ Splay Outward or Inward
Material Thickness/ Type	0.032" (0.81mm) Brass
Standard Finish	Loose: 100% Matt Tin over Copper Reeled: 95/5 Matt Tin/Lead over Copper
Mounting Hole Diameter	0.058" ±0.003" (1.47mm ±0.076mm)
Applicator System	Loose: ZPT81-A Reeled: Model 7000, 9700, 9718

U.S. Patent No. 4,688,866

For exact finish specifications and available special finishes, see Finish Table (page 91).

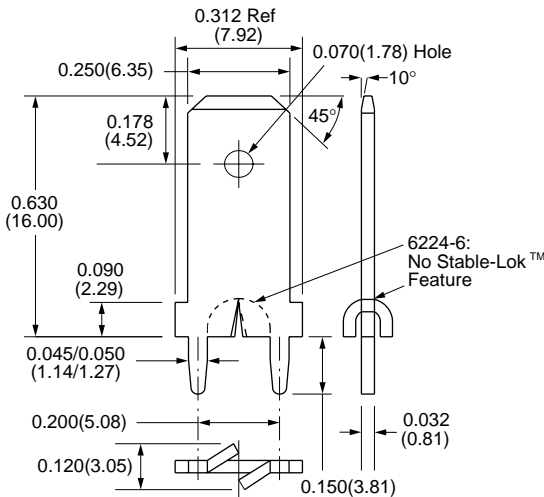

Loose Part No.	1057	N/A
Reeled Part No.	6057-6	6224-6
Mounting Type	Stable-Lok™ Splay Splay Outward or Inward	Outward or Inward
Material Thickness/ Type	0.032" (0.81mm) Brass	0.032" (0.81mm) Brass
Standard Finish	Loose: 100% Matt Tin over Copper Reeled: 95/5 Matt Tin/Lead over Copper	
Mounting Hole Diameter	0.058" ±0.003" (1.47mm ±0.076mm)	0.058" ±0.003" (1.47mm ±0.076mm)
Applicator System	Loose: ZPT81-A Reeled: Model 7000, 9700, 9718	

U.S. Patent No. 4,688,866

For exact finish specifications and available special finishes, see Finish Table (page 91).

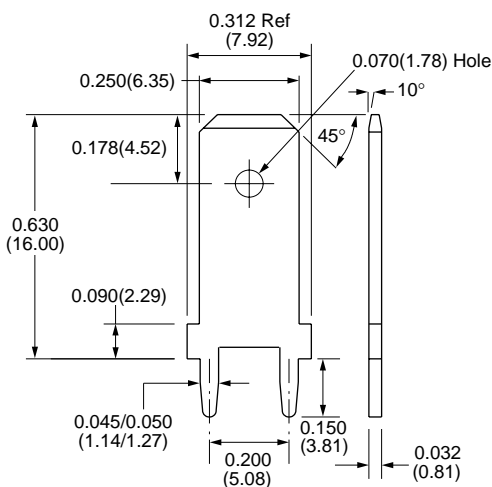

Loose Part No.	972
Reeled Part No.	N/A
Mounting Type	Outward or Inward Splay
Material Thickness/ Type	0.032" (0.81mm) Brass
Standard Finish	100% Matt Tin over Copper
Mounting Hole Diameter	0.058" ±0.003" (1.47mm ±0.076mm)
Applicator System	Loose: ZPT81-A

For exact finish specifications and available special finishes, see Finish Table (page 91).

0.250" (6.35mm) Quick Disconnect Terminals

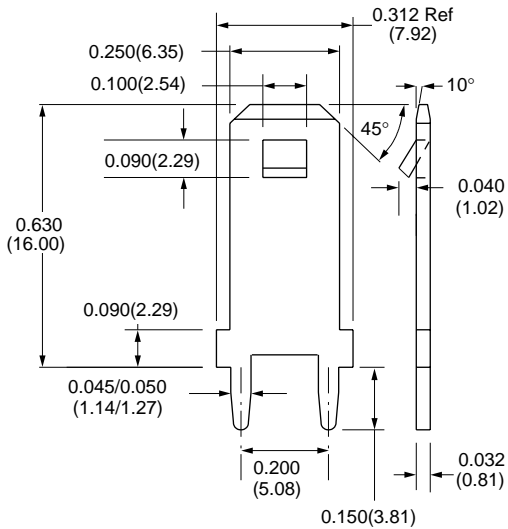

Loose Part No.	972-TAB
Reeled Part No.	N/A
Mounting Type	Outward or Inward Splay
Material Thickness/Type	0.032" (0.81mm) Brass
Standard Finish	100% Matt Tin over Copper
Mounting Hole Diameter	0.058" ±0.003" (1.47mm ±0.076mm)
Applicator System	Loose: ZPT81-A

For exact finish specifications and available special finishes, see Finish Table (page 91).

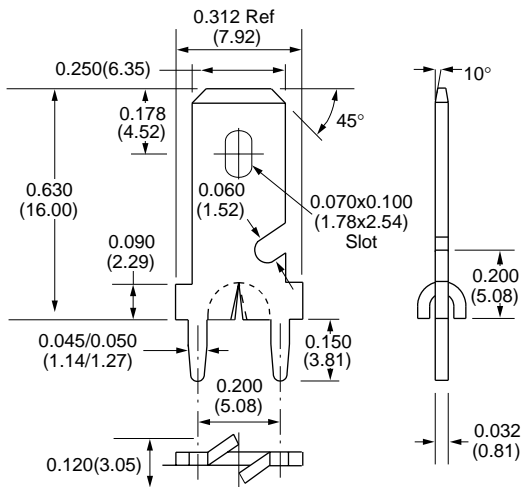

Loose Part No.	N/A
Reeled Part No.	6212-6
Mounting Type	Stable-Lok™ Splay Outward or Inward
Material Thickness/Type	0.032" (0.81mm) Brass
Standard Finish	Reeled: 95/5 Matt Tin/Lead over Copper
Mounting Hole Diameter	0.058" ±0.003" (1.47mm ±0.076mm)
Applicator System	Loose: ZPT81-A Reeled: Model 7000, 9700, 9718

U.S. Patent No. 4,688,866

For exact finish specifications and available special finishes, see Finish Table (page 91).

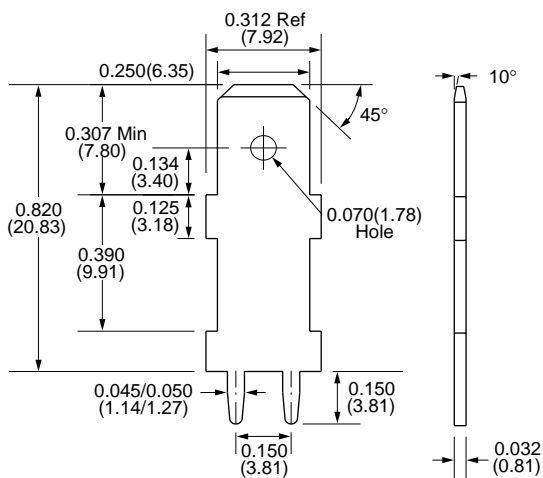

Loose Part No.	953-MOD
Reeled Part No.	N/A
Mounting Type	Outward or Inward Splay
Material Thickness/Type	0.032" (0.81mm) Brass
Standard Finish	100% Matt Tin over Copper
Mounting Hole Diameter	0.058" ±0.003" (1.47mm ±0.076mm)
Applicator System	Loose: ZPT81-A

For exact finish specifications and available special finishes, see Finish Table (page 91).

0.250" (6.35mm) Quick Disconnect Terminals

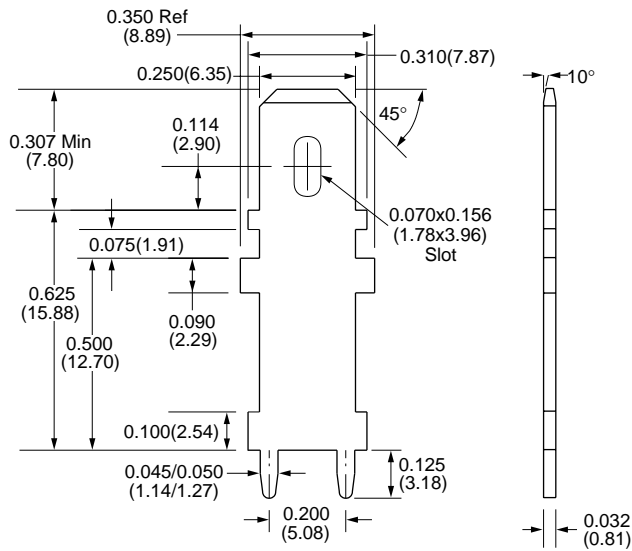

Loose Part No.	1113-6
Reeled Part No.	6113-6
Mounting Type	Outward or Inward Splay
Material Thickness/ Type	0.032" (0.81mm) Brass
Standard Finish	Loose: 95/5 Matt Tin/Lead over Copper Reeled: 95/5 Matt Tin/Lead over Copper
Mounting Hole Diameter	0.058" ±0.003" (1.47mm ±0.076mm)
Applicator System	Loose: ZPT81-A Reeled: Model 9700, 9718

For exact finish specifications and available special finishes, see Finish Table (page 91).

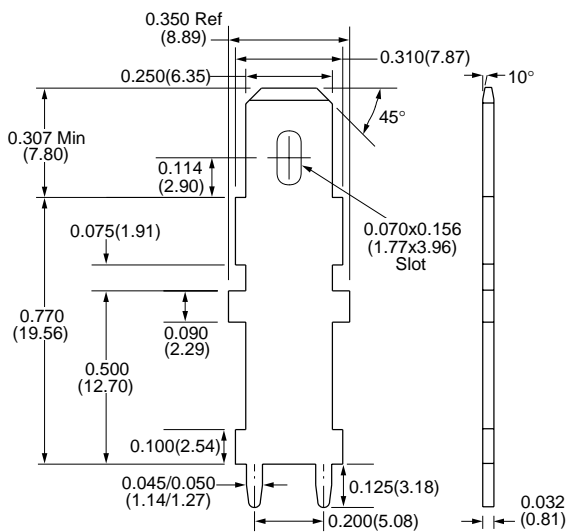

Loose Part No.	1112-6
Reeled Part No.	6112-6
Mounting Type	Outward or Inward Splay
Material Thickness/ Type	0.032" (0.81mm) Brass
Standard Finish	Loose: 95/5 Matt Tin/Lead over Copper Reeled: 95/5 Matt Tin/Lead over Copper
Mounting Hole Diameter	0.058" ±0.003" (1.47mm ±0.076mm)
Applicator System	Loose: ZPT81-A Reeled: Model 9700, 9718

For exact finish specifications and available special finishes, see Finish Table (page 91).

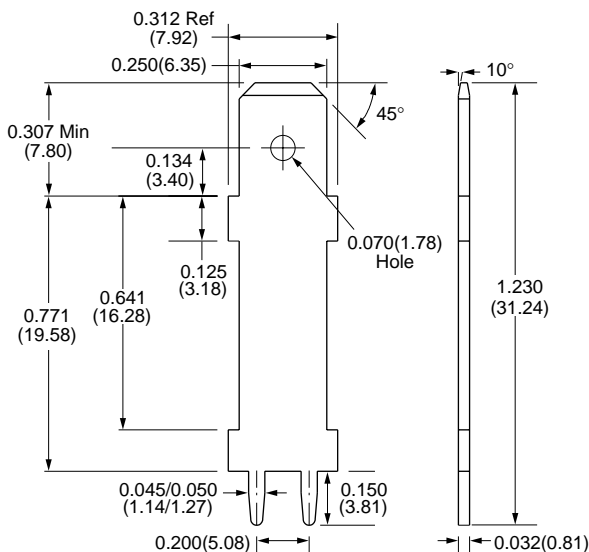

Loose Part No.	953
Reeled Part No.	N/A
Mounting Type	Outward or Inward Splay
Material Thickness/ Type	0.032" (0.81mm) Brass
Standard Finish	100% Matt over Copper
Mounting Hole Diameter	0.058" ±0.003" (1.47mm ±0.076mm)
Applicator System	Loose: ZPT81-A

For exact finish specifications and available special finishes, see Finish Table (page 91).

0.250" (6.35mm) Quick Disconnect Terminals

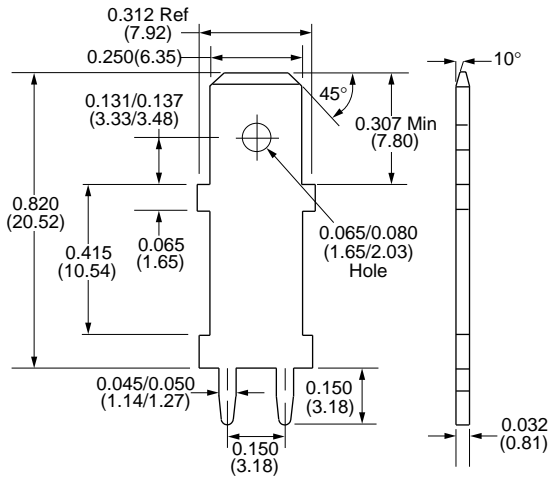

Loose Part No.	N/A
Reeled Part No.	6110-6
Mounting Type	Outward Splay
Material Thickness/Type	0.032" (0.81mm) Brass
Standard Finish	Reeled: 95/5 Matt Tin/Lead over Copper
Mounting Hole Diameter	0.058" ±0.003" (1.47mm ±0.076mm)
Applicator System	Loose: ZPT81-A Reeled: Model 9700, 9718

For exact finish specifications and available special finishes, see Finish Table (page 91).

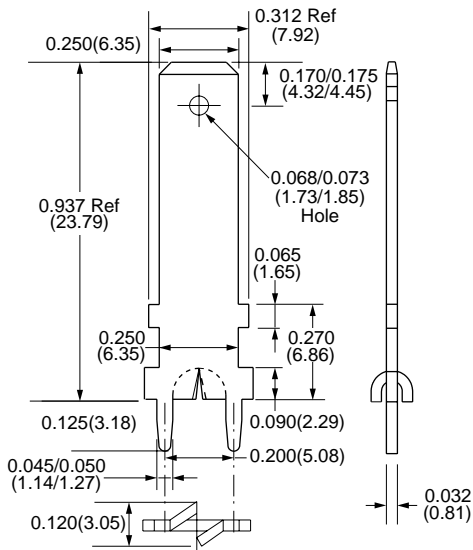

Loose Part No.	1173
Reeled Part No.	6173-6
Mounting Type	Stable Lok™ Splay Outward or Inward
Material Thickness/Type	0.032" (0.81mm) Brass
Standard Finish	Loose: 100% Matt Tin over Copper Reeled: 95/5 Matt Tin/Lead over Copper
Mounting Hole Diameter	0.058" ±0.003" (1.47mm ±0.076mm)
Applicator System	Loose: ZPT81-A Reeled: Model 9700, 9718

U.S. Patent No. 4,688,866

For exact finish specifications and available special finishes, see Finish Table (page 91).

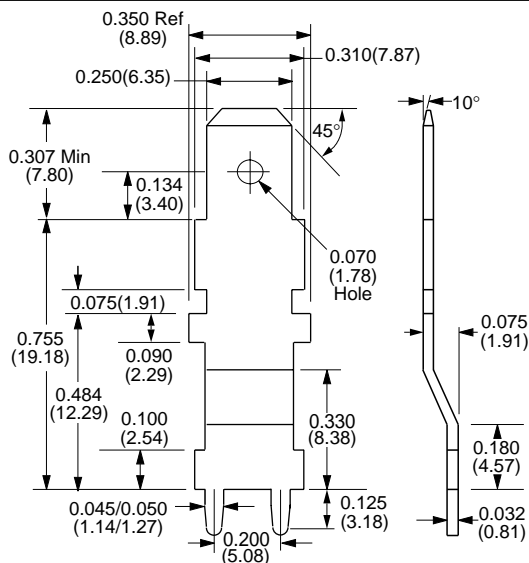

Loose Part No.	1131
Reeled Part No.	N/A
Mounting Type	Outward or Inward Splay
Material Thickness/Type	0.032" (0.81mm) Brass
Standard Finish	Loose: 100% Matt Tin over Copper
Mounting Hole Diameter	0.058" ±0.003" (1.47mm ±0.076mm)
Applicator System	Loose: ZPT81-1131

For exact finish specifications and available special finishes, see Finish Table (page 91).