



## Steckzungen für gedruckte Schaltungen

Masse im Steckbereich  
DIN 46342 Teil 1

## Languettes plates pour circuits imprimés

Dimensions zone d'emboîtement selon  
DIN 46342 partie 1

## Mounting tabs for printed circuitry

Dimensions in the tab sector  
DIN 46342 part 1

Werkstoff:

BZ = Bronze  
MS = Messing

Oberflächenbehandlung: Code

bl = blank (0)  
ag = versilbert (1)  
au = vergoldet (2)  
sn = verzinkt (8)

**Bestellbeispiel:**

**Exemple de commande:**  
**Example of order:**

↓  
**3827B08.68** lose / en vrac / in bulk  
(3827B/0.8 MS sn)

← magaziniert / emmagasiné / wired

↓  
**03827B08.68**  
(03827B/0.8 MS sn)

Matière:

BZ = bronze  
MS = laiton

Traitements de surface: Code

bl = brut (0)  
ag = argenté (1)  
au = doré (2)  
sn = étamé (8)

Material:

BZ = bronze  
MS = brass

Surface-plating: Code

bl = clean (0)  
ag = silver-plated (1)  
au = gold-plated (2)  
sn = tin-plated (8)

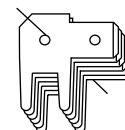
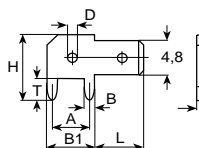

magaziniert / emmagasiné / wired

# 4,8 mm

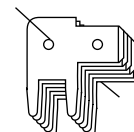
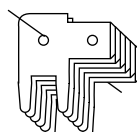
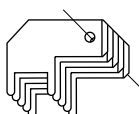

Artikel-Nr. Numéro d'article → Part-No.	<b>03827B08.2( ) BZ</b> <b>03827B08.6( ) MS</b>	<b>0382705.6( ) MS</b>	<b>03827G08.2( ) BZ</b>
Print Bohrung → Trou Hole	Ø 1.2 T 3.0 H 10.0 A 5.0 B1 6.2 L 7.1 D 1.6 B 1.2 S 0.8	Ø 1.2 T 5.2 H 13.0 A 5.0 B1 6.3 L 6.7 D 1.4 B 1.3 S 0.5	Ø 1.2 T 5.2 H 13.0 A 5.0 B1 6.3 L 6.7 D 1.3 B 1.1 S 0.8
Stand.-Packg.	2000	3200	2000
Werkzeuge Outils / Tools	<b>1045B</b>	<b>1045W05</b>	<b>1045W08</b>

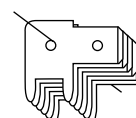
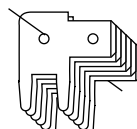
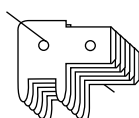

Artikel-Nr. Numéro d'article → Part-No.	<b>03827K05.6( ) MS</b>	<b>0382708.6( ) MS</b>	<b>03827K08.6( ) MS</b>
Print Bohrung → Trou Hole	Ø 1.2/1.3 T 3.0 H 10.8 A 5.0 B1 6.3 L 6.7 D 1.4 B 1.3 S 0.5	Ø 1.2/1.3 T 5.2 H 13.0 A 5.0 B1 6.3 L 6.7 D 1.4 B 1.3 S 0.8	Ø 1.3 T 3.0 H 10.8 A 5.0 B1 6.3 L 6.7 D 1.4 B 1.3 S 0.8
Stand.-Packg.	3200	2000	2000
Werkzeuge Outils / Tools	<b>1045W05</b>	<b>1045W08</b>	<b>1045W08</b>

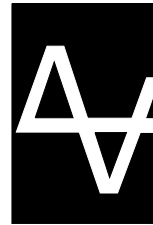

# Vogt Verbindungstechnik

## Steckungen für ge- druckte Schaltungen

Masse im Steckbereich  
DIN 46342 Teil 1

## Languettes plates pour circuits imprimés

Dimensions zone d'emboîtement selon  
DIN 46342 partie 1

## Mounting tabs for printed circuitry

Dimensions in the tab sector  
DIN 46342 part 1

**4,8  
mm**

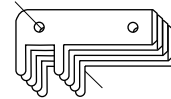

Artikel-Nr. Numéro d'article → Part-No.						<b>03827P08.2( ) BZ</b> <b>03827P08.6( ) MS</b> Ø 1.3/1.4 T 4.0 H 8.8 A 5.0 B1 6.3 L 12.3 D 1.5 B 1.3 S 0.8 2000
Print Bohrung → Trou Hole						
Stand.-Packg.						
Werkzeuge Outils / Tools						<b>106308</b>