

	5mm Fuse Clip		Connector	
Loose Part No.	1230	1230T	1184	1184T
Reeled Part No.	6230-6		6184-6	
Dim 'A'	0.165" (4.19mm)		0.095" (2.41mm)	
Material Thickness/ Type	0.016" (0.40mm) Phosphor Bronze			
Standard Finish	95/5 Matt Tin/Lead over Copper			
Feeder System	Surf Shooter SMT™ – Continuous Strip			

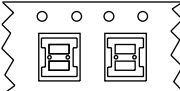

Also available in Carrier Tape (1230T) (for 16mm Tape Feeder)

U.S. Patent No. 5,695,348 and other U.S. and international patents
For exact finish specifications and available special finishes, see Finish Table (page 91).

Fuse Clip Receptacles

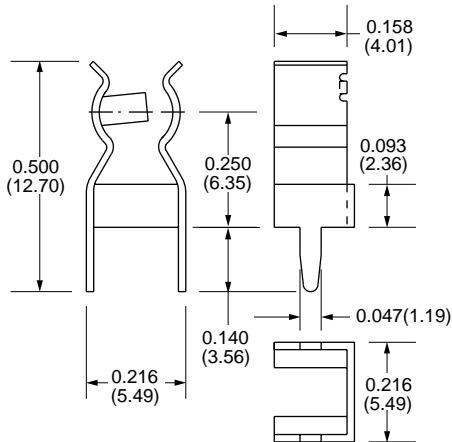

Loose Part No.	990
Fuse Size	0.197" (5mm)
Fuse Receptacle Type	Standard w/ Fuse Stop
Material Thickness/ Type	0.016" (0.41mm) Brass
Standard Finish	100% Matt Tin over Copper
Mounting Hole Diameter	0.052" (1.32mm)

For exact finish specifications and available special finishes, see Finish Table (page 91).

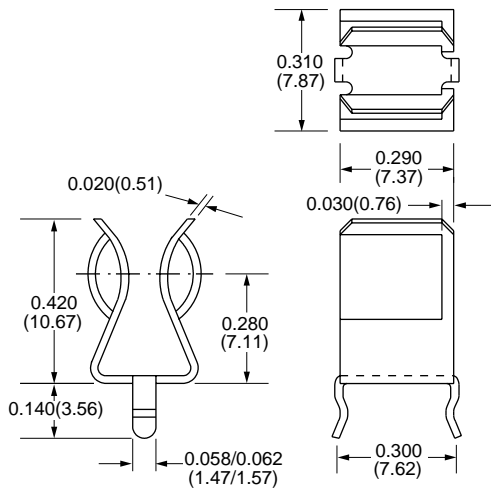

Loose Part No.	1047
Fuse Size	1/4" (6.35mm)
Fuse Receptacle Type	Snap-In™ w/Fuse Stop
Material Thickness/ Type	0.020" (0.51mm) Brass
Standard Finish	100% Matt Tin over Copper
Mounting Hole Diameter	0.067" (1.70mm)

For exact finish specifications and available special finishes, see Finish Table (page 91).

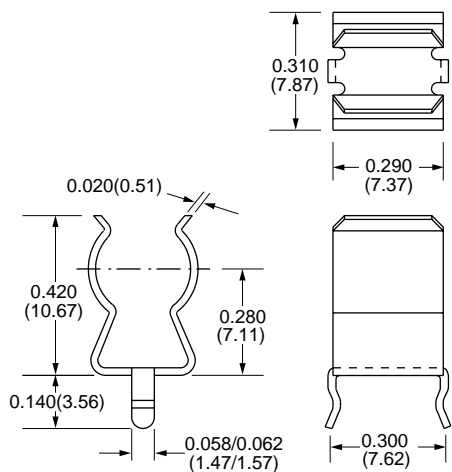

Loose Part No.	1048
Fuse Size	1/4" (6.35mm)
Fuse Receptacle Type	Snap-In™ w/o Fuse Stop
Material Thickness/ Type	0.020" (0.51mm) Brass
Standard Finish	100% Matt Tin over Copper
Mounting Hole Diameter	0.067" (1.70mm)

For exact finish specifications and available special finishes, see Finish Table (page 91).

1/4" (6.35mm) Fuse Clip Receptacles

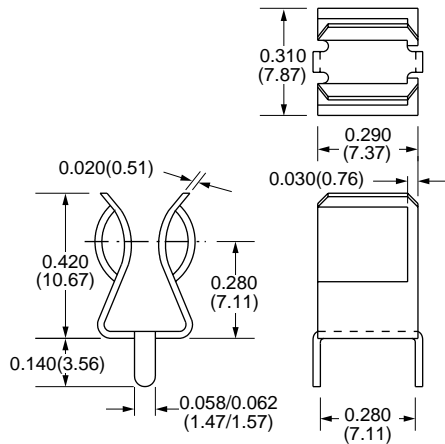

Loose Part No.	926
Fuse Size	1/4" (6.35mm)
Fuse Receptacle Type	Standard w/ Fuse Stop
Material Thickness/ Type	0.020" (0.51mm) Brass
Standard Finish	100% Matt Tin over Copper
Mounting Hole Diameter	0.067" (1.70mm)

For exact finish specifications and available special finishes, see Finish Table (page 91).

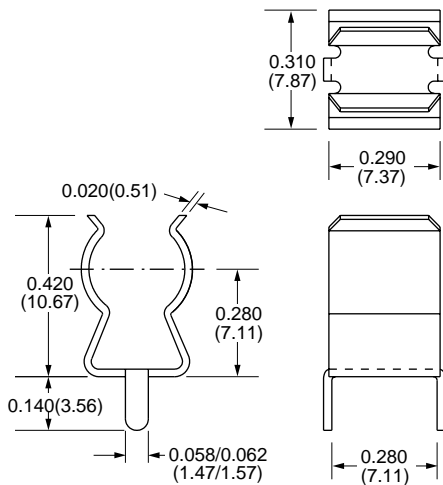

Loose Part No.	927
Fuse Size	1/4" (6.35mm)
Fuse Receptacle Type	Standard w/o Fuse Stop
Material Thickness/ Type	0.020" (0.51mm) Brass
Standard Finish	100% Matt Tin over Copper
Mounting Hole Diameter	0.067" (1.70mm)

For exact finish specifications and available special finishes, see Finish Table (page 91).

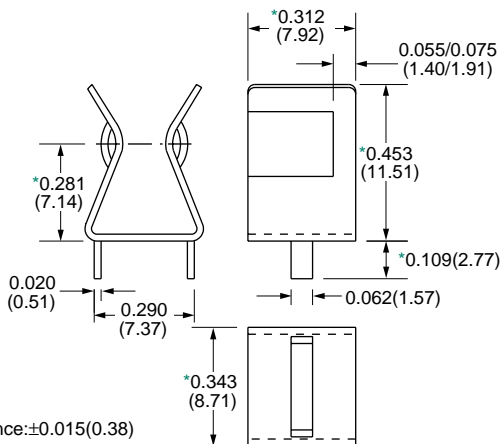

Loose Part No.	798
Fuse Size	1/4" (6.35mm)
Fuse Receptacle Type	Standard w/ Fuse Stop
Material Thickness/ Type	0.020" (0.51mm) Brass
Standard Finish	100% Matt Tin over Copper
Mounting Hole Diameter	0.070" (1.78mm)

For exact finish specifications and available special finishes, see Finish Table (page 91).