

Vogt Verbindungstechnik

Steckzungen

Masse im Steckbereich
 DIN 46342 Teil 1

Languettes

Dimensions zone d'emboîtement selon
 DIN 46342 partie 1

Tabs

Dimensions in the tab sector
 DIN 46342 part 1

Werkstoff:

BZ = Bronze
 MS = Messing
 NS = Neusilber
 RF = rostfreier Stahl
 ST = Stahl

Matière:

BZ = bronze
 MS = laiton
 NS = maillechort
 RF = acier inox
 ST = acier

Material:

BZ = bronze
 MS = brass
 NS = german silver
 RF = stainless steel
 ST = steel

Oberflächenbehandlung:

bl = blank (0)
 ag = versilbert (1)
 au = vergoldet (2)
 ni = vernickelt (5)
 sn = reinverzinkt (7)

Traitements de surface:

bl = brut (0)
 ag = argenté (1)
 au = doré (2)
 ni = nickelé (5)
 sn = étamage pur (7)

Surface-plating:

bl = clean (0)
 ag = silver-plated (1)
 au = gold-plated (2)
 ni = nickel-plated (5)
 sn = pure tin-plated (7)

Bestellbeispiel

Exemple de commande:
Example of order:

3840.95
 (3840 ST ni)

6,3
mm

	øD mm	B mm	L mm	S mm	Werkstoff Matière Material	Stand.- Packg.	Artikel-Nr. Numéro d'article Part-No.
	-	8.0	19.0	0.8	RF bl	1000	3840.80 *1
	-	8.0	19.0	0.8	ST	1000	3840.9() *1
	3.2	8.0	19.0	0.8	MS	1000	3846.6()
	3.7	8.0	19.0	0.8	MS	1000	3849.6()
	4.3	8.0	19.0	0.8	MS	1000	3854.6()
	5.3	8.0	19.0	0.8	MS	1000	3859.6()
	-	8.0	30.5	0.8	RF bl	1000	3870B.80 *1
	3.2	8.0	30.5	0.8	MS	1000	3871B.6()
	3.7	8.0	30.5	0.8	MS	1000	3873B.6()
	3.7	8.0	30.5	0.8	RF bl	1000	3873B.80
	4.2	8.0	27.0	0.8	MS	1000	38750B.6()

*1 Ohne Bohrung / Sans trou / Without hole



Vogt Verbindungstechnik

Steckzungen

Masse im Steckbereich
 DIN 46342 Teil 1

Languettes

Dimensions zone d'emboîtement selon
 DIN 46342 partie 1

Tabs

Dimensions in the tab sector
 DIN 46342 part 1

6,3
mm

30° + 45° + 90°	øD mm	B mm	L1 mm	L2 mm	W mm	S mm	Werkstoff Matière Material	Stand.- Packg.	Artikel-Nr. Numéro d'article Part-No.	
	-	8.0	10.5	8.5	45°	0.8	RF bl	1000	3841.80	*1
	-	8.0	10.5	8.5	45°	0.8	ST	1000	3841.9()	*1
	2.2	8.0	10.5	8.5	45°	0.8	MS	1000	3843.6()	
	3.2	8.0	10.5	8.5	45°	0.8	MS	1000	3847.6()	
	3.2	8.0	10.5	8.5	45°	0.8	MS	1000	3847E.6()	*2
	3.7	8.0	10.5	8.5	45°	0.8	MS	1000	3851.6()	
	3.7	8.0	10.5	8.5	45°	0.8	ST	1000	3851.9()	
	4.3	8.0	10.5	8.5	30°	0.8	MS	1000	3855.6()	
	4.3	8.0	10.5	8.5	45°	0.8	MS	1000	3856.6()	
	4.3	8.0	10.5	8.5	45°	0.8	ST	1000	3856.9()	
	4.3	8.0	10.5	8.5	45°	0.8	ST	1000	3856E.9()	*2
	5.3	8.0	10.5	8.5	30°	0.8	MS	1000	3860.6()	
	5.3	8.0	10.5	8.5	45°	0.8	MS	1000	3861.6()	
	6.3	8.0	10.5	8.5	45°	0.8	MS	1000	3864B.6()	
	-	8.0	10.5	8.5	90°	0.8	RF bl	1000	3842.80	*1
	2.7	8.0	10.5	8.5	90°	0.8	MS	1000	3845.6()	
	3.2	8.0	9.2	8.2	90°	0.8	MS	1000	38481.6()	
	3.2	8.0	10.5	8.5	90°	0.8	MS	1000	3848.6()	
	3.2	7.8	13.7	8.5	90°	0.8	MS	1000	3846A.6()	
	3.7	8.0	10.5	8.5	90°	0.8	MS	1000	3853.6()	
	3.7	8.0	10.5	8.5	90°	0.8	ST	1000	3853.9()	
	3.7	8.0	10.5	8.0	90°	0.8	BZ	1000	38531.2()	
	4.2	8.0	10.5	8.0	90°	0.8	BZ	1000	38581.2()	
	4.3	8.0	10.5	8.5	90°	0.8	MS	1000	3858.6()	
	5.3	8.0	10.5	8.5	90°	0.8	MS	1000	3863.6()	
	5.3	8.0	10.5	8.5	90°	0.8	RF bl	1000	3863.80	
	6.3	8.0	10.5	8.5	90°	0.8	MS	1000	3864C.6()	
		-	8.0	10.0	10.5	45°	0.8	RF bl	500	3870A.80
3.2		8.0	10.0	10.5	45°	0.8	MS	500	3871A.6()	
3.7		8.0	10.0	10.5	45°	0.8	MS	500	3873A.6()	
4.2		8.0	8.0	11.0	45°	0.8	MS	500	38750A.6()	
4.2		10.0	10.0	12.0	45°	0.8	MS	500	3875A.6()	
4.2		10.0	10.0	12.0	45°	0.8	ST	500	3875A.9()	
5.2		10.0	10.0	12.0	45°	0.8	MS	500	3878A.6()	
6.2		10.0	10.0	12.0	45°	0.8	MS	500	3879A.6()	
	-	8.0	9.7	10.5	90°	0.8	RF bl	500	3870C.80	*1
	-	8.0	9.7	10.5	90°	0.8	ST	500	3870C.9()	*1
	2.7	8.8	10.0	7.0	90°	0.8	CU	500	38732.4()	
	2.7	8.8	10.0	7.0	90°	0.8	MS	500	38712C.6()	
	3.1	8.8	10.0	7.0	90°	0.8	BZ	500	38711C.2()	
	3.2	8.0	9.7	10.5	90°	0.8	MS	500	3871C.6()	
	3.7	8.0	10.0	10.5	90°	0.8	MS	500	3873C.6()	
	3.7	8.0	10.0	10.5	90°	0.8	ST	500	3873C.9()	
	3.7	8.8	10.0	7.0	90°	0.8	BZ	500	38731.2()	
	3.7	8.8	10.0	7.0	90°	0.8	MS	500	38733.6()	
	4.2	8.0	10.7	11.0	90°	0.8	MS	500	3876C.6()	
	4.2	8.8	10.4	7.0	90°	0.8	MS	500	3877C.6()	
	4.5	9.2	14.2	7.5	90°	0.8	MS	500	38760C.6()	
	6.3	10.0	10.0	12.0	90°	0.8	MS	500	3879C.6()	

*1 Ohne Bohrung / Sans trou / Without hole

*2 Mit Erdungszeichen / Avec symbole de prise de terre / With earth sign

Andere Winkel machbar auf Anfrage

D'autres angles faisables sur demande

Further angles possible on request



Steckzungen für Schweissanschluss

Masse im Steckbereich
 DIN 46342 Teil 1

Werkstoff:

BZ = Bronze
 MS = Messing
 NS = Neusilber
 RF = rostfreier Stahl
 ST = Stahl

Oberflächenbehandlung: Code
 bl = blank (0)
 ag = versilbert (1)
 au = vergoldet (2)
 ni = vernickelt (5)
 sn = reinverzinkt (7)

Bestellbeispiel
Exemple de commande:
Example of order:

38401SB.95
 (3840/1SB ST ni)

Languettes pour soudage par points

Dimensions zone d'emboîtement selon
 DIN 46342 partie 1

Matière:

BZ = bronze
 MS = laiton
 NS = maillechort
 RF = acier inox
 ST = acier

Traitements de surface: Code
 bl = brut (0)
 ag = argenté (1)
 au = doré (2)
 ni = nickelé (5)
 sn = étamage pur (7)

Tabs for spot welding

Dimensions in the tab sector
 DIN 46342 part 1

Material:

BZ = bronze
 MS = brass
 NS = german silver
 RF = stainless steel
 ST = steel

Surface-plating: Code
 bl = clean (0)
 ag = silver-plated (1)
 au = gold-plated (2)
 ni = nickel-plated (5)
 sn = pure tin-plated (7)

6,3 mm

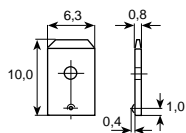

Artikel-Nr. → **3868R.2 () BZ**
 Numéro d'article Part-No.

6.3x0.8
 1000

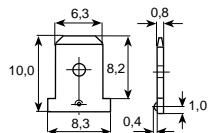

3868M.2 () BZ

6.3x0.8
 1000

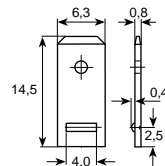

3840 1SB.9 () ST

6.3x0.8
 2000

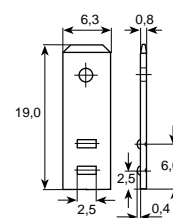

3840B 2SB.95 ST ni

6.3x0.8
 1000

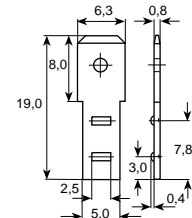

3840C 2SB.95 ST ni

6.3x0.8
 1000

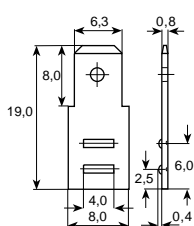

Artikel-Nr. → **3840 2SBS.80 RF bl**
 Numéro d'article Part-No. → **3840 2SB.9 () ST**

6.3x0.8
 1000

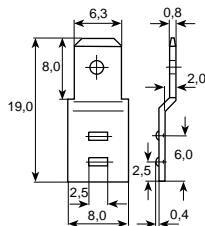

3840A 2SBA.9 () ST

6.3x0.8
 1000

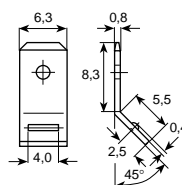

3841 1SBI.80 RF bl
3841 1SBI.9 () ST

6.3x0.8
 2000

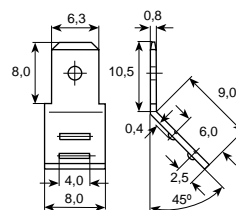

3841 2SBA.9 () ST

6.3x0.8
 1000

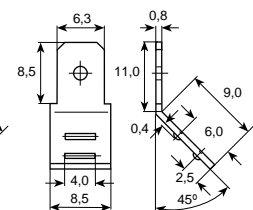

3841 2SBS.80 RF bl

6.3x0.8
 1000



Vogt Verbindungstechnik

<h2 style="margin: 0;">6,3 mm</h2>	<h3>Steckzungen für Schweissanschluss</h3> <p>Masse im Steckbereich DIN 46342 Teil 1</p>	<h3>Languettes pour soudage par points</h3> <p>Dimensions zone d'emboîtement selon DIN 46342 partie 1</p>	<h3>Tabs for spot welding</h3> <p>Dimensions in the tab sector DIN 46342 part 1</p>
--	--	---	---

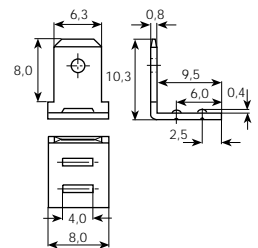
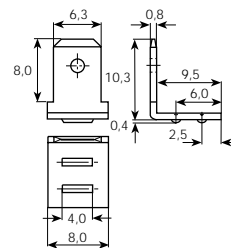
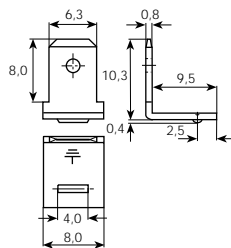
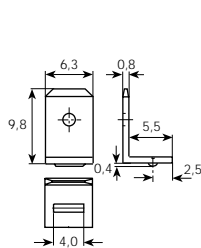

Artikel-Nr. Numéro d'article Part-No. →	3840 1SB90.9() ST 6.3x0.8 2000	3842 1SBAE.80 RF bl *1 3842 1SBAE.9() ST *1 6.3x0.8 1000	3842 2SBA.9() ST 6.3x0.8 1000
Stand.-Packg.			

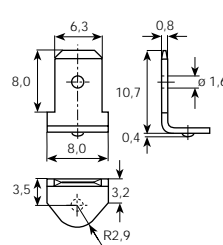
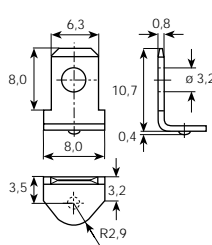
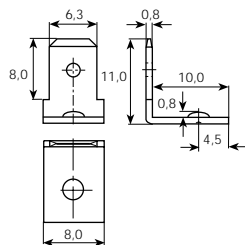

Artikel-Nr. Numéro d'article Part-No. →	3841 1SBK.80 RF bl 6.3x0.8 2000	3846T.7() NS 6.3x0.8 1000	3868Z.7() NS 6.3x0.8 2000
Stand.-Packg.			

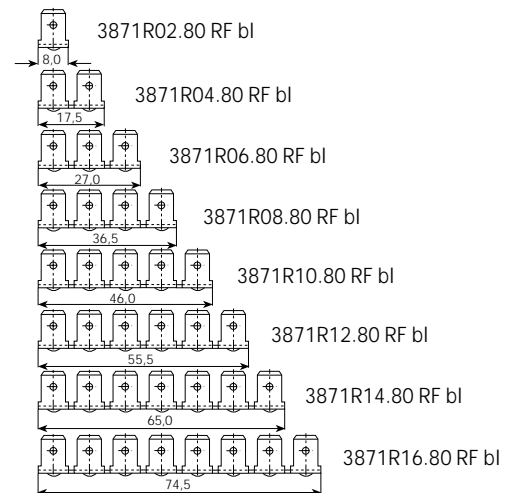
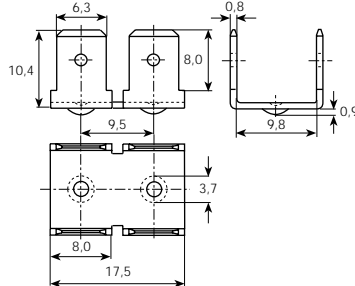
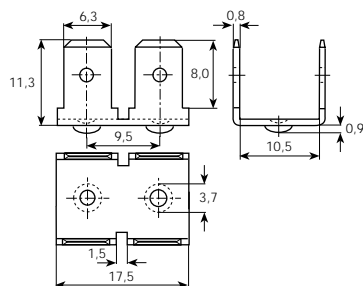

Artikel-Nr. Numéro d'article Part-No. →	3871L.80 RF bl 6.3x0.8 500	3871R04.80 RF bl 6.3x0.8 500	
Stand.-Packg.			

*1 Mit Erdungszeichen / Avec symbole de prise de terre / With earth sign

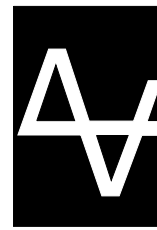

Vogt Verbindungstechnik

**6,3
mm**

Steckzungen

Masse im Steckbereich
DIN 46342 Teil 1

Languettes

Dimensions zone d'emboîtement selon
DIN 46342 partie 1

Tabs

Dimensions in the tab sector
DIN 46342 part 1

Werkstoff:

- BZ = Bronze
- MS = Messing
- NS = Neusilber
- RF = rostfreier Stahl
- ST = Stahl

Matière:

- BZ = bronze
- MS = laiton
- NS = maillechort
- RF = acier inox
- ST = acier

Material:

- BZ = bronze
- MS = brass
- NS = german silver
- RF = stainless steel
- ST = steel

Oberflächenbehandlung:

- bl = blank (0)
- ag = versilbert (1)
- au = vergoldet (2)
- ni = vernickelt (5)
- sn = reinverzinkt (7)

Traitements de surface:

- bl = brut (0)
- ag = argenté (1)
- au = doré (2)
- ni = nickelé (5)
- sn = étamage pur (7)

Surface-plating:

- bl = clean (0)
- ag = silver-plated (1)
- au = gold-plated (2)
- ni = nickel-plated (5)
- sn = pure tin-plated (7)

Bestellbeispiel

Exemple de commande:
Example of order:

3869G.60
(3869G MS bl)

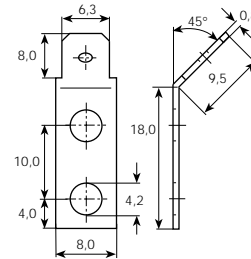
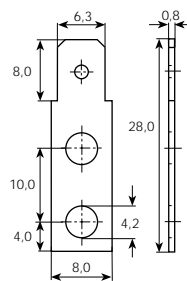
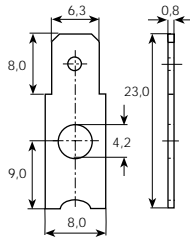
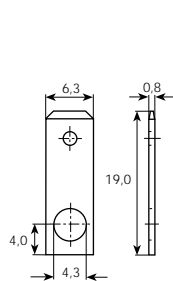

Artikel-Nr. → 3869G.6() MS
Numéro d'article
Part-No.

6.3x0.8
1000

38693.6() MS

6.3x0.8
1000

3869.6() MS

6.3x0.8
1000

386945.6() MS

6.3x0.8
1000

Stand.-Packg.

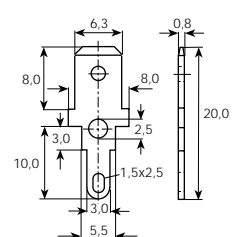
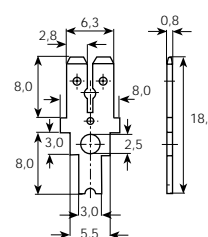
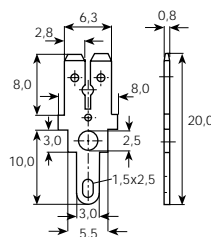
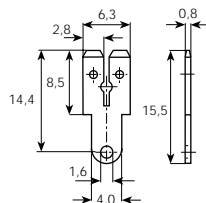
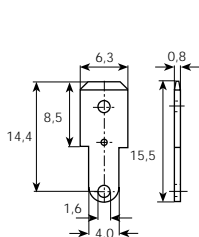

Artikel-Nr. → 3868K.6() MS
Numéro d'article
Part-No.

6.3x0.8
1000

3868S.6() MS

6.3x0.8 / 2.8x0.8
1000

3868U.6() MS

6.3x0.8 / 2.8x0.8
1000

3868W.6() MS

6.3x0.8 / 2.8x0.8
1000

3868X.6() MS

6.3x0.8
1000

Stand.-Packg.



Vogt Verbindungstechnik

Steckungen

Masse im Steckbereich
DIN 46342 Teil 1

Languettes

Dimensions zone d'emboîtement selon
DIN 46342 partie 1

Tabs

Dimensions in the tab sector
DIN 46342 part 1

**6,3
mm**

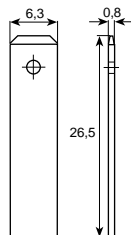

Artikel-Nr.
Numéro d'article
Part-No. → **3869A.6() MS**

6.3x0.8
1000

Stand.-Packg.

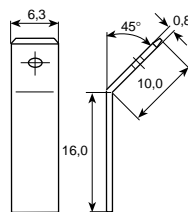

Artikel-Nr.
Numéro d'article
Part-No. → **3869A45.9() ST**

6.3x0.8
1000

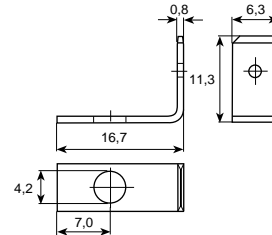

Artikel-Nr.
Numéro d'article
Part-No. → **3869A90.6() MS**

6.3x0.8
1000

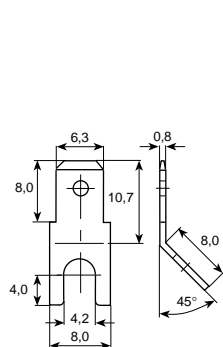

Artikel-Nr.
Numéro d'article
Part-No. → **3868F45.6() MS**

6.3x0.8
1000

Stand.-Packg.

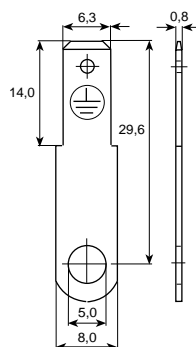

Artikel-Nr.
Numéro d'article
Part-No. → **3869V.6() MS**

6.3x0.8
500

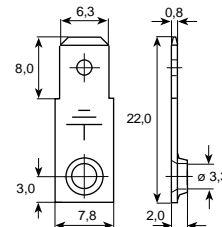

Artikel-Nr.
Numéro d'article
Part-No. → **38462.6() MS**

6.3x0.8
1000

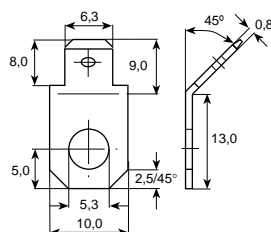

Artikel-Nr.
Numéro d'article
Part-No. → **3869S.6() MS**

6.3x0.8
1000

Stand.-Packg.

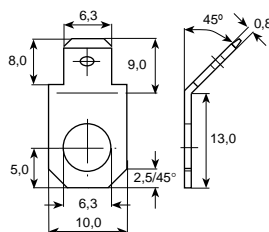

Artikel-Nr.
Numéro d'article
Part-No. → **3869X.6() MS**

3869X.9() ST
6.3x0.8
1000

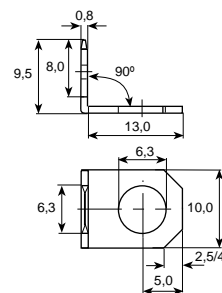

Artikel-Nr.
Numéro d'article
Part-No. → **3869X90.6() MS**

3869X90.9() ST
6.3x0.8
1000

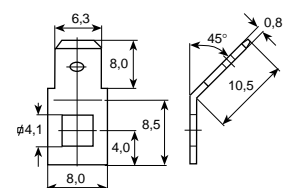

Artikel-Nr.
Numéro d'article
Part-No. → **3856P.6() MS**

6.3x0.8
1000

*1 Mit Erdungszeichen / Avec symbole de prise de terre / With earth sign



Steckzungen

Masse im Steckbereich
 DIN 46342 Teil 1

Languettes

Dimensions zone d'emboîtement selon
 DIN 46342 partie 1

Tabs

Dimensions in the tab sector
 DIN 46342 part 1

Werkstoff:

BZ = Bronze
 MS = Messing
 NS = Neusilber
 RF = rostfreier Stahl
 ST = Stahl

Matière:

BZ = bronze
 MS = laiton
 NS = maillechort
 RF = acier inox
 ST = acier

Material:

BZ = bronze
 MS = brass
 NS = german silver
 RF = stainless steel
 ST = steel

Oberflächenbehandlung: Code

bl = blank (0)
 ag = versilbert (1)
 au = vergoldet (2)
 ni = vernickelt (5)
 sn = reinverzinkt (7)

Traitements de surface: Code

bl = brut (0)
 ag = argenté (1)
 au = doré (2)
 ni = nickelé (5)
 sn = étamage pur (7)

Surface-plating: Code

bl = clean (0)
 ag = silver-plated (1)
 au = gold-plated (2)
 ni = nickel-plated (5)
 sn = pure tin-plated (7)

Bestellbeispiel
Exemple de commande:
Example of order:

3869M.67
 (3869M MS sn)

6,3 mm

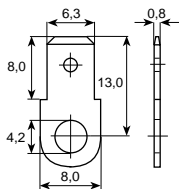

Artikel-Nr. → **3869M.6() MS**

Numéro d'article
 Part-No.

6.3x0.8
 1000

Stand.-Packg.

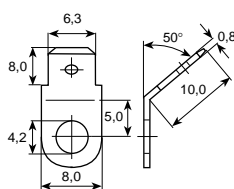

Artikel-Nr. → **3869M50.2() BZ**

6.3x0.8
 1000

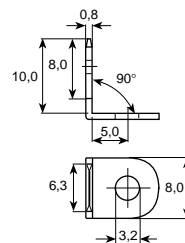

Artikel-Nr. → **3869L90.6() MS**

6.3x0.8
 1000

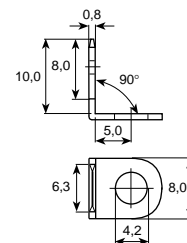

Artikel-Nr. → **3869M90.6() MS**

6.3x0.8
 1000

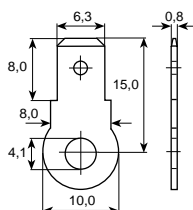

Artikel-Nr. → **3869P.6() MS**

Numéro d'article
 Part-No.

6.3x0.8
 1000

Stand.-Packg.

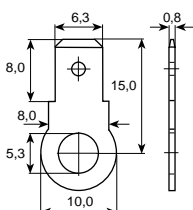

Artikel-Nr. → **3869K.6() MS**

6.3x0.8
 1000

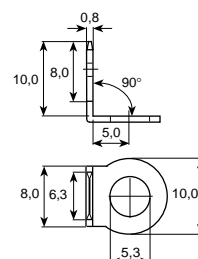

Artikel-Nr. → **3869P90.6() MS**

6.3x0.8
 1000

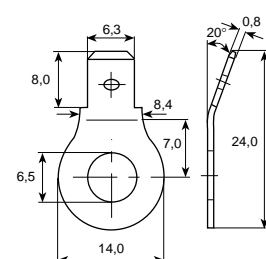

Artikel-Nr. → **3870G20.80 RF bl**

6.3x0.8
 2000



Vogt Verbindungstechnik

Steckungen

Masse im Steckbereich
 DIN 46342 Teil 1

Languettes

Dimensions zone d'emboîtement selon
 DIN 46342 partie 1

Tabs

Dimensions in the tab sector
 DIN 46342 part 1

**6,3
 mm**

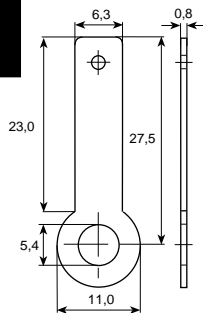

Artikel-Nr. → **3869W.9() ST**

Numéro d'article
 Part-No. → **6.3x0.8
 500**

Stand.-Packg.

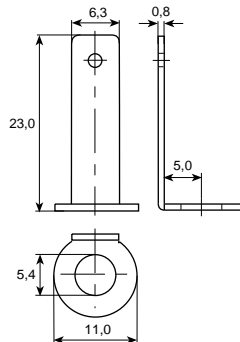

Artikel-Nr. → **3869H.9() ST**

Numéro d'article
 Part-No. → **6.3x0.8
 500**

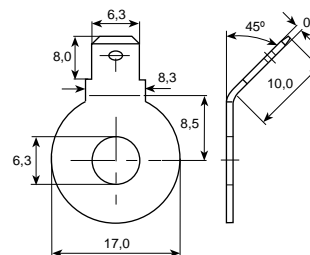

Artikel-Nr. → **3869Q45.6() MS**

Numéro d'article
 Part-No. → **6.3x0.8
 500**

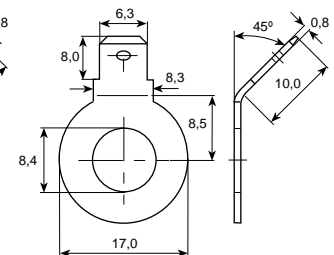

Artikel-Nr. → **3869N45.6() MS**

Numéro d'article
 Part-No. → **6.3x0.8
 500**

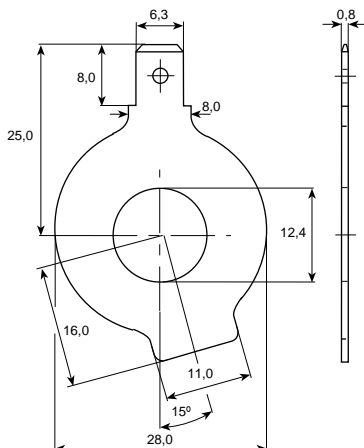

Artikel-Nr. → **3869F.6() MS**

Numéro d'article
 Part-No. → **6.3x0.8
 500**

Stand.-Packg.

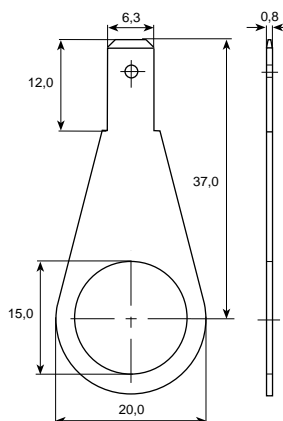

Artikel-Nr. → **3869Y.6() MS**

Numéro d'article
 Part-No. → **6.3x0.8
 500**

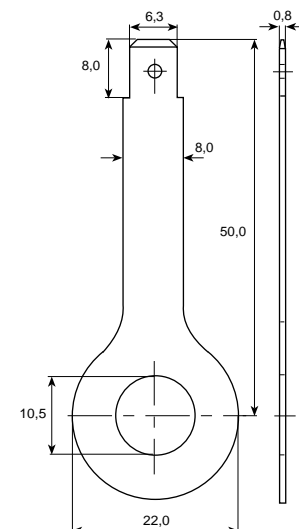

Artikel-Nr. → **3869T.6() MS**

Numéro d'article
 Part-No. → **6.3x0.8
 200**

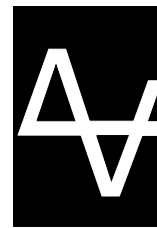

Vogt Verbindungstechnik

Steckzungen

Masse im Steckbereich
 DIN 46342 Teil 1

Languettes

Dimensions zone d'emboîtement selon
 DIN 46342 partie 1

Tabs

Dimensions in the tab sector
 DIN 46342 part 1

Werkstoff:

CU = Kupfer
 MS = Messing
 NS = Neusilber
 RF = rostfreier Stahl
 ST = Stahl

Matière:

CU = cuivre
 MS = laiton
 NS = maillechort
 RF = acier inox
 ST = acier

Material:

CU = copper
 MS = brass
 NS = german silver
 RF = stainless steel
 ST = steel

Oberflächenbehandlung: Code
 bl = blank (0)
 ag = versilbert (1)
 au = vergoldet (2)
 ni = vernickelt (5)
 sn = reinverzinkt (7)

Traitements de surface: Code
 bl = brut (0)
 ag = argenté (1)
 au = doré (2)
 ni = nickelé (5)
 sn = étamage pur (7)

Surface-plating: Code
 bl = clean (0)
 ag = silver-plated (1)
 au = gold-plated (2)
 ni = nickel-plated (5)
 sn = pure tin-plated (7)

Bestellbeispiel
Exemple de commande:
Example of order:

38692.70
 (3869/2 NS bl)

6,3
mm

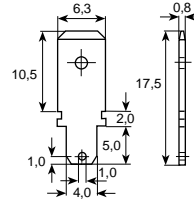
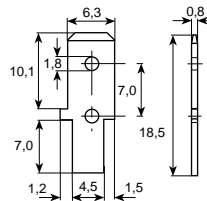
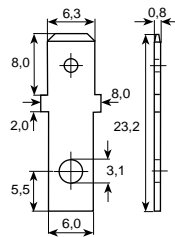
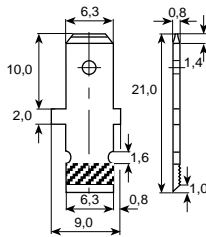

Artikel-Nr. → **38692.6 () MS**
 Numéro d'article **38692.7 () NS**
 Part-No.
 6.3x0.8
 Stand.-Packg. 1000

3869E.67 MS sn
 6.3x0.8
 1000

3865H.6 () MS
 6.3x0.8
 1000

3865G.6 () MS
 6.3x0.8
 1000

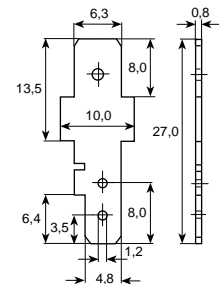
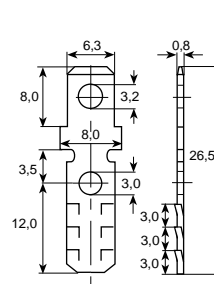
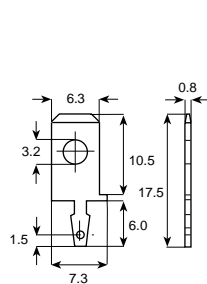
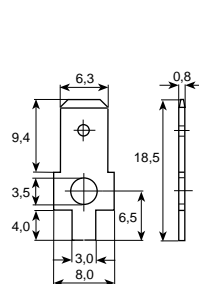
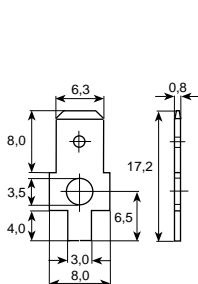

Artikel-Nr. → **3865A.6 () MS**
 Numéro d'article
 Part-No. 6.3x0.8
 Stand.-Packg. 1000

3865C.6 () MS
 6.3x0.8
 1000

3866D.6 () MS
 6.3x0.8
 1000

3869B.6 () MS
 6.3x0.8
 1000

3839D.6 () MS
 siehe Seite 317
 voir page 317
 see page 317



Vogt Verbindungstechnik

Steckungen

Masse im Steckbereich
 DIN 46342 Teil 1

Languettes

Dimensions zone d'emboîtement selon
 DIN 46342 partie 1

Tabs

Dimensions in the tab sector
 DIN 46342 part 1

**6,3
 mm**

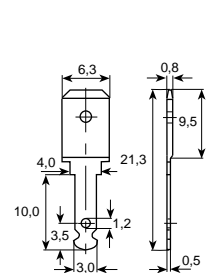
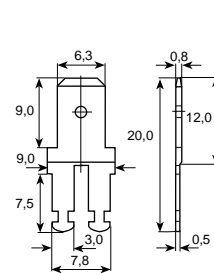
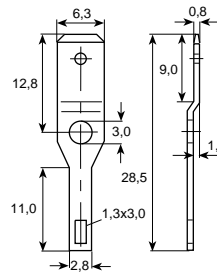
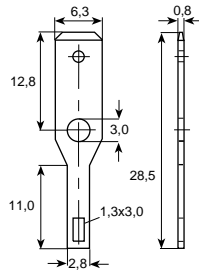
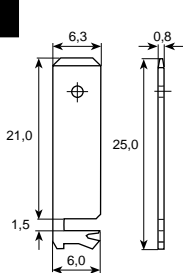

Artikel-Nr. Numéro d'article Part-No.	→ 3865B.6() MS	3868V.9() ST	3868C.9) ST	3865D.67 MS sn	3865E.67 MS sn
Stand.-Packg.	6.3x0.8 1000	6.3x0.8 / 2.8x0.8 1000	6.3x0.8 / 2.8x0.8 1000	6.3x0.8 1000	6.3x0.8 1000

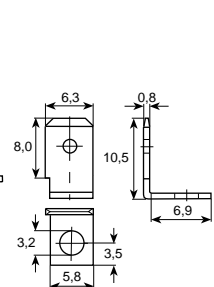
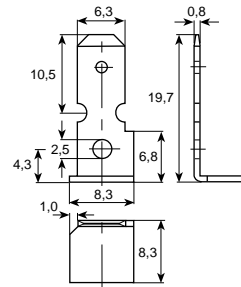
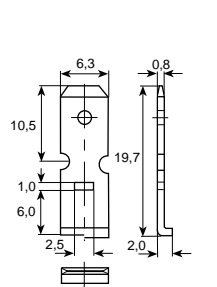
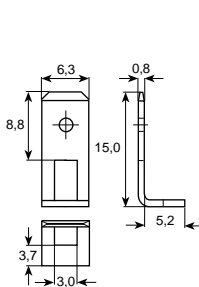
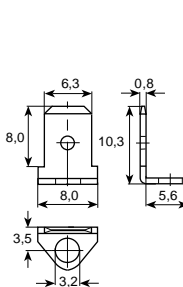

Artikel-Nr. Numéro d'article Part-No.	→ 3868H.7() NS	3869Z.6() MS	3868G.4() CU	3868E.4() CU	3846K.6() MS
Stand.-Packg.	6.3x0.8 2000	6.3x0.8 1000	6.3x0.8 1000	6.3x0.8 1000	6.3x0.8 1000

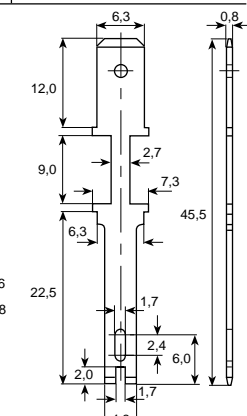
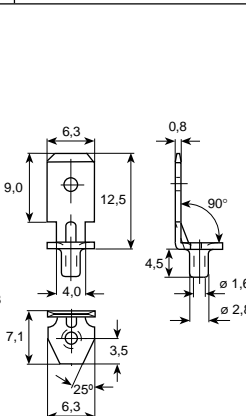
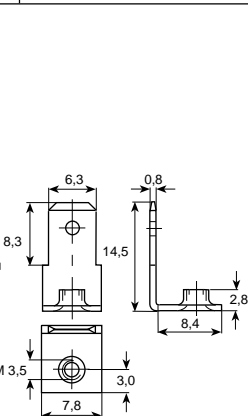
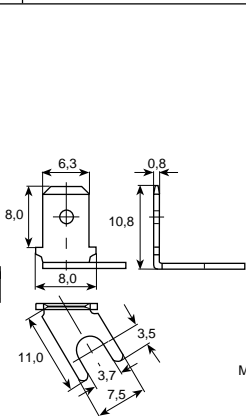
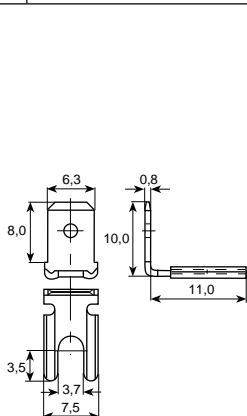

Artikel-Nr. Numéro d'article Part-No.	→ 3868D.6() MS	3868N.6() MS	3846J.6() MS	3846E.6() MS	3875M.6() MS
Stand.-Packg.	6.3x0.8 1000	6.3x0.8 1000	6.3x0.8 1000	6.3x0.8 1000	6.3x0.8 / 4.8x0.8 500



Steckzungen

Masse im Steckbereich
 DIN 46342 Teil 1

Languettes

Dimensions zone d'emboîtement selon
 DIN 46342 partie 1

Tabs

Dimensions in the tab sector
 DIN 46342 part 1

Werkstoff:

BZ = Bronze
 MS = Messing
 NS = Neusilber
 RF = rostfreier Stahl
 ST = Stahl

Matière:

BZ = bronze
 MS = laiton
 NS = maillechort
 RF = acier inox
 ST = acier

Material:

BZ = bronze
 MS = brass
 NS = german silver
 RF = stainless steel
 ST = steel

Oberflächenbehandlung: Code
 bl = blank (0)
 ag = versilbert (1)
 au = vergoldet (2)
 ni = vernickelt (5)
 sn = reinverzinnt (7)

Traitements de surface: Code
 bl = brut (0)
 ag = argenté (1)
 au = doré (2)
 ni = nickelé (5)
 sn = étamage pur (7)

Surface-plating: Code
 bl = clean (0)
 ag = silver-plated (1)
 au = gold-plated (2)
 ni = nickel-plated (5)
 sn = pure tin-plated (7)

Bestellbeispiel
Exemple de commande:
Example of order:

38541.65
 (3854/1 MS ni)

6,3 mm

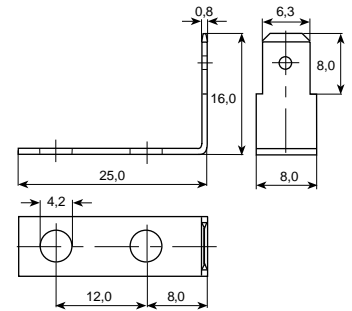
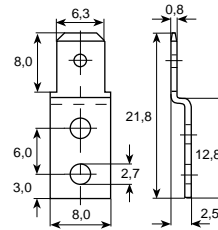
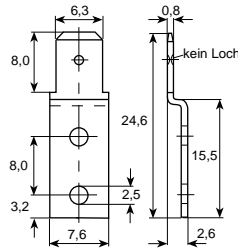
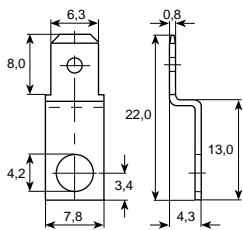

Artikel-Nr. → **38541.6() MS**
 Numéro d'article
 Part-No.
 6.3x0.8
 Stand.-Packg. 1000

38543.6() MS
 6.3x0.8
 1000

3854R.6() MS
 6.3x0.8
 1000

3846W.6() MS
 6.3x0.8
 1000

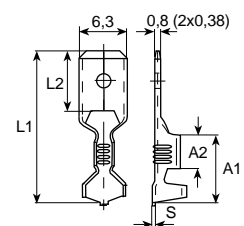
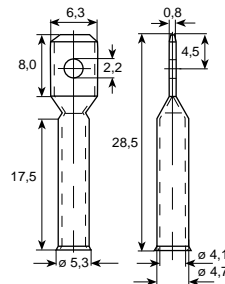
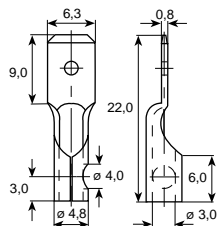
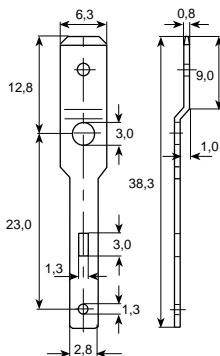

Artikel-Nr. → **38683.9() ST**
 Numéro d'article
 Part-No.
 6.3x0.8/ 2.8x0.8
 Stand.-Packg. 1000

3868B.6() MS
 6.3x0.8
 500

1290.6() MS
 siehe Seite 169
 voir page 169
 see page 169

3836A.6() MS
 siehe Seite 356
 voir page 356
 see page 356



Vogt Verbindungstechnik

Steckzungen

Masse im Steckbereich
DIN 46342 Teil 1

Languettes

Dimensions zone d'emboîtement selon
DIN 46342 partie 1

Tabs

Dimensions in the tab sector
DIN 46342 part 1

**6,3
mm**

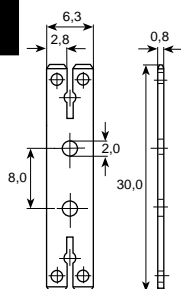

→ **3875H.6() MS**

6.3x0.8 / 2.8x0.8
1000

Artikel-Nr.
Numéro d'article
Part-No.

Stand.-Packg.

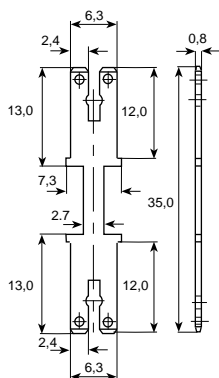

→ **3875P.6() MS**

6.3x0.8 / 2.8x0.8
500

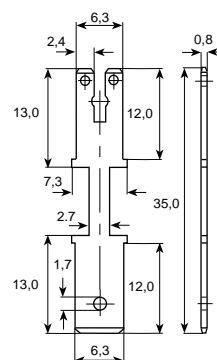

→ **3875L.6() MS**

6.3x0.8 / 2.8x0.8
500

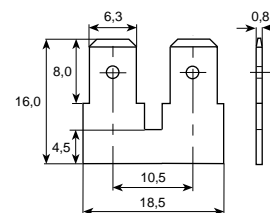

→ **3869R.6() MS**
3869R.9() ST

6.3x0.8
500

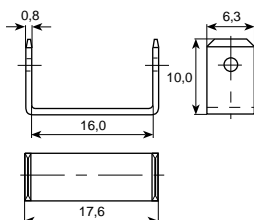

→ **3870L.95 ST ni**

6.3x0.8
500

Artikel-Nr.
Numéro d'article
Part-No.

Stand.-Packg.

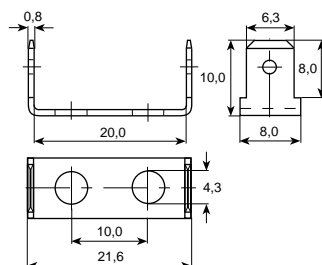

→ **3876L.95 ST ni**

6.3x0.8
500

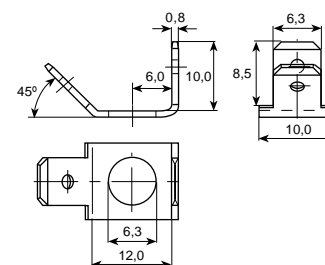

→ **3879F.6() MS**

6.3x0.8
1000

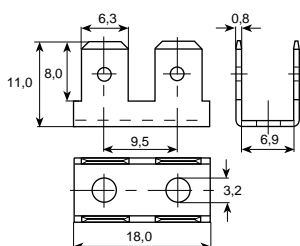

→ **3871H.95 ST ni**

6.3x0.8
200

Artikel-Nr.
Numéro d'article
Part-No.

Stand.-Packg.

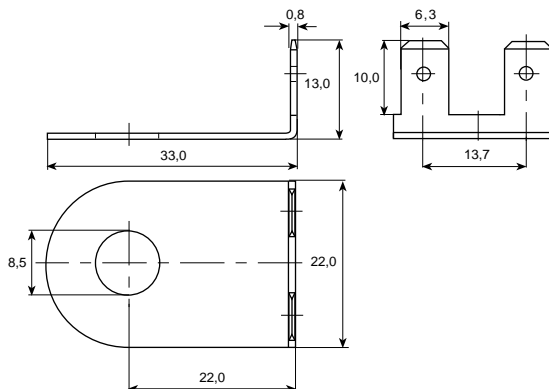

→ **3871D.6() MS**

6.3x0.8
200

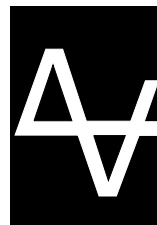

Vogt Verbindungstechnik

Steckzungen

Masse im Steckbereich
 DIN 46342 Teil 1

Languettes

Dimensions zone d'emboîtement selon
 DIN 46342 partie 1

Tabs

Dimensions in the tab sector
 DIN 46342 part 1

Werkstoff:

BZ = Bronze
 MS = Messing
 NS = Neusilber
 RF = rostfreier Stahl
 ST = Stahl

Matière:

BZ = bronze
 MS = laiton
 NS = maillechort
 RF = acier inox
 ST = acier

Material:

BZ = bronze
 MS = brass
 NS = german silver
 RF = stainless steel
 ST = steel

Oberflächenbehandlung: Code

bl = blank (0)
 ag = versilbert (1)
 au = vergoldet (2)
 ni = vernickelt (5)
 sn = reinverzinkt (7)

Traitements de surface: Code

bl = brut (0)
 ag = argenté (1)
 au = doré (2)
 ni = nickelé (5)
 sn = étamage pur (7)

Surface-plating: Code

bl = clean (0)
 ag = silver-plated (1)
 au = gold-plated (2)
 ni = nickel-plated (5)
 sn = pure tin-plated (7)

Bestellbeispiel
Exemple de commande:
Example of order:

3866K.60
 (3866K MS bl)

6,3
mm

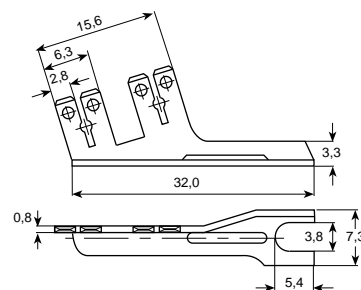
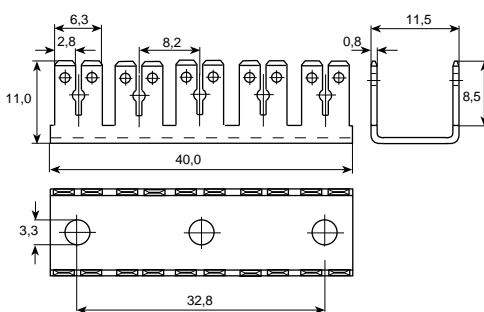
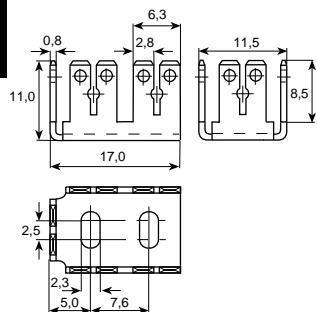

Artikel-Nr. → **3866K.6() MS**
 Numéro d'article
 Part-No.

6.3x0.8 / 2.8x0.8
 500

3876E.6() MS

6.3x0.8 / 2.8x0.8
 200

3867Z.6() MS

6.3x0.8 / 2.8x0.8
 200

Stand.-Packg.

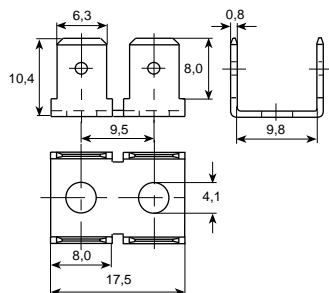

Artikel-Nr. → **3876R04.6() MS**
 Numéro d'article
 Part-No.

6.3x0.8
 200

Stand.-Packg.

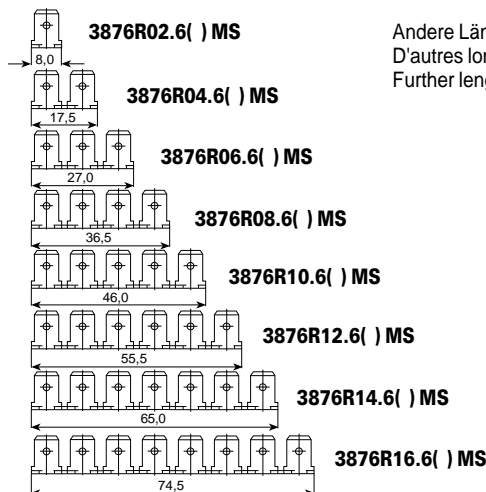

Andere Längen machbar auf Anfrage
 D'autres longueurs faisables sur demande
 Further lengths possible on request



Vogt Verbindungstechnik

Steckerleisten

Masse im Steckbereich
DIN 46342 Teil 1

Barrettes à languettes

Dimensions zone d'emboîtement selon
DIN 46342 partie 1

Tab blocks

Dimensions in the tab sector
DIN 46342 part 1

Werkstoff:
MS bl = Messing blank

Matière:
MS bl = laiton brut

Material:
MS bl = clean brass

Bestellbeispiel
Exemple de commande:
Example of order:

386162.60
(38616/2 MS bl)

**6,3
mm**

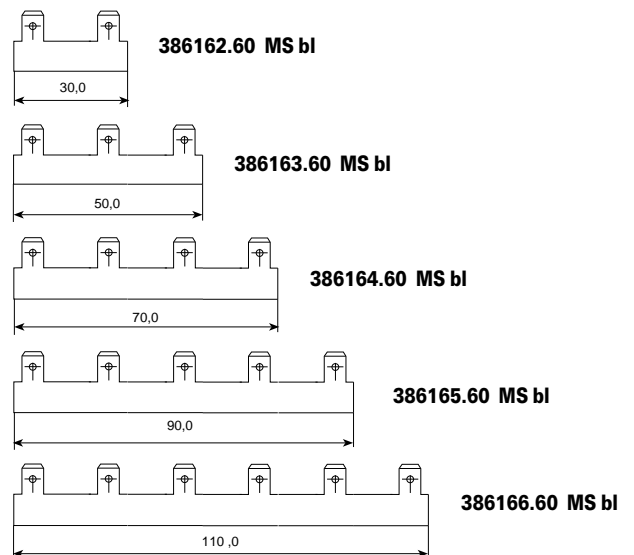
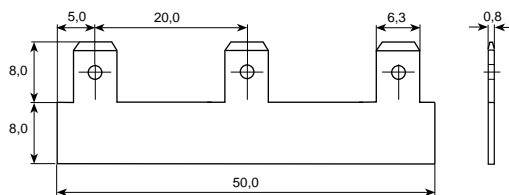

Andere Längen machbar auf Anfrage
D'autres longueurs faisables sur demande
Further lengths possible on request

Artikel-Nr. → **386163.60 MS bl**
Numéro d'article
Part-No.
6.3x0.8
Stand.-Packg. 20

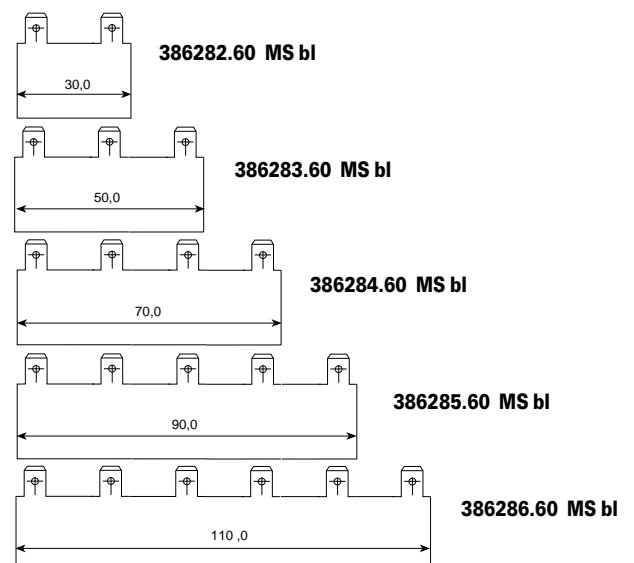
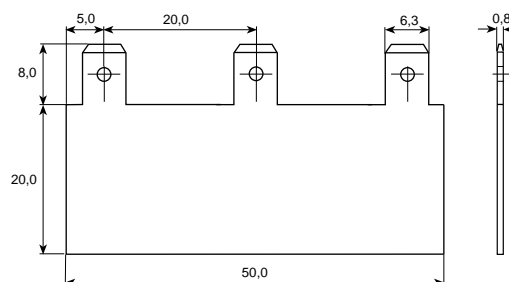

Andere Längen machbar auf Anfrage
D'autres longueurs faisables sur demande
Further lengths possible on request

Artikel-Nr. → **386283.60 MS bl**
Numéro d'article
Part-No.
6.3x0.8
Stand.-Packg. 20



Vogt Verbindungstechnik

Steckverteiler

Masse im Steckbereich
 DIN 46342 Teil 1

Raccords mixtes

Dimensions zone d'emboîtement selon
 DIN 46342 partie 1

Multi-connectors

Dimensions in the tab sector
 DIN 46342 part 1

**6,3
 mm**

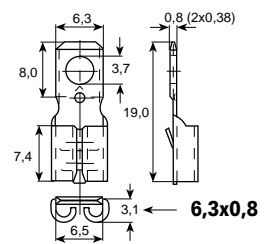
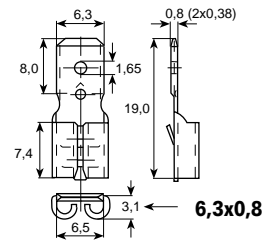
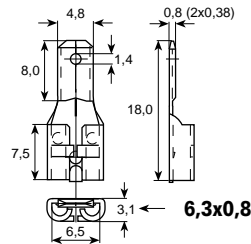
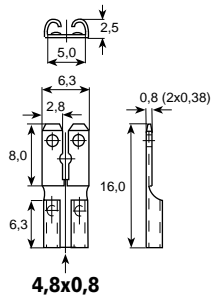

Artikel-Nr. Numéro d'article Part-No.	→ 3829C.67 MS sn	3829G.6 () MS siehe Seite 318 voir page 318 see page 318	3839E.6 () MS 6.3x0.8 / 6.3x0.8 500	3839G.6 () MS 6.3x0.8 / 6.3x0.8 500
Stand.-Packg.	4.8x0.8 / 6.3x0.8 1000			

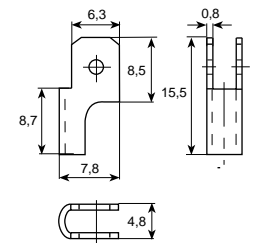
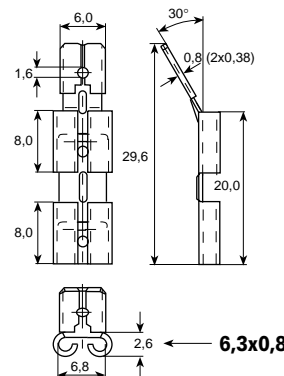
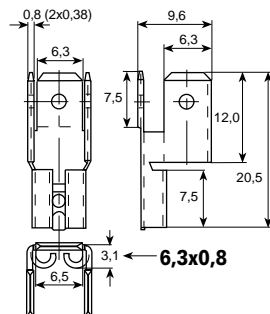
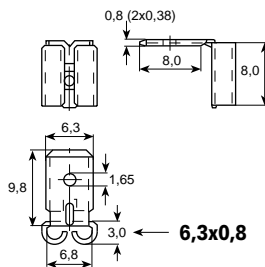

Artikel-Nr. Numéro d'article Part-No.	→ 3839F.6 () MS	3838E.6 () MS 6.3x0.8 / 6.3x0.8 500	3838D.6 () MS 6.3x0.8 / 6.3x0.8 500	3839.80 RF bl 6.3x0.8 / 6.3x0.8 500
Stand.-Packg.	6.3x0.8 / 6.3x0.8 500			

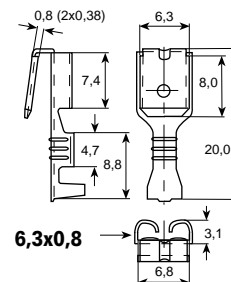
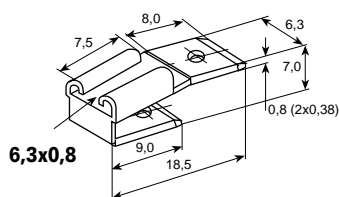

Artikel-Nr. Numéro d'article Part-No.	→ 3838.27 BZ sn 3838.6 () MS	0.5 - 1.5 mm² 1.5 - 2.5 mm² siehe Seite 360 voir page 360 see page 360	3838A.6 () MS 3838B.6 () MS
Stand.-Packg.	6.3x0.8 / 6.3x0.8 500		