



# Vogt Verbindungstechnik

## Steckzungen

Masse im Steckbereich  
 DIN 46342 Teil 1

## Languettes

Dimensions zone d'emboîtement selon  
 DIN 46342 partie 1

## Tabs

Dimensions in the tab sector  
 DIN 46342 part 1

Werkstoff:

BZ = Bronze  
 MS = Messing  
 NS = Neusilber  
 ST = Stahl

Matière:

BZ = bronze  
 MS = laiton  
 NS = maillechort  
 ST = acier

Material:

BZ = bronze  
 MS = brass  
 NS = german silver  
 ST = steel

Oberflächenbehandlung:

bl = blank (0)  
 ag = versilbert (1)  
 au = vergoldet (2)  
 ni = vernickelt (5)  
 sn = reinverzinkt (7)

Traitements de surface:

bl = brut (0)  
 ag = argenté (1)  
 au = doré (2)  
 ni = nickelé (5)  
 sn = étamage pur (7)

Surface-plating:

bl = clean (0)  
 ag = silver-plated (1)  
 au = gold-plated (2)  
 ni = nickel-plated (5)  
 sn = pure tin-plated (7)

**Bestellbeispiel**  
**Exemple de commande:**  
**Example of order:**

**3810.67**  
 (3810 MS sn)

**4,8**  
**mm**

	øD mm	B mm	L mm	S mm	Werkstoff Matière Material	Stand- Packg.	Artikel-Nr. Numéro d'article Part-No.
	<b>2.8</b>	6.5	17.5	0.8	MS	1000	<b>3810.6( )</b>
	<b>3.2</b>	6.5	17.5	0.5	MS	1000	<b>381405.6( )</b>
	<b>3.2</b>	6.5	17.5	0.8	MS	1000	<b>381408.6( )</b>
	<b>3.7</b>	6.5	17.5	0.8	MS	1000	<b>3818.6( )</b>
	<b>4.3</b>	6.5	17.5	0.8	MS	1000	<b>3822.6( )</b>
	<b>5.3</b>	6.5	17.5	0.8	MS	1000	<b>3810H.6( )</b>
	<b>2.8</b>	6.5	23.0	0.8	MS	1000	<b>3811D.6( )</b>
	<b>2.8</b>	6.5	28.0	0.8	MS	1000	<b>3813.6( )</b>
	<b>3.2</b>	6.5	23.0	0.8	MS	1000	<b>3814D.6( )</b>
	<b>3.2</b>	6.5	28.0	0.8	MS	1000	<b>3817.6( )</b>
	<b>3.2</b>	6.5	28.0	0.8	ST	1000	<b>3817.9( )</b>
	<b>3.7</b>	6.5	23.0	0.8	MS	1000	<b>3818D.6( )</b>
	<b>4.2</b>	6.5	23.0	0.8	MS	1000	<b>3821.6( )</b>
	<b>4.2</b>	6.5	28.0	0.8	MS	1000	<b>3821R.6( )</b>



# Vogt Verbindungstechnik

## Steckungen

Masse im Steckbereich  
 DIN 46342 Teil 1

## Languettes

Dimensions zone d'emboîtement selon  
 DIN 46342 partie 1

## Tabs

Dimensions in the tab sector  
 DIN 46342 part 1

**4,8  
 mm**

<b>45° + 90°</b>	$\phi D$ mm	B mm	L1 mm	L2 mm	W mm	S mm	Werkstoff Matière Material	Stand- Packg.	Artikel-Nr. Numéro d'article Part-No.
	<b>2.8</b>	6.5	10	7.5	45°	0.8	MS	1000	<b>3811.6( )</b>
	<b>3.2</b>	6.5	10	7.5	45°	0.8	MS	1000	<b>3815.6( )</b>
	<b>3.7</b>	6.5	10	7.5	45°	0.8	MS	1000	<b>3819.6( )</b>
	<b>4.3</b>	6.5	10	7.5	45°	0.8	MS	1000	<b>3823.6( )</b>
	<b>2.8</b>	6.5	10	7.5	90°	0.5	ST	1000	<b>381205.9( )</b>
	<b>2.8</b>	6.5	10	7.5	90°	0.8	MS	1000	<b>381208.6( )</b>
	<b>3.2</b>	6.5	10	7.5	90°	0.8	MS	1000	<b>3816.6( )</b>
	<b>3.7</b>	6.5	10	7.5	90°	0.8	MS	1000	<b>3820.6( )</b>
	<b>3.2</b>	6.5	9.5	8.5	45°	0.8	MS	1000	<b>381745.6( )</b>
	<b>3.7</b>	6.5	9.5	8.5	45°	0.8	MS	1000	<b>3821L4508.6( )</b>
	<b>4.2</b>	6.5	9.5	8.5	45°	0.5	MS	1000	<b>3821R4505.6( )</b>
	<b>4.2</b>	6.5	9.5	8.5	45°	0.8	MS	1000	<b>3821R4508.6( )</b>
	<b>3.2</b>	6.5	10	7.5	90°	0.8	MS	1000	<b>381790.6( )</b>
	<b>4.2</b>	6.5	10	7.5	90°	0.8	MS	1000	<b>3821R90.6( )</b>

Andere Winkel machbar auf Anfrage

D'autres angles faisables sur demande

Further angles possible on request



## Steckzungen

Masse im Steckbereich  
 DIN 46342 Teil 1

## Languettes

Dimensions zone d'emboîtement selon  
 DIN 46342 partie 1

## Tabs

Dimensions in the tab sector  
 DIN 46342 part 1

Werkstoff:

CU = Kupfer  
 MS = Messing  
 NS = Neusilber  
 RF = rostfreier Stahl  
 ST = Stahl

Matière:

CU = cuivre  
 MS = laiton  
 NS = maillechort  
 RF = acier inox  
 ST = acier

Material:

CU = copper  
 MS = brass  
 NS = german silver  
 RF = stainless steel  
 ST = steel

Oberflächenbehandlung: Code  
 bl = blank (0)  
 ag = versilbert (1)  
 au = vergoldet (2)  
 ni = vernickelt (5)  
 sn = reinverzinnt (7)

Traitements de surface: Code  
 bl = brut (0)  
 ag = argenté (1)  
 au = doré (2)  
 ni = nickelé (5)  
 sn = étamage pur (7)

Surface-plating: Code  
 bl = clean (0)  
 ag = silver-plated (1)  
 au = gold-plated (2)  
 ni = nickel-plated (5)  
 sn = pure tin-plated (7)

**Bestellbeispiel**  
**Exemple de commande:**  
**Example of order:**

**3828E.80**  
 (3828E RF bl)

# 4,8 mm

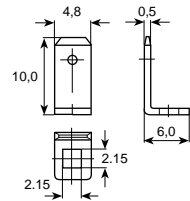
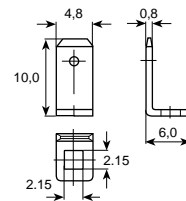
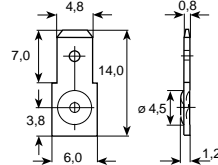
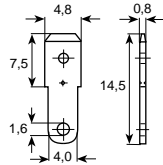
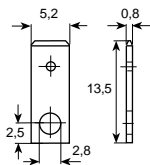

Artikel-Nr. → **3828.6 ( ) MS**  
 Numéro d'article  
 Part-No.  
 5.2x0.8  
 Stand.-Packg. 2000

**3828C.6 ( ) MS**  
 4.8x0.8  
 1000

**3828E.80 RF bl**  
 4.8x0.8  
 1000

**3810D.6 ( ) MS**  
 4.8x0.8  
 1000

**3810D05.6 ( ) MS**  
 4.8x0.5  
 1000

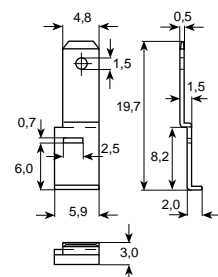
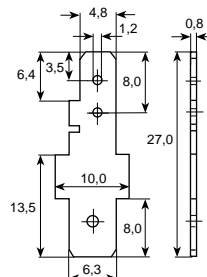
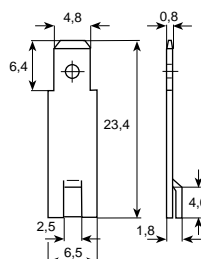
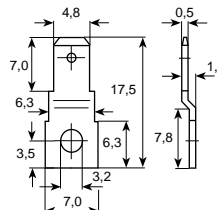
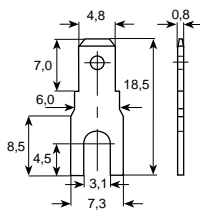

Artikel-Nr. → **3828Q.6 ( ) MS**  
 Numéro d'article  
 Part-No.  
 4.8x0.8  
 Stand.-Packg. 1000

**3828K.6 ( ) MS**  
**3828K.9 ( ) ST**  
 4.8x0.5  
 1000

**3828B.6 ( ) MS**  
 4.8x0.8  
 1000

**3839D.6 ( ) MS**  
 4.8x0.8 / 6.3x0.8  
 1000

**3828M.4 ( ) CU**  
 4.8x0.5  
 2000



# Vogt Verbindungstechnik

## Steckungen

Masse im Steckbereich  
 DIN 46342 Teil 1

## Languettes

Dimensions zone d'emboîtement selon  
 DIN 46342 partie 1

## Tabs

Dimensions in the tab sector  
 DIN 46342 part 1

**4,8  
 mm**

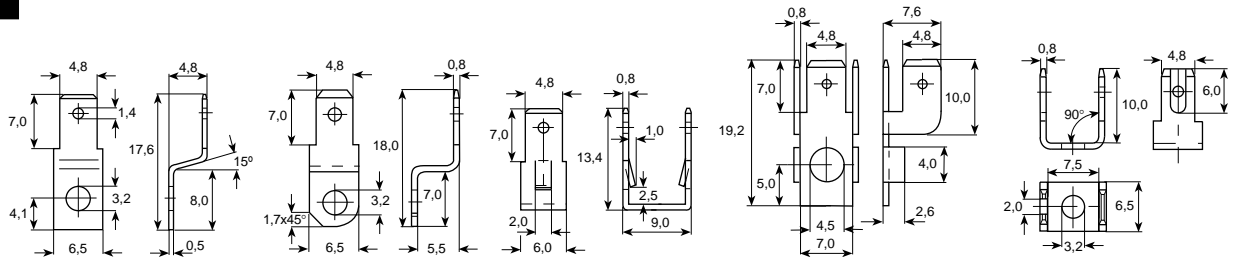

Artikel-Nr. Numéro d'article Part-No.	→ <b>3828R.6( ) MS</b>	<b>3828V.6( ) MS</b>	<b>3828F.6( ) MS</b>	<b>3829H.6( ) MS</b>	<b>3817E90.6( ) MS</b>
Stand.-Packg.	4.8x0.5 1000	4.8x0.8 1000	4.8x0.8 1000	4.8x0.8 500	4.8x0.8 1000

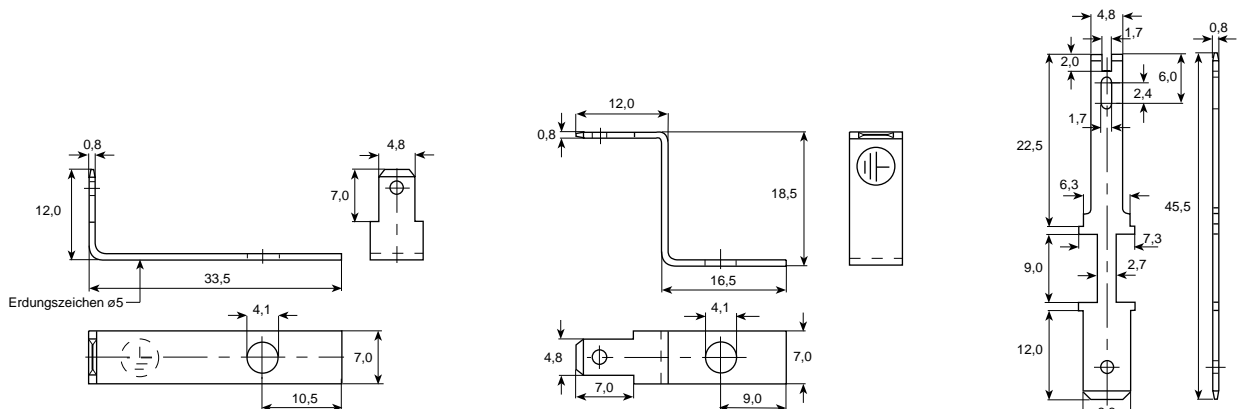

Artikel-Nr. Numéro d'article Part-No.	→ <b>3824F.6( ) MS</b>	<b>*1</b>	<b>3824E.6( ) MS</b>	<b>*1</b>	<b>3875M.6( ) MS</b>
Stand.-Packg.	4.8x0.8 1000		4.8x0.8 2000		siehe Seite 329 voir page 329 see page 329

## Steckverteiler

Masse im Steckbereich  
 DIN 46342 Teil 1

## Raccords mixtes

Dimensions zone d'emboîtement selon  
 DIN 46342 partie 1

## Multi-connectors

Dimensions in the tab sector  
 DIN 46342 part 1

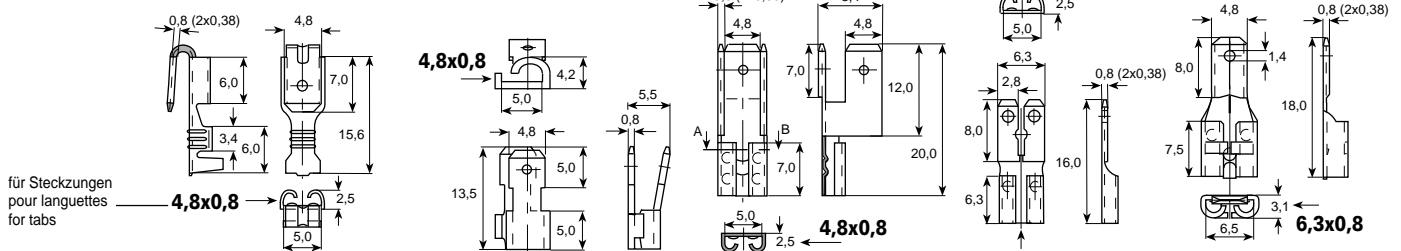

Artikel-Nr. Numéro d'article Part-No.	→ <b>0.5 - 1.0 mm<sup>2</sup></b>	<b>3829A.6( ) MS</b>	<b>3829.6( ) MS</b>	<b>3829E.6( ) MS</b>	<b>3829C.67 MS sn</b>	<b>3829G.6( ) MS</b>
	<b>1.5 - 2.5 mm<sup>2</sup></b>	<b>3829B.6( ) MS</b>			siehe Seite 336 voir page 336 see page 336	
Stand.-Packg.	4.8x0.8 / 4.8x0.8 500		4.8x0.8 / 4.8x0.8 500	4.8x0.8 / 4.8x0.8 500		6.3x0.8 / 4.8x0.8 500

Werkzeuge  
 Outils / Tools

**3976 / 3988**

\*1 Mit Erdungszeichen / Avec symbole de prise de terre / With earth sign