

# Accu-Pak™ Receptacles for 0.025" (0.64mm) and 0.032" (0.81mm) Thick Male Terminals

Loose Part No.	Reeled Part No.	Mating Terminal Size
1092-6	6092-6	0.025" (0.64mm) and 0.032" (0.81mm)
<b>Application Data</b>		
<b>Mounting Type</b>	Inward Splay or Accu-Lok™ "Split Leg"	<b>Mating Entry</b> Top and Horizontal
<b>Material Thickness/Type</b>	0.016" (0.41mm) Brass	<b>Applicator System</b> Loose: ZPT81-1092 Reeled: Model 9700, 9718
<b>Standard Finish</b>	Loose: 95/5 Matt Tin/Lead over Copper Reeled: 95/5 Matt Tin/Lead over Copper	
<b>Performance Data</b>		
<b>Current Rating</b>	20 Ampere	
<b>Resistance Rating</b>	1mΩ Max	
<b>Temperature Rating</b>	-65°C to 85°C	

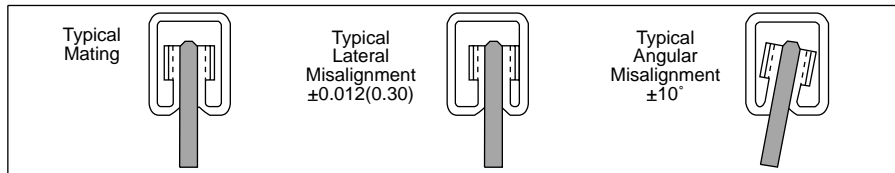
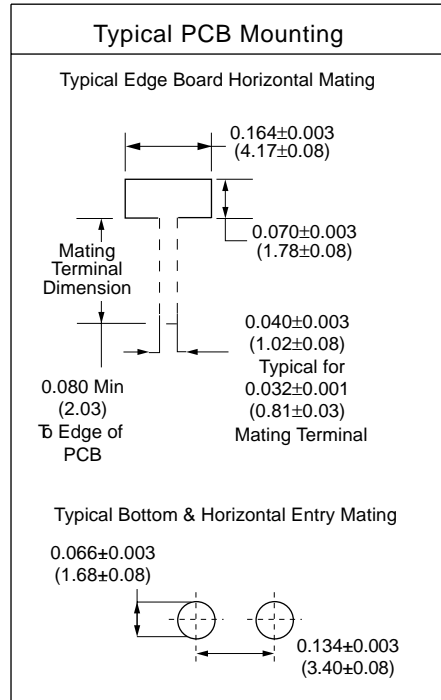
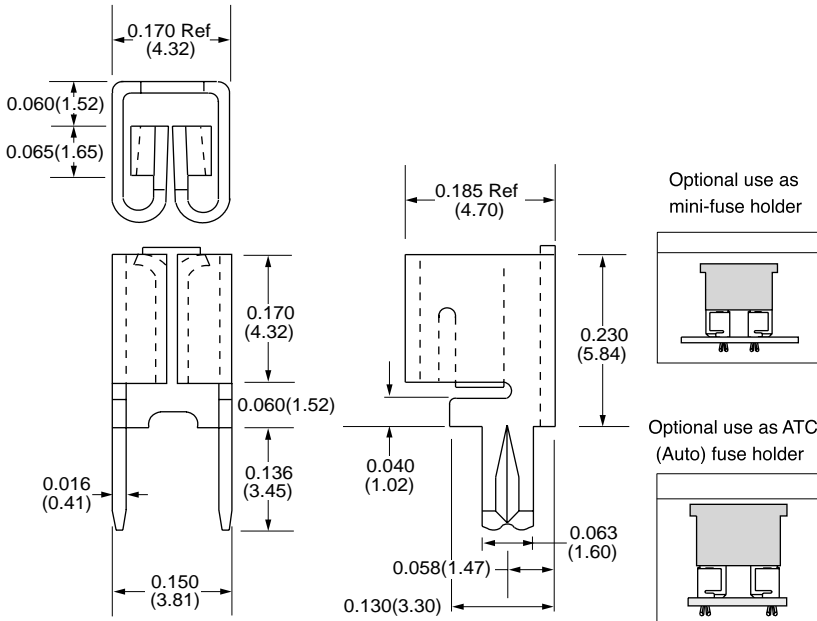

U.S. Patent No. 5,017,159

For exact finish specifications and available special finishes, see Finish Table (page 91).

# Accu-Pak™ Receptacles for 0.025" (0.64mm) and 0.032" (0.81mm) Thick Male Terminals

Loose Part No.	Reeled Part No.	Mating Terminal Size
1118-6	6118-6	0.025" (0.64mm) and 0.032" (0.81mm)
1188-6	6188-6	0.015" (0.38mm) and 0.025" (0.64mm)
Application Data		
<b>Mounting Type</b>	Inward Splay or Accu-Lok™ "Split Leg"	<b>Mating Entry</b> Bottom & Horizontal
<b>Material Thickness/Type</b>	0.016" (0.41mm) Brass	<b>Applicator System</b> Loose: ZPT81-1092 Reeled: Model 9700, 9718
<b>Standard Finish</b>	Loose: 95/5 Matt Tin/Lead over Copper Reeled: 95/5 Matt Tin/Lead over Copper	
Performance Data		
<b>Current Rating</b>	20 Ampere	
<b>Resistance Rating</b>	1mΩ Max	
<b>Temperature Rating</b>	-65°C to 85°C	

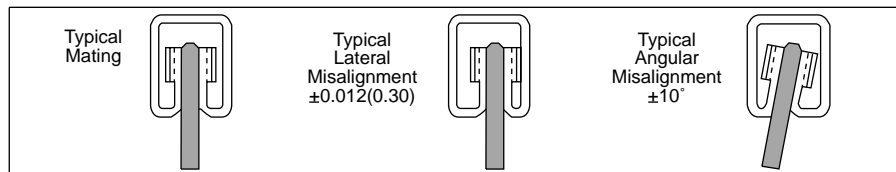
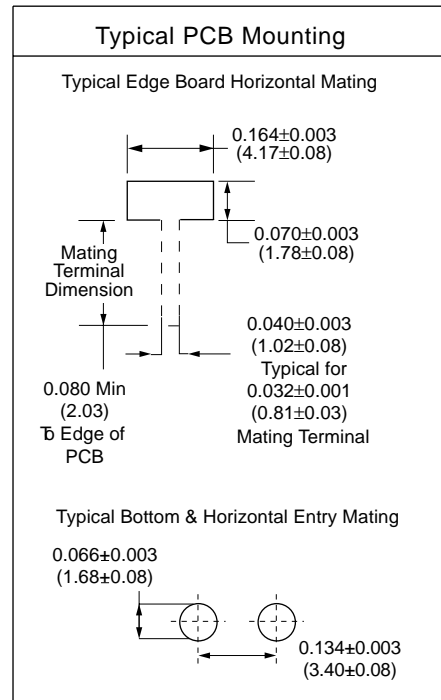
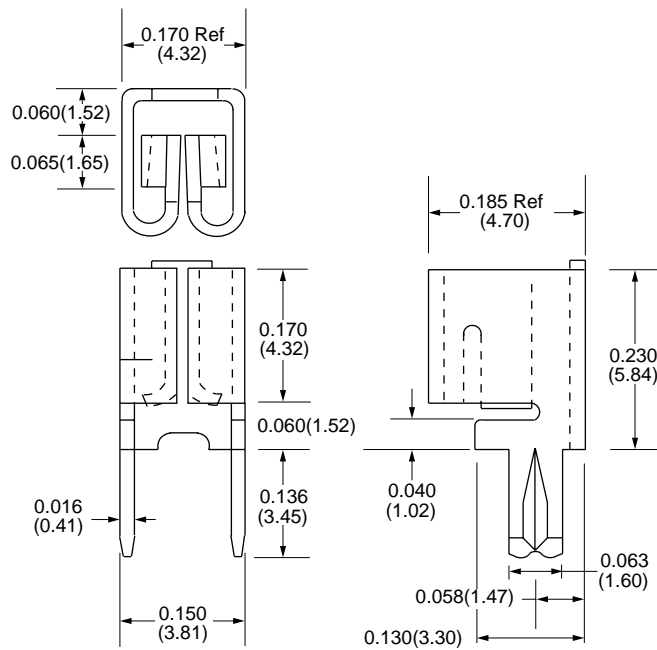

U.S. Patent No. 5,017,159  
For exact finish specifications and available special finishes, see Finish Table (page 91).