



## Ring Terminals

This series is basically subdivided into two large groups of terminals for screws with insulator support and terminals for screws without insulator support.

Within each subseries are different measurements for plates (outer diameter) as well as all the solutions Escubedo would like to offer for this family of connections.

## UL APPROVED REFERENCES

### UL

Following ring terminals are UL approved



REF	AWG	00	02	24
3310.	18-14	X	X	
3312.	18-14	X	X	
3370.	18-14	X	X	X
3371.	18-14	X	X	X
3372.	18-14	X	X	X
3373.	18-14	X	X	X
3374.	18-14	X	X	X
3375.	18-14	X	X	X
3377.	18-14	X	X	X
3378.	18-14	X	X	X
3402.	20-18	X	X	

REF	AWG	00	02
3403.	20-18	X	X
3404.	20-18	X	X
3408.	14-12	X	X
3409.	14-12	X	X
3410.	14-12	X	X
3417.	18-14	X	X
3418.	18-14	X	X
3419.	18-14	X	X
3423.	20-18	X	X
3424.	20-18	X	X
3425.	20-18	X	X

REF	AWG	00	02	24
3426.	18-14	X	X	
3427.	18-14	X	X	
3428.	18-14	X	X	
3429.	20-18	X	X	X
3431.	20-18	X	X	X
3432.	20-18	X	X	X
3433.	20-18	X	X	X
3434.	20-18	X	X	X
3435.	20-18	X	X	X
3437.	20-18	X	X	X
3440.	20-18	X	X	X
3442.	20-18	X	X	X

REF	AWG	00	02
3522.	20-18	X	X
3524.	20-18	X	X
3526.	20-18	X	X
3529.	20-18	X	X
3530.	18-14	X	X
3532.	18-14	X	X
3534.	18-14	X	X
3537.	18-14	X	X
3560.	14-10	X	X
3562.	14-10	X	X
3580.	14-10	X	X
3582.	14-10	X	X

NOTES:

# 01. 6 MM PLATE WHITOUT INSULATION SUPPORT



FIG. 1

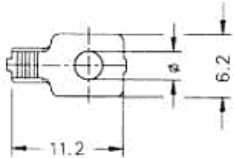
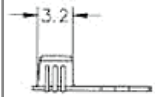

FIGURE	WIRE SIZE mm <sup>2</sup> (AWG)	Ø mm	STRIP FORM		MATERIAL	TREATMENT	MATERIAL WIDTH mm	PARTS COIL
			BASE	EXTENSION				
1	0,5-1,5 (20-16)	2,8	3650.	00	BRASS	-	0,4	20000
				02		SN		
				30	BRONZE	-		
				32		SN		
		3,2	3652.	00	BRASS	-		
				02		SN		
				30	BRONZE	-		
				32		SN		
		3,7	3654.	00	BRASS	-		
				02		SN		
				30	BRONZE	-		
				32		SN		

Ring Terminals

## 02. 7 MM PLATE WHITOUT INSULATION SUPPORT



FIG. 1

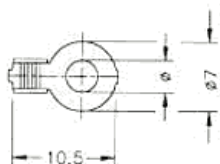
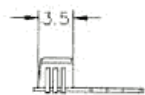

FIGURE	WIRE SIZE mm <sup>2</sup> (AWG)	Ø mm	STRIP FORM		MATERIAL	TREATMENT	MATERIAL WIDTH mm	PARTS COIL
			BASE	EXTENSION				
1	0,5-1,5 (20-16)	3,2	3622.	00	BRASS	-	0,4	20000
				02		SN		
				04		NI		
				24	STEEL	-		
				30	BRONZE	-		
				32		SN		
		3,7	3624.	00	BRASS	-		
				02		SN		
				04		NI		
				24	STEEL	-		
				30	BRONZE	-		
				32		SN		
		4,2	3626.	00	BRASS	-		
				02		SN		
				04		NI		
				24	STEEL	-		
				30	BRONZE	-		
				32		SN		



### 03. 7,7 MM PLATE WITHOUT INSULATION SUPPORT

FIG. 1

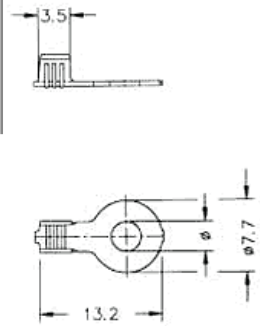

FIGURE	WIRE SIZE mm <sup>2</sup> (AWG)	Ø mm	STRIP FORM		MATERIAL	TREATMENT	MATERIAL WIDTH mm	PARTS COIL
			BASE	EXTENSION				
1	0,5-1,5 (20-16)	3,2	3628.	00	BRASS	-	0,5	15000
				02		SN		
				24	STEEL	NI		
				30	BRONZE	-		
				32		SN		
		3,7	3630.	00	BRASS	-		
				02		SN		
				24	STEEL	NI		
				30	BRONZE	-		
				32		SN		
		4,2	3632.	00	BRASS	-		
				02		SN		
				24	STEEL	NI		
				30	BRONZE	-		
				32		SN		
		5,2	3634.	00	BRASS	-		
				02		SN		
				24	STEEL	NI		
				30	BRONZE	-		
				32		SN		

# 04. FORKS WHITOUT INSULATION SUPPORT



FIG. 2

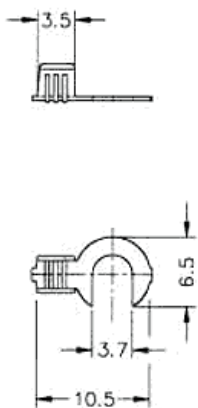

FIG. 1

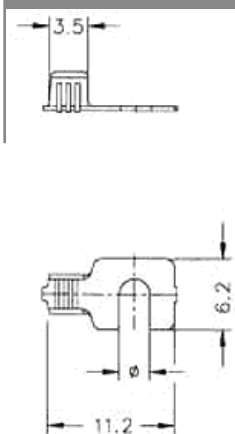

FIGURE	WIRE SIZE mm <sup>2</sup> (AWG)	Ø mm	STRIP FORM		MATERIAL	TREATMENT	MATERIAL WIDTH mm	PARTS COIL
			BASE	EXTENSION				
1	0,5-1,5 (20-16)	2,7	3856.	00	BRASS	-	0,4	20000
				02	BRASS	SN		
				30	BRONZE	-		
				32	BRONZE	SN		
		3,2	3858.	00	BRASS	-		
				02	BRASS	SN		
				30	BRONZE	-		
				32	BRONZE	SN		
		3,5	3860.	00	BRASS	-		
				02	BRASS	SN		
				30	BRONZE	-		
				32	BRONZE	SN		
2		3,7	3836.	00	BRASS	-		
				02	BRASS	SN		
				30	BRONZE	-		
				32	BRONZE	SN		

Ring Terminals

# 05. 4,5 MM PLATE WITH INSULATION SUPPORT



FIG. 1

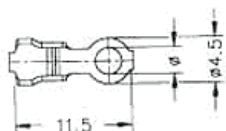
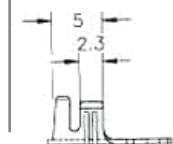
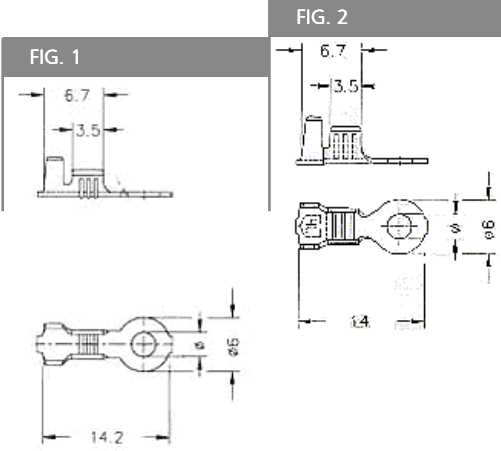

FIGURE	WIRE SIZE mm <sup>2</sup> (AWG)	Ø INSULATION mm	Ø mm	STRIP FORM		MATERIAL	TREATMENT	MATERIAL WIDTH mm	PARTS COIL
				BASE	EXTENSION				
1	0,5-1,5 (20-16)	1,8-3,3	2,3	3480.	00	BRASS	-	0,5	15000
					02		SN		
			2,6	3482.	00		-		
					02		SN		
			3,1	3484.	00		-		
					02		SN		
	1,5-2,5 (16-14)	3-4,3	2,3	3486.	00		-		
					02		SN		
			2,6	3488.	00		-		
					02		SN		
			3,1	3490.	00		-		
					02		SN		
								10000	

Ring Terminals



06. 6 MM PLATE WITH INSULATION SUPPORT



Ring Terminals

## 06. 6 MM PLATE WITH INSULATION SUPPORT

FIGURE	WIRE SIZE mm <sup>2</sup> (AWG)	Ø INSULATION mm	Ø mm	STRIP FORM		MATERIAL	TREATMENT	MATERIAL WIDTH mm	PARTS COIL
				BASE	EXTENSION				
1	0,5-1 (20-18)	1,8-2,5	3,2	3432.	00	BRASS	-	0,5	10000
					02		SN		
					24	STEEL	NI		
					30	BRONZE	-		
					32		SN		
			3,6	3434.	00	BRASS	-		
					02		SN		
					24	STEEL	NI		
					30	BRONZE	-		
					32		SN		
			2,7	3440.	00	BRASS	-		
					02		SN		
					24	STEEL	NI		
					30	BRONZE	-		
					32		SN		
			2,95	3442.	00	BRASS	-		
					02		SN		
					24	STEEL	NI		
					30	BRONZE	-		
					32		SN		
2	0,75-2 (18-14)	2,5-3,5	2,7	3450.	00	BRASS	-		
					02		SN		
					24	STEEL	NI		
					30	BRONZE	-		
					32		SN		
			3,2	3451.	00	BRASS	-		
					02		SN		
					24	STEEL	NI		
					30	BRONZE	-		
					32		SN		
			3,7	3452.	00	BRASS	-		
					02		SN		
					30	BRONZE	-		
					32		SN		
					24	STEEL	NI		

07. 7 MM PLATE WITH INSULATION SUPPORT

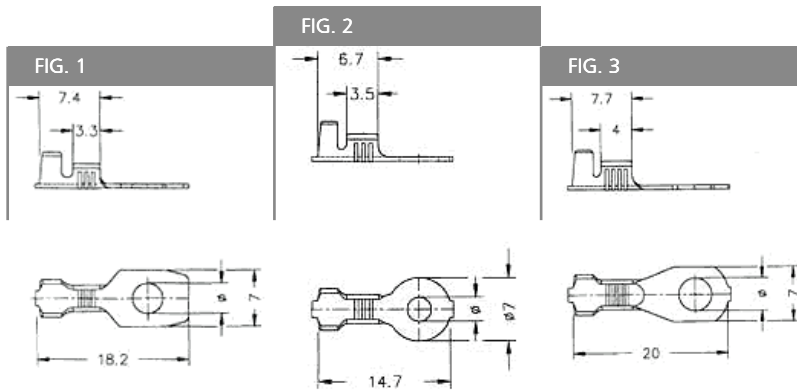

FIGURE	WIRE SIZE mm <sup>2</sup> (AWG)	Ø INSULATION mm	Ø mm	STRIP FORM		MATERIAL	TREATMENT	MATERIAL WIDTH mm	PARTS COIL			
				BASE	EXTENSION							
2	0,5-1 (20-18)	1,8-2,5	2,7	3429.	00	BRASS	-	0,5	10000			
					02		SN					
					24	STEEL	NI					
					30		-					
					32	BRONZE	SN					
					00		BRASS			-		
			02	SN								
			1	0,5-1 (20-18)	1,8-2,5	3,2	3508.		00	BRASS	-	8000
									02		SN	
									24	STEEL	NI	
									30		-	
									32	BRONZE	SN	
00	BRASS	-										
02		SN										
1	0,5-1 (20-18)	1,8-2,5				3,7	3510.	00	BRASS	-	8000	
								02		SN		
								24	STEEL	NI		
								30		-		
								32	BRONZE	SN		
			00	BRASS	-							
			02		SN							
			1	0,5-1 (20-18)	1,8-2,5	4,3	3512.	00	BRASS	-		8000
								02		SN		
								24	STEEL	NI		
								30		-		
								32	BRONZE	SN		
00	BRASS	-										
02		SN										
2	0,5-1 (20-18)	1,8-2,5				2,95	3514.	00	BRASS	-	8000	
								02		SN		
								24	STEEL	NI		
								30		-		
								32	BRONZE	SN		
			00	BRASS	-							
			02		SN							
			2	0,5-1 (20-18)	1,8-2,5	2,95	3431.	00	BRASS	-		10000
								02		SN		
								24	STEEL	NI		
						30	-					
						32	BRONZE	SN				
00	BRASS	-										
02		SN										
2	0,5-1 (20-18)	1,8-2,5	3,2	3433.	00	BRASS	-	10000				
					02		SN					
2	0,5-1 (20-18)	1,8-2,5	3,2	3433.	24	STEEL	NI	10000				

Ring Terminals

FIGURE	WIRE SIZE mm <sup>2</sup> (AWG)	Ø INSULATION mm	Ø mm	STRIP FORM BASE	PART N <sup>o</sup>		MATERIAL	TREATMENT	MATERIAL WIDTH mm	PARTS COIL
						EXTENSION				
2	0,5-1 (20-18)	1,8-2,5	3,2	3433.	30		BRONZE	-	0,5	10000
					32		BRONZE	SN		
			3,6	3435.	00		BRASS	-		
					02		BRASS	SN		
					24		STEEL	NI		
					30		BRONZE	-		
					32		BRONZE	SN		
					00		BRASS	-		
			4,3	3437.	02		BRASS	SN		
					24		STEEL	NI		
					30		BRONZE	-		
					32		BRONZE	SN		
	00				BRASS	-				
	02				BRASS	SN				
	0,75-2 (18-14)	2,5-3,5	2,7	3454.	00		BRASS	-		
					02		BRASS	SN		
					24		STEEL	NI		
					30		BRONZE	-		
					32		BRONZE	SN		
					00		BRASS	-		
			3,7	3456.	02		BRASS	SN		
					24		STEEL	NI		
					30		BRONZE	-		
					32		BRONZE	SN		
4,3			3457.	00		BRASS	-			
				02		BRASS	SN			
	24			STEEL	NI					
	30			BRONZE	-					
	32			BRONZE	SN					
	00			BRASS	-					
3	2,5-3,5	3,6	3386.	02		BRASS	SN			
				24		STEEL	NI			
				30		BRONZE	-			
				32		BRONZE	SN			
				00		BRASS	-			
				02		BRASS	SN			
		3,2	3455.	24		STEEL	NI			
				30		BRONZE	-			
				32		BRONZE	SN			
				00		BRASS	-			
				02		BRASS	SN			
				24		STEEL	NI			
4,2	3380.	30		BRONZE	-					
		32		BRONZE	SN					
		00		BRASS	-					
		02		BRASS	SN					
		24		STEEL	NI					
		30		BRONZE	-					
5,2	3382.	32		BRONZE	SN					
		00		BRASS	-					
		02		BRASS	SN					
		24		STEEL	NI					
		30		BRONZE	-					
		32		BRONZE	SN					
3	2,5-3,5	4,2	3384.	00		BRASS	-			
				02		BRASS	SN			
				24		STEEL	NI			
				30		BRONZE	-			
				32		BRONZE	SN			
				00		BRASS	-			



Ring Terminals



# 08. 8 MM PLATE WITH INSULATION SUPPORT

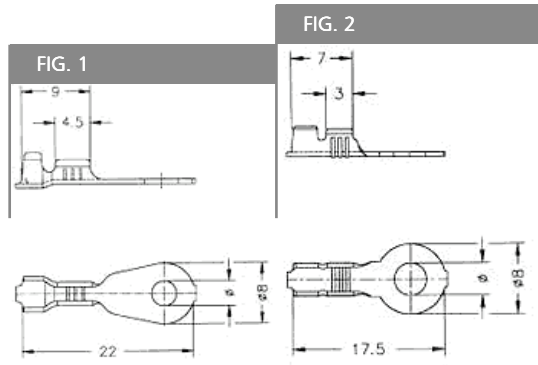

Ring Terminals

## 08. 8 MM PLATE WITH INSULATION SUPPORT

FIGURE	WIRE SIZE mm <sup>2</sup> (AWG)	Ø INSULATION mm	Ø mm	STRIP FORM		MATERIAL	TREATMENT	MATERIAL WIDTH mm	PARTS COIL			
				BASE	EXTENSION							
1	0,5-1 (20-18)	1,8-2,5	3,2	3423.	00	BRASS	-	0,6	7000			
					02		SN					
					30	BRONZE	-					
					32		SN					
			4,3	3424.	00	BRASS	-					
					02		SN					
					30	BRONZE	-					
					32		SN					
			5,3	3425.	00	BRASS	-					
					02		SN					
					30	BRONZE	-					
					32		SN					
2	0,75-1,5 (18-16)	2,5-3,3	5,2	3356.	00	BRASS	-	0,5	12000			
					02		SN					
			3,2	3350.	00		-					
					02		SN					
			4,2	3352.	00		-					
					02		SN					
			4,6	3354.	00		-					
					02		SN					
			3,2	3358.	00		BRASS	-	0,5	8000		
					02			SN				
					4,2			3360.			00	-
											02	SN
			4,6	3362.	00			-				
					02			SN				
			5,2	3464.	00			-				
					02			SN				
1	1-2,5 (18-14)	1,8-4,3	3,2	3426.	00	BRONZE		-	0,6	6000		
					02			SN				
					30			-				
					32			SN				
			4,3	3427.	00	BRASS		-				
					02			SN				
					30	BRONZE		-				
					32			SN				
			5,3	3428.	00	BRASS	-					
					02		SN					
					30	BRONZE	-					
					32		SN					

09. 8,6 MM PLATE WITH INSULATION SUPPORT

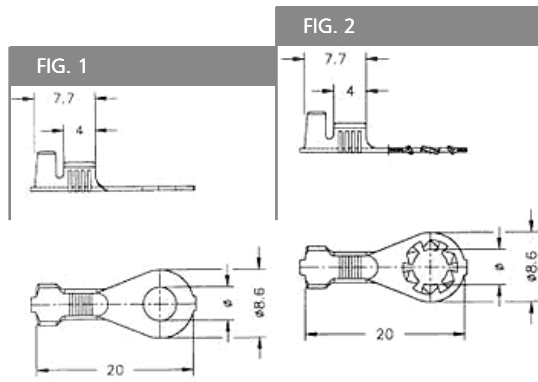
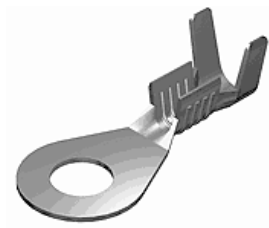

Ring Terminals

09. 8,6 MM PLATE WITH INSULATION SUPPORT

FIGURE	WIRE SIZE mm <sup>2</sup> (AWG)	Ø INSULATION mm	Ø mm	STRIP FORM		MATERIAL	TREATMENT	MATERIAL WIDTH mm	PARTS COIL
				BASE	EXTENSION				
1	0,75-2 (18-14)	2,5-3,5	3,2	3370.	00	BRASS	-	0,5	7000
					02		SN		
					24	STEEL	NI		
					30	BRONZE	-		
					32		SN		
			3,6	3371.	00	BRASS	-		
					02		SN		
					24	STEEL	NI		
					30	BRONZE	-		
					32		SN		
			4,2	3372.	00	BRASS	-		
					02		SN		
					24	STEEL	NI		
					30	BRONZE	-		
					32		SN		
			5,3	3377.	00	BRASS	-		
			4,8	3379.	00	BRASS	-		
					02		SN		
					24	STEEL	NI		
					30	BRONZE	-		
32	SN								
2			4,3	3375.	00	BRASS	-		
					02		SN		
					24	STEEL	NI		
					02	3377.	BRASS	SN	
24	STEEL	NI							
1			5,3	3374.	00	BRASS	-		
					02		SN		
					24	STEEL	NI		
					30	BRONZE	-		
			32	SN					
			6,3	3378.	00	BRASS	-		
					02		SN		
					24	STEEL	NI		
30	BRONZE	-							
32		SN							



10. 9,5 MM PLATE WITH INSULATION SUPPORT



FIG. 1

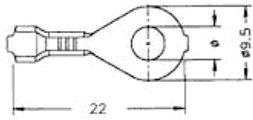
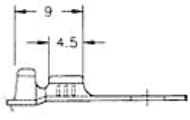

FIGURE	WIRE SIZE mm <sup>2</sup> (AWG)	Ø INSULATION mm	Ø mm	STRIP FORM		MATERIAL	TREATMENT	MATERIAL WIDTH mm	PARTS COIL	
				BASE	EXTENSION					
1	0,5-1 (20-18)	1,8-2,5	4,3	3402.	00	BRASS	-	0,6	6000	
					02		SN			
					30	BRONZE	-			
					32		SN			
			6,4	3404.	00	BRASS	-			
					02		SN			
		30			BRONZE	-				
		32				SN				
		5,3	3403.	00	BRASS	-				
				02		SN				
				30	BRONZE	-				
				32		SN				
	0,5-2,5 (20-14)			1,8-4,3	4,3	3420.	00	BRASS		-
							02			SN
		30	BRONZE				-			
		32					SN			
		5,2	3421.		00	BRASS	-			
					02		SN			
	30			BRONZE	-					
	32				SN					
	6,4	3422.	00	BRASS	-					
			02		SN					
			30	BRONZE	-					
			32		SN					
1,5-3 (20-12)	3-4,3	4,3	3414.	00	BRASS	-	1	5000		
				02		SN				
				30	BRONZE	-				
				32		SN				
		5,3	3415.	00	BRASS	-				
				02		SN				
				30	BRONZE	-				
				32		SN				

# 10. 9,5 MM PLATE WITH INSULATION SUPPORT

FIGURE	WIRE SIZE mm <sup>2</sup> (AWG)	Ø INSULATION mm	Ø mm	STRIP FORM		MATERIAL	TREATMENT	MATERIAL WIDTH mm	PARTS COIL
				BASE	EXTENSION				
1	1,5-3 (20-12)	3-4,3	6,4	3416.	00	BRASS	-	1	5000
					02		SN		
					30	BRONZE	-		
					32		SN		
	4,3		3417.	00	BRASS	-			
				02		SN			
				30	BRONZE	-			
				32		SN			
	5,3	3418.	00	BRASS	-				
			02		SN				
			30	BRONZE	-				
			32		SN				
	6,4	3419.	00	BRASS	-				
			02		SN				
			30	BRONZE	-				
			32		SN				
	2,5-4 (14-12)	3,3-4,5	4,3	3408.	00	BRASS	-	0,6	5000
					02		SN		
					30	BRONZE	-		
					32		SN		
			5,3	3409.	00	BRASS	-		
					02		SN		
					30	BRONZE	-		
					32		SN		
			6,4	3410.	00	BRASS	-		
					02		SN		
					30	BRONZE	-		
					32		SN		
4,3	3411.	00	BRASS	-					
		02		SN					
		30	BRONZE	-					
		32		SN					
6,4	3413.	00	BRASS	-					
		02		SN					
		30	BRONZE	-					
		32		SN					
5,3	3412.	00	BRASS	-					
		02		SN					
		30	BRONZE	-					
		32		SN					

# 11. 12 MM PLATE WITH INSULATION SUPPORT

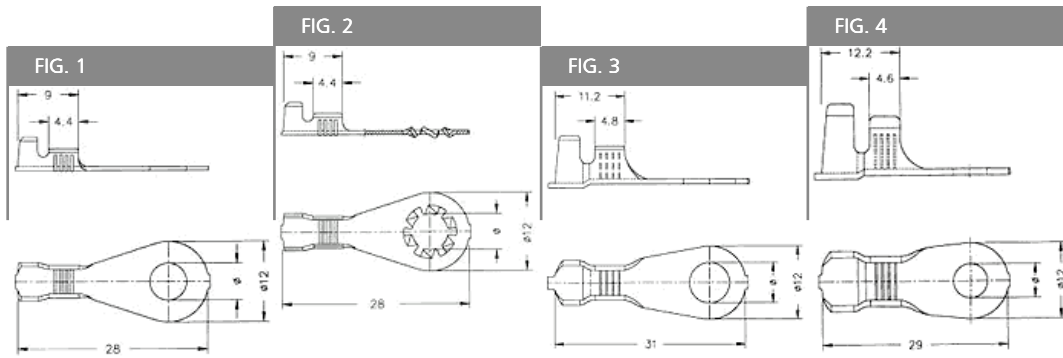

FIGURE	WIRE SIZE mm <sup>2</sup> (AWG)	Ø INSULATION mm	Ø mm	DIN	STRIP FORM BASE	PART N°		MATERIAL	TREATMENT	MATERIAL WIDTH mm	PARTS COIL				
						EXTENSION									
1	0,5-1 (20-18)	1,8-2,5	5,3	Esp	3522.	00		BRASS	-	0,6	3000				
						02			SN						
						30		BRONZE	-						
						32			SN						
			6,5		46225	3524.	00		BRASS			-			
							02					SN			
							30		BRONZE			-			
							32					SN			
		5,3	1,8-2,5	3566.	00		BRASS	-							
					02			SN							
					30		BRONZE	-							
					32			SN							
		6,5		1,8-2,5	3568.	00		BRASS	-						
						02			SN						
						30		BRONZE	-						
						32			SN						
2	0,5-1 (20-18)	1,8-2,5	2,7		Esp	3529.	00		BRASS	-	0,5	10000			
							02			SN					
							30		BRONZE	-					
							32			SN					
1			1-2,5 (18-14)	1,8-2,5		8,5	Esp	3526.	00		BRASS		-	0,6	3000
									02				SN		
									30		BRONZE		-		
									32				SN		
	5,3	3570.			00			BRASS	-						
					02				SN						
					30			BRONZE	-						
					32				SN						
	6,5	1,8-2,5		3530.	5,3	46225		3530.	00		BRASS	-	0,6		
									02			SN			
									30		BRONZE	-			
									32			SN			
00			BRASS	-											
02				SN											
30			BRONZE	-											
32				SN											
00		BRASS	-												
02			SN												
30		BRONZE	-												
32			SN												
00		BRASS	-												
02			SN												
30		BRONZE	-												
32			SN												
00		BRASS	-												
02			SN												
30		BRONZE	-												
32			SN												

FIGURE	WIRE SIZE mm <sup>2</sup> (AWG)	Ø INSULATION mm	Ø mm	DIN	STRIP FORM		MATERIAL	TREATMENT	MATERIAL WIDTH mm	PARTS COIL
					BASE	EXTENSION				
1	1-2,5 (18-14)	3-4,3	6,5	Esp	3532.	02	BRASS	SN	0,6	3000
						30	BRONZE	-		
						32	BRONZE	SN		
						00	BRASS	-		
						02	BRASS	SN		
						30	BRONZE	-		
			32		BRONZE	SN				
			8,5		3572.	00	BRASS	-		
						02	BRASS	SN		
						30	BRONZE	-		
						32	BRONZE	SN		
						00	BRASS	-		
02	BRASS	SN								
5,3	3576.	30	BRONZE	-						
		32	BRONZE	SN						
		00	BRASS	-						
		02	BRASS	SN						
		30	BRONZE	-						
		32	BRONZE	SN						
2	3537.	5,3	00	BRASS	-					
			02	BRASS	SN					
			30	BRONZE	-					
			32	BRONZE	SN					
			00	BRASS	-					
			02	BRASS	SN					
1	3574.	6,5	30	BRONZE	-					
			32	BRONZE	SN					
			00	BRASS	-					
			02	BRASS	SN					
			30	BRONZE	-					
			32	BRONZE	SN					
3	2.5-6 (14-10)	3,8-5	5,5	46225	3580.	00	BRASS	-	0,8	2000
						02	BRASS	SN		
						30	BRONZE	-		
						32	BRONZE	SN		
						00	BRASS	-		
						02	BRASS	SN		
4	6-10 (10-8)	4,6-7,7	5,5	Esp	3334.	30	BRONZE	-	1	1000
						32	BRONZE	SN		
						00	BRASS	-		
						02	BRASS	SN		
						00	BRASS	-		
						02	BRASS	SN		
4	6-10 (10-8)	4,6-7,7	6,5	46225	3336.	30	BRONZE	-	1	1000
						32	BRONZE	SN		
						00	BRASS	-		
						02	BRASS	SN		
						00	BRASS	-		
						02	BRASS	SN		



Ring Terminals

## 12. 14 MM PLATE WITH INSULATION SUPPORT

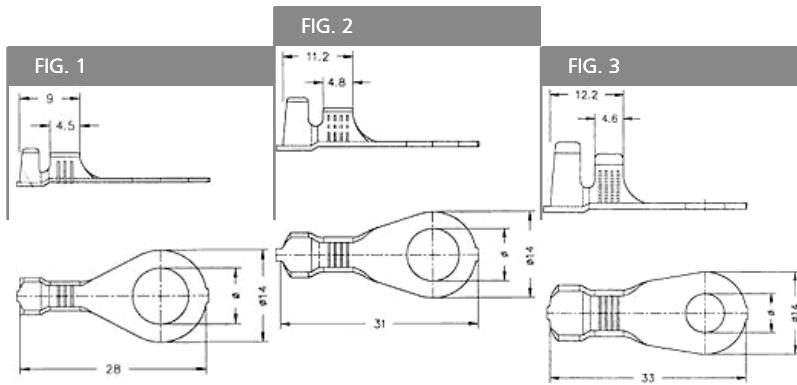

FIGURE	WIRE SIZE mm <sup>2</sup> (AWG)	Ø INSULATION mm	Ø mm	DIN	STRIP FORM		MATERIAL	TREATMENT	MATERIAL WIDTH mm	PARTS COIL
					BASE	EXTENSION				
1	1-2,5 (18-14)	3-4,3	8,5	Esp	3310.	00	BRASS	-	0,8	2500
						02	BRASS	SN		
						30	BRONZE	-		
						32	BRONZE	SN		
					3312.	00	BRASS	-		
						02	BRASS	SN		
						30	BRONZE	-		
						32	BRONZE	SN		
			8,5	46225	3446.	00	BRASS	-		
						02	BRASS	SN		
						30	BRONZE	-		
						32	BRONZE	SN		
					3448.	Esp	00	BRASS	-	
							02	BRASS	SN	
							30	BRONZE	-	
							32	BRONZE	SN	
9,5	Esp	3448.	00	BRASS	-					
			02	BRASS	SN					
			30	BRONZE	-					
			32	BRONZE	SN					
			9,5	Esp	3448.	00	BRASS	-		
						02	BRASS	SN		
						30	BRONZE	-		
						32	BRONZE	SN		

## 12. 14 MM PLATE WITH INSULATION SUPPORT

FIGURE	WIRE SIZE mm <sup>2</sup> (AWG)	Ø INSULATION mm	Ø mm	DIN	STRIP FORM		MATERIAL	TREATMENT	MATERIAL WIDTH mm	PARTS COIL
					BASE	EXTENSION				
2	2,5-6 (14-10)	3,8-5	6,5	Esp	3560.	00	BRASS	-	0,8	2000
						02		SN		
						30	BRONZE	-		
						32		SN		
			8,5	46225	3562.	00	BRASS	-		
						02		SN		
						30	BRONZE	-		
						32		SN		
3	6-10 (10-8)	4,6-7,7	6,5	Esp	3306.	00	BRASS	-	1	1500
						02		SN		
						30	BRONZE	-		
						32		SN		
			8,5	46225	3308.	00	BRASS	-		
						02		SN		
				Esp		30	BRONZE	-		
						32		SN		

13. 17 MM PLATE CON SOPORTE PARA AISLANTE

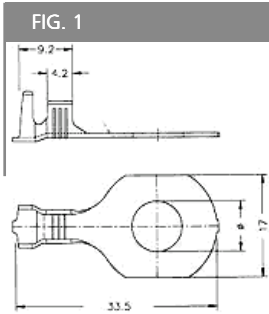
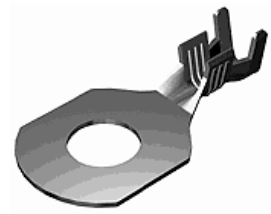

FIGURE	WIRE SIZE mm <sup>2</sup> (AWG)	Ø INSULATION mm	Ø mm	STRIP FORM		MATERIAL	TREATMENT	MATERIAL WIDTH mm	PARTS COIL
				BASE	EXTENSION				
1	2-4 (14-12)	3-4,5	8,25	3340.	10	BRASS	-	0,7	1500
					12		SN		
					30	BRONZE	-		
					32		SN		
	3-6 (12-10)	3,8-5		3342.	10	BRASS	-		1200
					12		SN		
					30	BRONZE	-		
					32		SN		

Ring Terminals

14. 18,5 MM PLATE WITH INSULATION SUPPORT

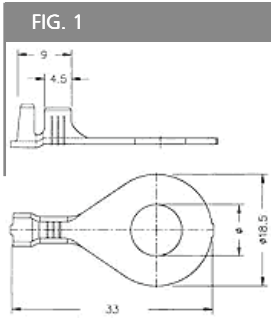

FIGURE	WIRE SIZE mm <sup>2</sup> (AWG)	Ø INSULATION mm	Ø mm	STRIP FORM		MATERIAL	TREATMENT	MATERIAL WIDTH mm	PARTS COIL
				BASE	EXTENSION				
1	1,54 (16-12)	3-4,3	10,5	3314.	00	BRASS	-	1	1500
					02		SN		
			12,5	3316.	30	BRONZE	-		
					32		SN		
			8,5	3496.	00	BRASS	-		
					02		SN		
			12,5	3316.	00		-		
					02		SN		

Ring Terminals



# 15. FORKS WITH INSULATION SUPPORT



FIG. 1

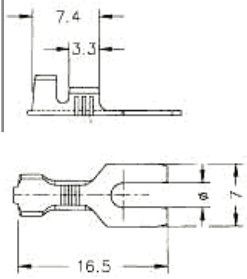

FIGURE	WIRE SIZE mm <sup>2</sup> (AWG)	Ø INSULATION mm	Ø mm	STRIP FORM		MATERIAL	TREATMENT	MATERIAL WIDTH mm	PARTS COIL
				BASE	EXTENSION				
1	0,5-1 (20-18)	1,8-2,5	2,7	3816.	00	BRASS	-	0,5	8000
					02		SN		
					30	BRONZE	-		
					32		SN		
			3,2	3818.	00	BRASS	-		
					02		SN		
					30	BRONZE	-		
					32		SN		
			3,7	3820.	00	BRASS	-		
					02		SN		
					30	BRONZE	-		
					32		SN		
			4,2	3840.	00	BRASS	-		
					02		SN		
					30	BRONZE	-		
					32		SN		

Ring Terminals

16. FLAGS WITH INSULATION SUPPORT

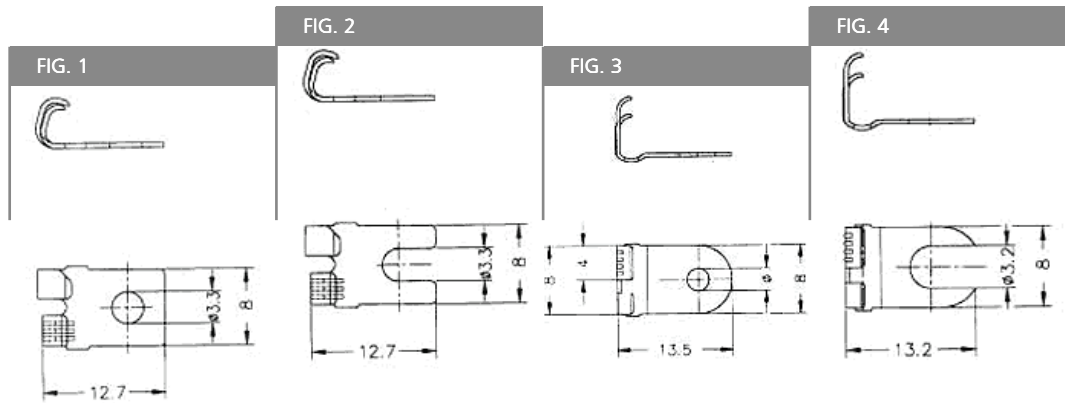

FIGURE	WIRE SIZE mm <sup>2</sup> (AWG)	Ø INSULATION mm	Ø mm	STRIP FORM		PART N°	MATERIAL	TREATMENT	MATERIAL WIDTH mm	PARTS COIL
				BASE	EXTENSION					
1	0,5-1,5 (20-16)	1,8-3,3	3,3	3895.	00	BRASS	-	0,4	5000	
					02	STEEL	SN			
					24	BRONZE	-			
					30	BRONZE	-			
					32	BRONZE	SN			
					32	BRONZE	SN			
			4,3	3896.	00	BRASS	-			
					02	BRASS	SN			
					24	STEEL	NI			
					30	BRONZE	-			
					32	BRONZE	SN			
					32	BRONZE	SN			
2	0,5-1,5 (20-16)	1,8-3,3	3,3	3395.	00	BRASS	-	0,4	5000	
					02	BRASS	SN			
					24	STEEL	NI			
					30	BRONZE	-			
					32	BRONZE	SN			
					32	BRONZE	SN			
			4,3	3396.	00	BRASS	-			
					02	BRASS	SN			
					24	STEEL	NI			
					30	BRONZE	-			
					32	BRONZE	SN			
					32	BRONZE	SN			
3	0,5-1,5 (20-16)	2-3,3	2,6	3388.	00	BRASS	-	0,4	5000	
					02	BRASS	SN			
					30	BRONZE	-			
					32	BRONZE	SN			
					32	BRONZE	SN			
					32	BRONZE	SN			
		3,2	3390.	00	BRASS	-				
				02	BRASS	SN				
				30	BRONZE	-				
				32	BRONZE	SN				
				32	BRONZE	SN				
				32	BRONZE	SN				

Ring Terminals

## 16. FLAGS WITH INSULATION SUPPORT

FIGURE	WIRE SIZE mm <sup>2</sup> (AWG)	Ø INSULATION mm	Ø mm	STRIP FORM		MATERIAL	TREATMENT	MATERIAL WIDTH mm	PARTS COIL
				BASE	EXTENSION				
<b>3</b>	0,5-1,5 (20-16)	2-3,3	4,2	<b>3392.</b>	00	BRASS	-	<b>0,4</b>	5000
					02		SN		
					30	BRONZE	-		
					32		SN		
			5,2	<b>3464.</b>	00	BRASS	-		
					02		SN		
					30	BRONZE	-		
					32		SN		
			2,6	<b>3466.</b>	00	BRASS	-		
					02		SN		
					30	BRONZE	-		
					32		SN		
			3,2	<b>3468.</b>	00	BRASS	-		
					02		SN		
					30	BRONZE	-		
					32		SN		
			4,2	<b>3470.</b>	00	BRASS	-		
					02		SN		
					30	BRONZE	-		
					32		SN		
			5,2	<b>3472.</b>	00	BRASS	-		
					02		SN		
					30	BRONZE	-		
					32		SN		
<b>4</b>			3,2	<b>3894.</b>	00	BRASS	-	<b>0,4</b>	
					02		SN		