

TP SC4

pneumatic
cutting forming
machine
for loose radial
components

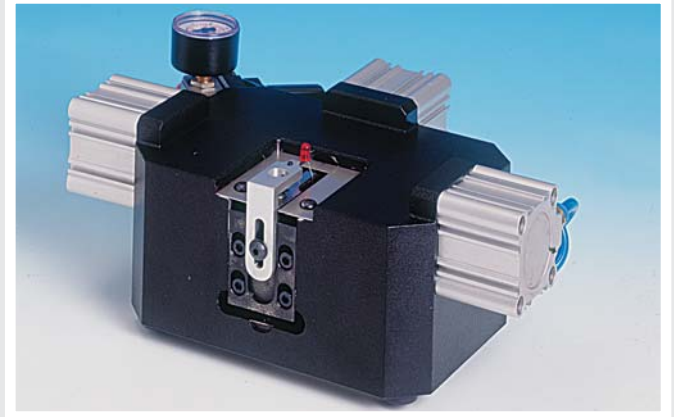

TP/SC4 STANDARD - 2 CYLINDERS - WITHOUT PREFORMING DIE (Code 16.0000)

TP/SC4 3 CYLINDERS - without preforming die (Code 16.0100)

LENGTH = 27 cm
WIDTH = 24 cm
HEIGHT = 11 cm
PACKING = 39x25x27 cm
VOLUME = 0,034 m³
MACHINE WEIGHT = 8 kg
GROSS WEIGHT = 10 kg

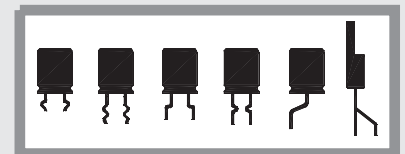

163000

CENTER LEAD SPREAD - DOUBLE KINK ON OUTER LEADS
ONLY SUPPLIED WITH TP/SC4 COD. 16.0100

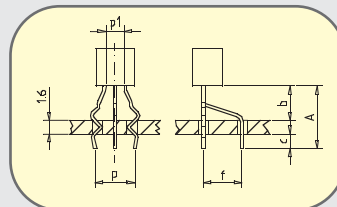

*= quote to be specified upon order

LEAD DIA. = 0,3 - 0,8mm (.011-.031")
PRODUCTION = 2.000 p/h

	MM		INCH			
	min	max	fix	min	max	fix
A*			6,1			.24
b*			3			.122
c*			1,5			.059
f*			2,54			.1
p*			5,08			.2
p1*			2,54			.1

The model TP/SC4 is a very flexible pneumatic machine designed for cutting and forming loose radial components. Any of the available forms (see pages 30 and 31) can be used with the standard version with two cylinders (16.0000). The model with three cylinders (16.0100) is suggested to operate power transistors, when it is necessary to spread out and form the outer leads and spread the central one. The simplicity of its operation and the large assortment of forms make this model one of the most reliable machines available on the market. The foot pedal controls the stroke of the lateral dies, that pushing the leads against the stationary die, perform a precise and fast cut and form. It is very quick and easy to change the complete die assembly and /or the inner die when a different pitch is needed. Each preforming assembly is supplied with all standard pitches. It is possible to obtain different pitches and special forms supplying OLAMEF with drawings and specifications.

die assemblies for TP/SC4 and TP/TS1 machines

160600/180600

STAND OFF-LOCK IN/DOUBLE KINK
P:=2,54 - 5,08 - 7,62 - 10,16 mm (.1 - .2 - .3 - .4")

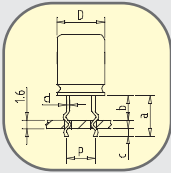

	MM			INCH		
	min	max	fix	min	max	fix
a	5	15		.196	.590	
b	2	12		.078	.472	
c			1,4			.055
d	0,4	0,8		.015	.031	
D	1	15		.039	.590	

161100/181100

DIODE BRIDGE 4 LEADS
P.5,08 mm (.2")

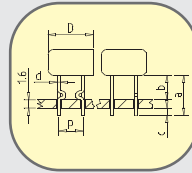

	MM			INCH		
	min	max	fix	min	max	fix
a	6	14		.236	.551	
b	4	12		.157	.472	
c			1,4			.055
d	0,4	0,8		.015	.031	
D	1	15		.039	.590	

160700/180700

STAND OFF-LOCK IN LED/DOUBLE KINK
P.2,54 mm (.1")

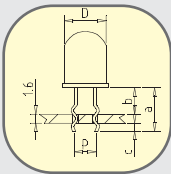

	MM			INCH		
	min	max	fix	min	max	fix
a	5	15		.196	.590	
b	2	12		.078	.472	
c			1,4			.055
D	2	5		.078	.196	

161200/181200

POLARITY
P.2,54 mm (.1")

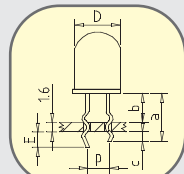

	MM			INCH		
	min	max	fix	min	max	fix
a	5	15		.196	.590	
b	2	12		.078	.472	
c			1,4			.055
D	2	5		.078	.196	
E			2,4			.094

160800/180800

STAND OFF-KINK OUTWARD
P:=2 - 2,54 - 5,08 - 7,62 - 10,16 mm (.78 - .1 - .2 - .3 - .4")

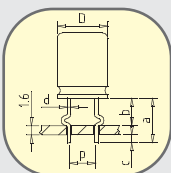

	MM			INCH		
	min	max	fix	min	max	fix
a	6	16		.236	.629	
b	3	13		.118	.511	
c			1,4			.055
d	0,4	0,8		.015	.031	
D	1	15		.039	.590	

161300/181300

90° BENDING

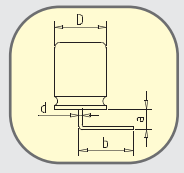

	MM			INCH		
	min	max	fix	min	max	fix
a	3	8		.118	.314	
b*			6			.236
c*	0,4	0,8		.015	.031	
D*	1	15		.039	.590	

160900/180900

BODY LOCKED ON P.C.BOARD
P:=2,54 - 5,08 - 7,62 - 10,16 mm (.1 - .2 - .3 - .4")

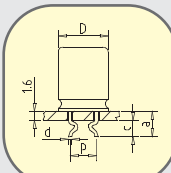

	MM			INCH		
	min	max	fix	min	max	fix
a			3			.118
c			1,4			.055
d	0,4	0,8		.015	.031	
D	1	15		.039	.590	

161400/181400

SURFACE MOUNTING

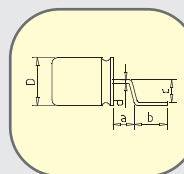

	MM			INCH		
	min	max	fix	min	max	fix
a	2,5	8		.098	.314	
b*			2			.078
c*			2,5			.098
d*	0,4	0,8		.015	.031	
D*	1	15		.039	.590	

161000/181000

STRAIGHT CUT
P:=2,54 - 5,08 - 7,62 - 10,16 mm (.1 - .2 - .3 - .4")

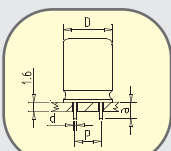

	MM			INCH		
	min	max	fix	min	max	fix
a	3	13		.118	.511	
d	0,4	0,8		.015	.031	
D	1	15		.039	.590	

161500/181500

STAND OFF/KINK INWARD
P:=2 - 2,54 - 5,08 - 7,62 - 10,16 mm (.78 - .1 - .2 - .3 - .4")

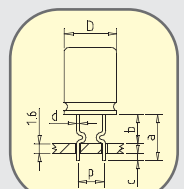

	MM			INCH		
	min	max	fix	min	max	fix
a	6	16		.236	.629	
b	3	13		.118	.511	
c			1,4			.055
d	0,4	0,8		.015	.031	
D	1	15		.039	.590	

161700/181700

TO SPREAD OUT AND CUT

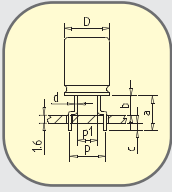

	MM			INCH		
	min	max	fix	min	max	fix
a	5	8		.196	.314	
b	2	5		.078	.196	
c			1,4			.055
d*	0,4	0,8		.015	.031	
D	1	15		.039	.590	
p1*			2,54			.1
p*			5,08			.2

162400/182400

TO-220 DOUBLE KINK ON THREE LEAD - IN LINE

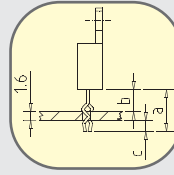

	MM			INCH		
	min	max	fix	min	max	fix
a	6	11		.236	.433	
b	3	8		.118	.314	
c			1,4			.055

162500/182500

TO-92 CENTER LEAD SPREAD

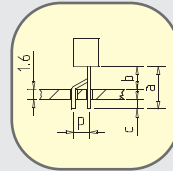

	MM			INCH		
	min	max	fix	min	max	fix
a	7	13		.275	.511	
b	4	10		.157	.393	
c			1,4			.055
p*			1,27			.05

161800/181800

TO REDUCE PITCH AND CUT

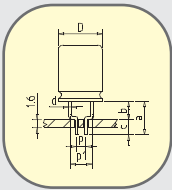

	MM			INCH		
	min	max	fix	min	max	fix
a	5	8		.196	.314	
b	2	5		.078	.196	
c			1,4			.055
d*	0,4	0,8		.015	.031	
D	1	15		.039	.590	
p1*			5,08			.2
p*			2,54			.1

162600/182600

TO-92 CENTER LEAD SPREAD AND LOCK

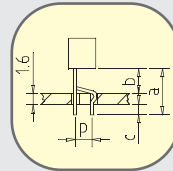

	MM			INCH		
	min	max	fix	min	max	fix
a	7	13		.275	.511	
b	4	10		.157	.393	
c			1,4			.055
p*			1,27			.05

162100/182100

TO-220 CENTRAL LEAD SPREAD AND CUT

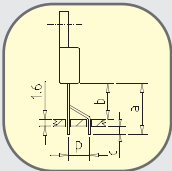

	MM			INCH		
	min	max	fix	min	max	fix
a	7	13		.275	.511	
b	4	10		.157	.393	
c			1,4			.055
p*			2,54			.1

162700/182700

TO-92 CENTER LEAD SPREAD/THREE LEAD LOCK

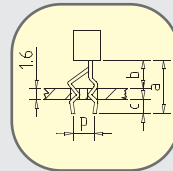

	MM			INCH		
	min	max	fix	min	max	fix
a	7	13		.275	.511	
b	4	10		.157	.393	
c			1,4			.055
p*			1,27			.05

162200/182200

TO-220 CENTER LEAD SPREAD AND LOCK

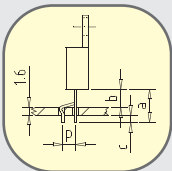

	MM			INCH		
	min	max	fix	min	max	fix
a	7	13		.275	.511	
b	4	10		.157	.393	
c			1,4			.055
p*			2,54			.1

162800/182800

TO-92 STAND OFF-LOCK IN/THREE LEAD IN LINE

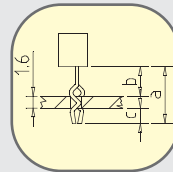

	MM			INCH		
	min	max	fix	min	max	fix
a	6	11		.236	.433	
b	3	8		.118	.314	
c			1,4			.055

162300/182300

TO-220 CENTER LEAD SPREAD/3 LEAD LOCK

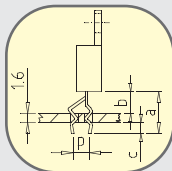

	MM			INCH		
	min	max	fix	min	max	fix
a	7	13		.275	.511	
b	4	10		.157	.393	
c			1,4			.055
p*			2,54			.1

163100/183100

TO-220 90° BENDING CENTER LEAD OFF SET

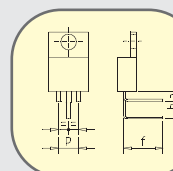

	MM			INCH		
	min	max	fix	min	max	fix
a	3	5		.118	.196	
b*			5			.196
f*			6			.216
p			5,08			.2

*quote to be specified upon order

TP/TS1

pneumatic
cutting forming
machine
for loose radial
components



TP/TS1 without preforming die (Cod. 18.0000)

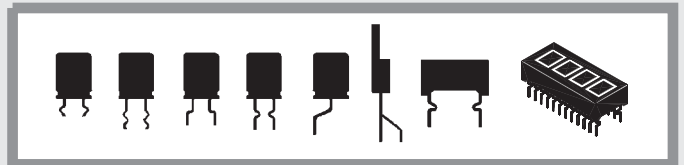

LENGTH = 39 cm
WIDTH = 23 cm
HEIGHT = 14 cm
PACKING = 45x40x27 cm
VOLUME: 0,0486 m³
MACHINE WEIGHT = 13 kg
GROSS WEIGHT = 14 kg

LEAD DIA. = 0,3-1,2 mm.
PRODUCTION = 2.000 p/h

The new model TP/TS1 is a pneumatic machine designed to cut and form the leads of loose radial components.

On the ground of the experience matured with the very well known TP/SC4 machine we have used still more strong, precise and reliable mechanical movement systems.

The feed of the outer punches which perform the operation on the component lead is controlled by the pneumatic foot pedal.

The machine dimensions allow also to form very large components (Maximum length 140mm, Maximum Pitch 45mm).

The TP/TS1 can operate many different forms and many other special ones can be manufactured on customer instructions.

die assemblies for TP/SC4 and TP/TS1 machines

160600/180600

STAND OFF-LOCK IN/DOUBLE KINK
P:=2,54 - 5,08 - 7,62 - 10,16 mm (.1 - .2 - .3 - .4")

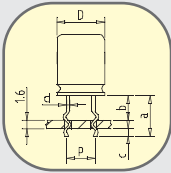

	MM			INCH		
	min	max	fix	min	max	fix
a	5	15		.196	.590	
b	2	12		.078	.472	
c			1,4			.055
d	0,4	0,8		.015	.031	
D	1	15		.039	.590	

161100/181100

DIODE BRIDGE 4 LEADS
P.5,08 mm (.2")

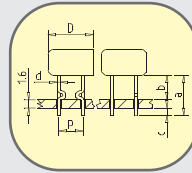

	MM			INCH		
	min	max	fix	min	max	fix
a	6	14		.236	.551	
b	4	12		.157	.472	
c			1,4			.055
d	0,4	0,8		.015	.031	
D	1	15		.039	.590	

160700/180700

STAND OFF-LOCK IN LED/DOUBLE KINK
P.2,54 mm (.1")

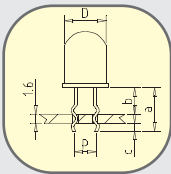

	MM			INCH		
	min	max	fix	min	max	fix
a	5	15		.196	.590	
b	2	12		.078	.472	
c			1,4			.055
D	2	5		.078	.196	

161200/181200

POLARITY
P.2,54 mm (.1")

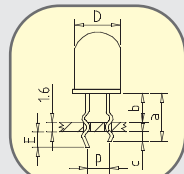

	MM			INCH		
	min	max	fix	min	max	fix
a	5	15		.196	.590	
b	2	12		.078	.472	
c			1,4			.055
D	2	5		.078	.196	
E			2,4			.094

160800/180800

STAND OFF-KINK OUTWARD
P:=2 - 2,54 - 5,08 - 7,62 - 10,16 mm (.78 - .1 - .2 - .3 - .4")

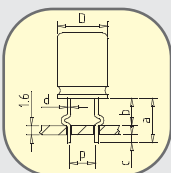

	MM			INCH		
	min	max	fix	min	max	fix
a	6	16		.236	.629	
b	3	13		.118	.511	
c			1,4			.055
d	0,4	0,8		.015	.031	
D	1	15		.039	.590	

161300/181300

90° BENDING

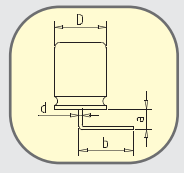

	MM			INCH		
	min	max	fix	min	max	fix
a	3	8		.118	.314	
b*			6			.236
c*	0,4	0,8		.015	.031	
D*	1	15		.039	.590	

160900/180900

BODY LOCKED ON P.C.BOARD
P:=2,54 - 5,08 - 7,62 - 10,16 mm (.1 - .2 - .3 - .4")

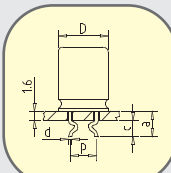

	MM			INCH		
	min	max	fix	min	max	fix
a			3			.118
c			1,4			.055
d	0,4	0,8		.015	.031	
D	1	15		.039	.590	

161400/181400

SURFACE MOUNTING

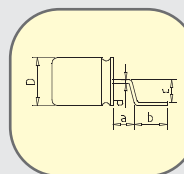

	MM			INCH		
	min	max	fix	min	max	fix
a	2,5	8		.098	.314	
b*			2			.078
c*			2,5			.098
d*	0,4	0,8		.015	.031	
D*	1	15		.039	.590	

161000/181000

STRAIGHT CUT
P:=2,54 - 5,08 - 7,62 - 10,16 mm (.1 - .2 - .3 - .4")

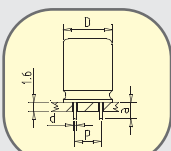

	MM			INCH		
	min	max	fix	min	max	fix
a	3	13		.118	.511	
d	0,4	0,8		.015	.031	
D	1	15		.039	.590	

161500/181500

STAND OFF/KINK INWARD
P:=2 - 2,54 - 5,08 - 7,62 - 10,16 mm (.78 - .1 - .2 - .3 - .4)

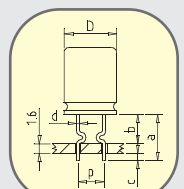

	MM			INCH		
	min	max	fix	min	max	fix
a	6	16		.236	.629	
b	3	13		.118	.511	
c			1,4			.055
d	0,4	0,8		.015	.031	
D	1	15		.039	.590	

161700/181700

TO SPREAD OUT AND CUT

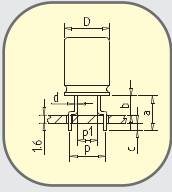

	MM			INCH		
	min	max	fix	min	max	fix
a	5	8		.196	.314	
b	2	5		.078	.196	
c			1,4			.055
d*	0,4	0,8		.015	.031	
D	1	15		.039	.590	
p1*			2,54			.1
p*			5,08			.2

162400/182400

TO-220 DOUBLE KINK ON THREE LEAD - IN LINE

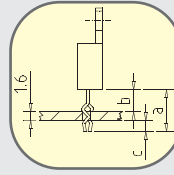

	MM			INCH		
	min	max	fix	min	max	fix
a	6	11		.236	.433	
b	3	8		.118	.314	
c			1,4			.055

162500/182500

TO-92 CENTER LEAD SPREAD

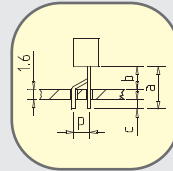

	MM			INCH		
	min	max	fix	min	max	fix
a	7	13		.275	.511	
b	4	10		.157	.393	
c			1,4			.055
p*			1,27			.05

161800/181800

TO REDUCE PITCH AND CUT

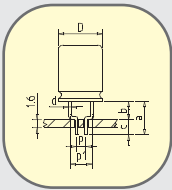

	MM			INCH		
	min	max	fix	min	max	fix
a	5	8		.196	.314	
b	2	5		.078	.196	
c			1,4			.055
d*	0,4	0,8		.015	.031	
D	1	15		.039	.590	
p1*			5,08			.2
p*			2,54			.1

162600/182600

TO-92 CENTER LEAD SPREAD AND LOCK

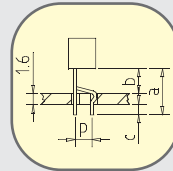

	MM			INCH		
	min	max	fix	min	max	fix
a	7	13		.275	.511	
b	4	10		.157	.393	
c			1,4			.055
p*			1,27			.05

162100/182100

TO-220 CENTRAL LEAD SPREAD AND CUT

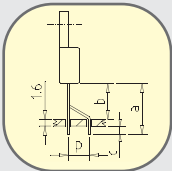

	MM			INCH		
	min	max	fix	min	max	fix
a	7	13		.275	.511	
b	4	10		.157	.393	
c			1,4			.055
p*			2,54			.1

162700/182700

TO-92 CENTER LEAD SPREAD/THREE LEAD LOCK

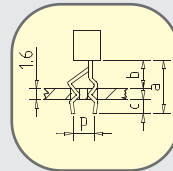

	MM			INCH		
	min	max	fix	min	max	fix
a	7	13		.275	.511	
b	4	10		.157	.393	
c			1,4			.055
p*			1,27			.05

162200/182200

TO-220 CENTER LEAD SPREAD AND LOCK

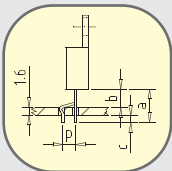

	MM			INCH		
	min	max	fix	min	max	fix
a	7	13		.275	.511	
b	4	10		.157	.393	
c			1,4			.055
p*			2,54			.1

162800/182800

TO-92 STAND OFF-LOCK IN/THREE LEAD IN LINE

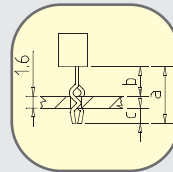

	MM			INCH		
	min	max	fix	min	max	fix
a	6	11		.236	.433	
b	3	8		.118	.314	
c			1,4			.055

162300/182300

TO-220 CENTER LEAD SPREAD/3 LEAD LOCK

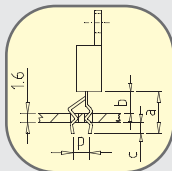

	MM			INCH		
	min	max	fix	min	max	fix
a	7	13		.275	.511	
b	4	10		.157	.393	
c			1,4			.055
p*			2,54			.1

163100/183100

TO-220 90° BENDING CENTER LEAD OFF SET

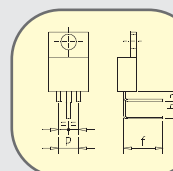

	MM			INCH		
	min	max	fix	min	max	fix
a	3	5		.118	.196	
b*			5			.196
f*			6			.216
p			5,08			.2

*quote to be specified upon order