



Scheiben

Bronze
Kupfer
Messing

Werkstoff:

BZ = Bronze
 CU = Kupfer
 MS = Messing

Oberflächenbehandlung:

bl = blank (0)
 ag = versilbert (1)
 au = vergoldet (2)
 ni = vernickelt (5)
 sn = verzinkt (8)

Bestellbeispiel:
Exemple de commande:
Example of order:

P01602302021
 (1.64 x 2.3 x 0.2 BZ ag)

Rondelles

bronze
cuivre
laiton

Matière:

BZ = bronze
 CU = cuivre
 MS = laiton

Traitements de surface:

bl = brut (0)
 ag = argenté (1)
 au = doré (2)
 ni = nickelé (5)
 sn = étamé (8)

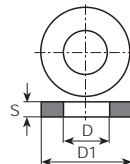

Washers

bronze
copper
brass

Material:

BZ = bronze
 CU = copper
 MS = brass

Surface-plating:

bl = clean (0)
 ag = silver-plated (1)
 au = gold-plated (2)
 ni = nickel-plated (5)
 sn = tin-plated (8)

Werkstoff Matière Material	øD mm	øD1 mm	S mm	DIN	Stand.-Packg.		Artikel-Nr. Numéro d'article Part-No.
					2000	5000	
Bronze	1.64	2.3	0.2			•	P0160230202()
	2.2	5	0.2			•	P0220500202()
Kupfer Cuivre Copper	4.2	9	0.3			•	P0420900304()
	5.3	8	0.6			•	P0530800604()
Messing Laiton Brass	0.7	1.6	0.4			•	P0070160406()
	1.2	3	0.3			•	P01203003065
	1.5	2.5	0.4			•	P0150250406()
		2.5	0.8			•	P0150250806()
	1.8	3	0.3	433		•	P0150300306()
		3.2	0.8			•	P0150320806()
	1.8	4.5	0.5			•	P0150450506()
		4	0.3	433		•	P0180400306()
	2.1	4.5	0.3	125		•	P0180450306()
		5.5	0.5			•	P0180550506()
	2.1	4	0.5			•	P0210400506()
		6.5	0.4			•	P0210650406()
	2.2	4.5	0.5	433		•	P0220450506()
		4.8	0.3			•	P0220480306()
	2.2	5.5	0.5	125		•	P0220550506()
		5.5	1.0			•	P0220551006()
	2.5	10	0.3			•	P0221000306()
		5	0.4	433		•	P0250500406()
	2.5	5	0.5	433		•	P0250500506()
		6	0.5	125		•	P0250600506()
	2.8	5	0.5			•	P0280500506()
		5.5	0.3			•	P0280550306()
	2.8	5.5	0.5	433		•	P0280550506()
		7	0.5	125		•	P0280700506()
	3	5	1.0			•	P0300501006()
		3.2	5	0.5			•
	3	5.5	0.5	522		•	P0320550506()
		6	0.1			•	P0320600106()
	3	6	0.3			•	P0320600306()
		6	0.5	433		•	P0320600506()
	3	6	0.8			•	P0320600806()
		6	1.0			•	P0320601006()
3	7	0.5	125		•	P0320700506()	
	8	0.1			•	P0320800106()	
3	8	0.2	522		•	P0320800206()	
	8	0.3	522		•	P0320800306()	
3	8	0.5	125		•	P0320800506()	
	12	1.0			•	P0321201006()	

Werkstoff Matière Material	øD mm	øD1 mm	S mm	DIN	Stand.-Packg.		Artikel-Nr. Numéro d'article Part-No.
					2000	5000	
Messing Laiton Brass	3.7	6	0.5			•	P0370600506()
		7	0.5	433		•	P0370700506()
3.7	3.7	8	0.5	125		•	P0370800506()
		9	0.5	125		•	P0370900506()
3.7	3.7	6	0.5			•	P0420600506()
		6.4	0.5			•	P0420640506()
3.7	3.7	7	0.5			•	P0420700506()
		7	1.2	522		•	P0420701206()
3.7	3.7	8	0.5	433		•	P0420800506()
		8	0.8			•	P0420800806()
3.7	3.7	9	0.6			•	P0420900606()
		10	0.5	522		•	P0421000506()
3.7	3.7	10	0.8	125		•	P0421000806()
		6.5	0.5			•	P0430650506()
3.7	3.7	7.5	0.5	522		•	P0430750506()
		8	0.5	433		•	P0430800506()
3.7	3.7	12	1.0			•	P0431201006()
		7.1	1.0			•	P0520711006()
3.7	3.7	8	0.7			•	P0520800706()
		8	0.5			•	P0530800506()
3.7	3.7	8	0.8			•	P0530800806()
		9	0.5			•	P0530900506()
3.7	3.7	10	0.5	522		•	P0531000506()
		10	0.8			•	P0531000806()
3.7	3.7	12	0.5			•	P0531200506()
		12	0.8	125		•	P0531200806()
3.7	3.7	10	0.5	522		•	P0551000506()
		11	0.2			•	P0561100206()
3.7	3.7	8.8	0.3	522		•	P0610880306()
		8.8	0.5			•	P0610880506()
3.7	3.7	8.8	0.8	522		•	P0610880806()
		10	0.5			•	P0621000506()
3.7	3.7	9	0.5			•	P0630900506()
		9	0.8			•	P0630900806()
3.7	3.7	12	0.5			•	P0631200506()
		14	1.5		1000	•	P0631401506()
3.7	3.7	12	0.5	522		•	P0721200506()
		14	0.5		1000	•	P0721400506()
3.7	3.7	11.5	1.0		1000	•	P0801151006()
		11.5	1.5		1000	•	P0801151506()
3.7	3.7	12	1.0		1000	•	P0801201006()
		22	0.5		1000	•	P1052200506()

Andere Abmessungen auf Anfrage

Autres dimensions sur demande

Further dimensions on request



Scheiben Stahl

Rondelles acier

Washers steel

Werkstoff:

ST = Stahl

Oberflächenbehandlung:

bl = blank (0)
 br = brüniert (3)
 ni = vernickelt (5)
 zn = verzinkt (9)

Matière:

ST = acier

Traitements de surface:

bl = brut (0)
 br = noirci (3)
 ni = nickelé (5)
 zn = zingué (9)

Material:

ST = steel

Surface-plating:

bl = clean (0)
 br = burnished (3)
 ni = nickel-plated (5)
 zn = zinc-plated (9)

Bestellbeispiel:
Exemple de commande:
Example of order:

P01804003090
 (1.8 x 4.0 x 0.3 ST bl)

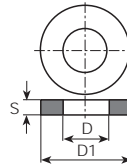

Werkstoff Matière Material	øD mm	øD1 mm	S mm	DIN	Stand.-Packg.		Artikel-Nr. Numéro d'article Part-No.	Werkstoff Matière Material	øD mm	øD1 mm	S mm	DIN	Stand.-Packg.		Artikel-Nr. Numéro d'article Part-No.
					2000	5000							2000	5000	
Stahl Acier Steel	1.8	4	0.3	433		•	P0180400309()	Stahl Acier Steel	5	11	1.0	522	•	P0501101009()	
		4.5	0.3	125	•	P0180450309()	•						P0530800209()		
		4.5	1.2		•	P0180451209()	•						P0530800509()		
2.1	5	0.5	433	433	•	P0210500509()	10	0.5	433	•	125	•	P0531000809()		
														4.5	0.5
2.2	5.5	0.5	125	433	•	P0220550509()	10	0.8	433	•	125	•	P0531001009()		
														5	0.5
2.5	6	0.5	125	433	•	P0250600509()	11	0.5	125	•	125	•	P0531101009()		
														6	0.5
2.7	6.5	0.5	433	433	•	P0280550509()	12	0.5	433	•	125	•	P0531201009()		
														6	0.5
2.8	7	0.4	125	433	•	P0280700409()	20	1.5	433	•	500	•	P0621000309()		
														7	0.5
3.2	7	0.5	522	433	•	P0320500509()	12	1.0	522	•	1000	•	P0630800509()		
														5	0.5
3.7	6	0.5	433	433	•	P0320600509()	10	0.8	522	•	1000	•	P0641000809()		
														6	0.8
4.1	7	0.5	125	433	•	P0320700509()	14	1.0	522	•	1000	•	P0641401009()		
														7	1.5
4.15	8	0.5	125	433	•	P0320800509()	14	1.5	522	•	1000	•	P0721200309()		
														8	1.2
4.2	8	1.5	125	433	•	P0320801509()	12.2	1.2	522	•	1000	•	P0801221209()		
														8	1.5
4.6	9	0.5	125	433	•	P0320901009()	14	0.8	522	•	1000	•	P0811080509()		
														9	1.0
4.6	10	0.5	125	433	•	P0321001009()	12	0.2	522	•	1000	•	P0901150509()		
														10	1.0
4.6	10	0.8	125	433	•	P0321200509()	13	1.6	522	•	1000	•	P0921302009()		
														6	0.5
4.6	7	0.6	522	433	•	P0370700509()	13	2.0	522	•	1000	•	P1001500509()		
														7	0.5
4.6	8	0.8	125	433	•	P0370900509()	12	0.5	522	•	1000	•	P1001500509()		
														8	0.8
4.6	9	0.8	125	433	•	P0410700709()	15	0.5	522	•	1000	•	P1001500509()		
														9	0.8
4.6	10	0.8	125	433	•	P0420600509()	21	1.0	522	•	1000	•	P1002101009()		
														7	0.5
4.6	8	0.5	433	433	•	P0420800509()	13	0.5	522	•	1000	•	P1002101009()		
														8	0.8
4.6	8	1.2	125	433	•	P0420801209()	13	0.5	522	•	1000	•	P1002101009()		
														8	1.2
4.6	9	0.5	125	433	•	P0420900809()	10	0.5	522	•	1000	•	P1002101009()		
														9	0.8
4.6	10	0.5	125	433	•	P0421000509()	14	1.5	522	•	1000	•	P1002101009()		
														10	0.8
4.6	14	1.5	522	433	•	P0421401509()	7	0.6	522	•	1000	•	P1002101009()		
														7	0.6

Andere Abmessungen auf Anfrage

Autres dimensions sur demande

Further dimensions on request