

Plastic Screw 15.M~

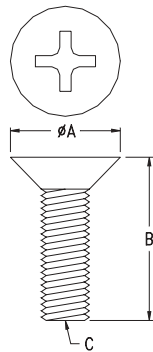

- Material: P.C. (UL)/Nylon 66 (UL)
- Flame Class: 94V-2
- Color: Natural
- Unit: mm

Part	A	B	C	Pack Size
M3-5F	5.3	4.8	M3X0.5P	1000
M3-6F	5.6	6.0	M3X0.5P	1000
M3-8F	5.6	8.0	M3X0.5P	1000
M3-10F	5.6	10.0	M3X0.5P	1000
M3-12F	5.6	12.0	M3X0.5P	1000
M3-14F	5.6	14.0	M3X0.5P	1000
M4-8F	7.6	8.0	M4X0.7P	1000
M4-10F	7.6	10.0	M4X0.7P	1000
M4-12F	7.6	12.0	M4X0.7P	1000
M4-14F	7.6	14.0	M4X0.7P	1000
M4-16F	7.6	16.0	M4X0.7P	1000

Plastic Screw 15.M~ and 15.R~

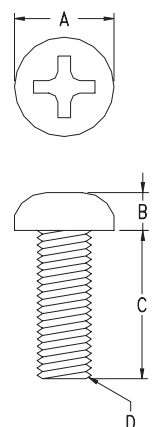

- Material: P.C. (UL)/Nylon 66
- Flame Class: 94V-2
- Color: Natural
- Unit: mm

Part	A	B	C	D	Pack Size
M2-3	3.5	1.4	3.0	M2X0.4P	2000
M2-4	3.5	1.4	4.0	M2X0.4P	2000
M2-5	3.5	1.4	5.0	M2X0.4P	2000
M2-6	3.5	1.4	6.0	M2X0.4P	2000
M2-6.5	3.5	1.4	6.5	M2X0.4P	2000
M2.6-6	4.3	1.5	6.0	M2.6X0.45P	2000
M2.6-8	4.3	1.5	8.0	M2.6X0.45P	2000
M2.6-10	4.3	1.5	10.0	M2.6X0.45P	2000
M3-4	5.5	2.1	4.0	M3X0.5P	2000
M3-6	5.5	2.1	6.0	M3X0.5P	2000
M3-8	5.5	2.1	8.0	M3X0.5P	1000
M3-10	5.5	2.1	10.0	M3X0.5P	1000
M3-12	5.5	2.1	12.0	M3X0.5P	2000
M3-15	5.5	2.1	15.0	M3X0.5P	1000
M3-17	5.5	2.1	17.0	M3X0.5P	1000
M3-18	5.5	2.1	18.0	M3X0.5P	1000
M3-20	5.5	2.1	20.0	M3X0.5P	1000
M3-25	5.5	2.1	25.0	M3X0.5P	1000
M4-8	7.0	2.5	8.0	M4X0.7P	1000
M4-10	7.0	2.5	10.0	M4X0.7P	1000
M4-12	7.0	2.5	12.0	M4X0.7P	1000
M4-14	7.0	2.5	14.0	M4X0.7P	1000
M4-16	7.0	2.5	16.0	M4X0.7P	1000
M4-20	7.0	2.5	20.0	M4X0.7P	1000
M4-25	7.0	2.5	25.0	M4X0.7P	1000
M4-30	7.0	2.5	30.0	M4X0.7P	1000
M4-35	7.0	2.5	35.0	M4X0.7P	1000
M5-20	9.1	3.6	20.0	M5X0.8P	1000
R632-6	6.7	2.0	6.35	#6-32P	2000
R632-8	6.7	2.0	8.0	#6-32P	2000
R632-9	6.7	2.0	9.5	#6-32P	2000
R632-12	6.7	2.0	12.7	#6-32P	1000
R632-15	6.7	2.0	15.9	#6-32P	1000
R632-19	6.7	2.0	19.1	#6-32P	1000
R440-6	5.2	2.1	6.4	#4-40P	2000
R440-8	5.2	2.1	8.0	#4-40P	2000
R440-9	5.2	2.1	9.5	#4-40P	1000
R440-12	5.2	2.1	12.7	#4-40P	1000
R440-15	5.2	2.1	15.5	#4-40P	1000

Plastic Screw 15.M~ and 15.S~

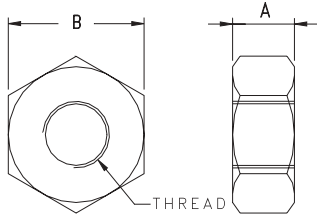

- Material: P.C. (UL)/Nylon 66 (UL)
- Flame Class: 94V-2
- Color: Natural
- Unit: mm

Part	A	B	Thread	Pack Size
M-2.6	2.0	5.0	M2.6X0.45P	2000
M-3	2.5	5.5	M3X0.5P	2000
M-3.5	2.8	5.9	M3.5X0.6P	2000
M-4	3.3	6.9	M4X0.7P	1000
M-5	4.4	8.0	M5X0.8P	1000
S4-40	2.5	6.4	#4-40	1000
S6-32	3.2	7.9	#6-32	1000

Plastic Screw 15.M~ and 15.S~

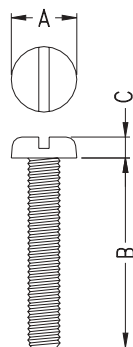

- Material: P.C. (UL)/Nylon (UL)
- Flame Class: 94V-2
- Color: Natural
- Unit: mm

Part	A	B	C	Pack Size
M3.5-10	6.9	10.0	M3.5X0.6P	1000
M3.5-15	6.9	15.0	M3.5X0.6P	1000
M3.5-20	6.9	20.0	M3.5X0.6P	1000
M3.5-25	6.9	25.0	M3.5X0.6P	1000
M3.5-30	6.9	30.0	M3.5X0.6P	1000
S632-6	6.7	6.35	#6-32	2000
S632-8	6.7	8.0	#6-32	2000
S632-9	6.7	9.5	#6-32	1000
S632-12	6.7	12.7	#6-32	1000
S632-15	6.7	15.9	#6-32	1000
S632-19	6.7	19.1	#6-32	1000
S440-6	5.2	6.4	#4-40	2000
S440-8	5.2	8.0	#4-40	2000
S440-9	5.2	9.5	#4-40	2000
S440-12	5.2	12.7	#4-40	1000
S440-15	5.2	15.5	#4-40	1000

Plastic Screw 15.MR4~

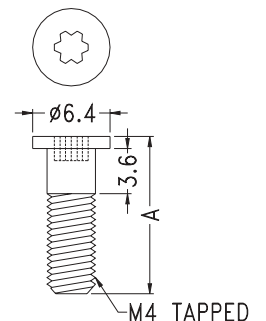

- Material: P.C. (UL)
- Flame Class: 94V-2
- Color: Clear
- Unit: mm

Part	A	Pack Size
MR4-9.5	9.5	1000
MR4-12	12.0	1000

Plastic Screw 15.MRL4-3

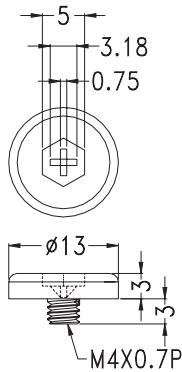

- Material: Nylon (UL)
- Flame Class: 94V-2
- Color: Black
- Unit: mm

Part	Pack Size
MRL4-3	1000

Plastic Screw 15.SUS~

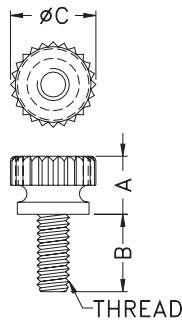

- Material: Nylon (UL)
- Flame Class: 94V-2
- Color: Natural/Black
- Unit: mm

Part	A	B	C	Thread	Color	Pack Size
SUS632	6.9	9.8	9.0	6-32 UNC	Natural	1000
SUS832(B)	7.2	9.6	10.6	8-32 UNC	Black	1000