



Vogt Verbindungstechnik

Form	øD1 mm	S mm	L mm	Werkstoff Matière Material	Stand.-Packg.		Artikel-Nr. Numéro d'article Part-No.
					2'000	5'000	

Form	øD1 mm	S mm	L mm	Werkstoff Matière Material	Stand.-Packg.		Artikel-Nr. Numéro d'article Part-No.
					2'000	5'000	
A*	2	0.2	1.5	CU	•		A20015020.4()
A*	2	0.2	1.5	MS	•		A20015020.6()
A*	2	0.2	1.8	MS	•		A20018020.6()
A	2	0.2	2	MS	•		A20020020.6()
B	2	0.2	2	MS	•		B20020020.6()
A*	2	0.25	2	MS	•		A20020025.6()
B*	2	0.25	2	MS	•		B20020025.6()
A	2	0.3	2	AL	•		A20020030.10
A	2	0.3	2	MS	•		A20020030.6()
A*	2	0.4	2	MS	•		A20020040.6()
A*	2	0.3	2.3	AL	•		A20023030.10
C*	2	0.2	2.4	MS	•		C20024020.6()
B*	2	0.25	2.5	MS	•		B20025025.6()
A	2	0.3	2.5	MS	•		A20025030.6()
A*	2	0.4	2.5	MS	•		A20025040.6()
B	2	0.2	3	MS	•		B20030020.6()
A*	2	0.25	3	MS	•		A20030025.6()
B*	2	0.25	3	MS	•		B20030025.6()
A	2	0.3	3	AL	•		A20030030.10
A	2	0.3	3	MS	•		A20030030.6()
B	2	0.3	3	MS	•		B20030030.6()
B	2	0.2	3.5	MS	•		B20035020.6()
A*	2	0.25	3.5	MS	•		A20035025.6()
B*	2	0.25	3.5	MS	•		B20035025.6()
A	2	0.3	3.5	AL	•		A20035030.10
A	2	0.3	3.5	MS	•		A20035030.6()
B	2	0.3	3.5	MS	•		B20035030.6()
B*	2	0.35	3.5	MS	•		B20035035.6()
B*	2	0.3	3.8	MS	•		B20038030.6()

Andere Abmessungen auf Anfrage
 Nieteinsätze siehe Seite 584A

Autres dimensions sur demande
 Pièces de rechange voir page 584A

Further dimensions on request
 Inserts for pliers see page 584A



Rohrnieten

Aluminium, Kupfer,
Messing, Stahl
DIN 7340, ausgenommen*

Rivets tubulaires

aluminium, cuivre
laiton, acier
DIN 7340, *excepté

Tubular rivets

aluminium, copper
brass, steel
DIN 7340, *excepted

Werkstoff:

AL = Aluminium
CU = Kupfer
MS = Messing
ST = Stahl

Matière:

AL = aluminium
CU = cuivre
MS = laiton
ST = acier

Material:

AL = aluminium
CU = copper
MS = brass
ST = steel

Oberflächenbehandlung:

bl = blank (0)
ag = versilbert (1)
au = vergoldet (2)
ni = vernickelt (5)
sn = verzinkt (8)

Traitements de surface:

bl = brut (0)
ag = argenté (1)
au = doré (2)
ni = nickelé (5)
sn = étamé (8)

Surface-plating:

bl = clean (0)
ag = silver-plated (1)
au = gold-plated (2)
ni = nickel-plated (5)
sn = tin-plated (8)

Bestellbeispiel:
Exemple de commande:
Example of order:

A20040025.65
(A2.0 x 0.25 x 4.0 MS ni)

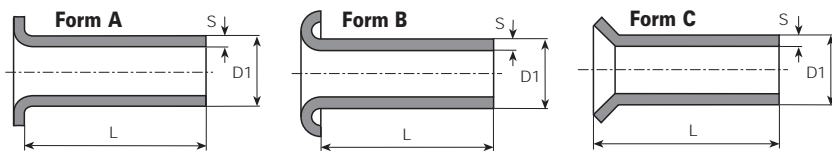

Form	øD1 mm	S mm	L mm	Werkstoff Matière Material	Stand.-Packg.		Artikel-Nr. Numéro d'article Part-No.
					2'000	5'000	
A*	2	0.25	4	MS		•	A20040025.6()
B*	2	0.25	4	MS		•	B20040025.6()
A	2	0.3	4	AL		•	A20040030.10
A	2	0.3	4	CU		•	A20040030.4()
A	2	0.3	4	MS		•	A20040030.6()
B	2	0.3	4	MS		•	B20040030.6()
B*	2	0.25	4.5	MS		•	B20045025.6()
A*	2	0.3	4.5	MS		•	A20045030.6()
B*	2	0.3	4.5	MS		•	B20045030.6()
B*	2	0.25	5	MS		•	B20050025.6()
A	2	0.3	5	CU		•	A20050030.4()
A	2	0.3	5	MS		•	A20050030.6()
B	2	0.3	5	MS		•	B20050030.6()
B*	2	0.4	5	MS		•	B20050040.6()
A*	2	0.25	5.5	MS		•	A20055025.6()
B*	2	0.25	5.5	MS		•	B20055025.6()
B*	2	0.25	6	MS		•	B20060025.6()
A	2	0.3	6	MS		•	A20060030.6()
B	2	0.3	6	MS		•	B20060030.6()
A*	2	0.3	6.5	MS		•	A20065030.6()
B*	2	0.3	6.5	MS		•	B20065030.6()
B*	2	0.4	6.5	MS		•	B20065040.6()
B*	2	0.25	7	MS		•	B20070025.6()
B	2	0.3	7	AL		•	A20070030.10
A	2	0.3	7	MS		•	A20070030.6()
B	2	0.3	7	MS		•	B20070030.6()
A*	2	0.4	7	MS		•	A20070040.6()
B*	2	0.4	7	MS		•	B20070040.6()
A*	2	0.25	7.5	MS		•	A20075025.6()
A	2	0.3	8	AL		•	A20080030.10
A	2	0.3	8	MS		•	A20080030.6()
B	2	0.3	8	MS		•	B20080030.6()
A*	2	0.4	8	MS		•	A20080040.6()
B*	2	0.4	8	MS		•	B20080040.6()
B*	2	0.3	8.7	AL		•	B20087030.10
B*	2	0.25	9	MS		•	B20090025.6()
A*	2	0.3	9	MS		•	A20090030.6()
B*	2	0.3	9	MS		•	B20090030.6()
A*	2	0.4	9	MS		•	A20090040.6()
B*	2	0.4	9	MS		•	B20090040.6()
A*	2	0.3	9.5	MS		•	A20095030.6()
B*	2	0.3	9.5	MS		•	B20095030.6()
A	2	0.2	10	MS		•	A20100020.6()
B	2	0.2	10	MS		•	B20100020.6()
A	2	0.3	10	MS		•	A20100030.6()
B	2	0.3	10	MS		•	B20100030.6()

Form	øD1 mm	S mm	L mm	Werkstoff Matière Material	Stand.-Packg.		Artikel-Nr. Numéro d'article Part-No.
					2'000	5'000	
A*	2	0.3	11	MS		•	A20110030.6()
A	2	0.2	12	MS		•	A20120020.6()
A*	2	0.25	12	MS		•	A20120025.6()
A	2	0.3	12	MS		•	A20120030.6()
B	2	0.3	12	MS		•	B20120030.6()
A*	2	0.4	12	MS		•	A20120040.6()
A*	2	0.25	12.7	ST		•	A20127025.9()
A*	2	0.25	13	MS		•	A20130025.6()
B*	2	0.25	13	MS		•	B20130025.6()
B*	2	0.3	13	AL		•	B20130030.10
B*	2	0.3	13	MS		•	B20130030.6()
B*	2	0.25	14	MS		•	B20140025.6()
A*	2	0.3	14	MS		•	A20140030.6()
A*	2	0.25	14.7	ST		•	A20147025.9()
A	2	0.3	15	MS		•	A20150030.6()
B	2	0.3	15	MS		•	B20150030.6()
A*	2	0.4	15	MS		•	A20150040.6()
A*	2	0.25	16	MS		•	A20160025.6()
A*	2	0.3	16	MS		•	A20160030.6()
A*	2	0.5	16	MS		•	A20160050.6()
A	2	0.3	18	MS		•	A20180030.6()
A	2	0.2	20	MS		•	A20200020.6()
B	2	0.3	20	AL		•	B20200030.10
A*	2	0.4	20	MS		•	A20200040.6()
A*	2	0.3	21	MS		•	A20210030.6()
A	2	0.2	22	MS		•	A20220020.6()
A*	2	0.25	23	MS		•	A20230025.6()
B*	2	0.3	23	MS		•	B20230030.6()
A*	2	0.2	23.5	MS	1000		A20235020.6()
A	2	0.3	25	MS	1000		A20250030.6()
A	2	0.3	30	MS	1000		A20300030.6()
A*	2	0.25	32	MS	1000		A20320025.6()
A*	2	0.3	40	MS	1000		A20400030.6()
A*	2	0.3	50	MS	1000		A20500030.6()

Andere Abmessungen auf Anfrage
Nieteinsätze siehe Seite 584A

Autres dimensions sur demande
Pièces de rechange voir page 584A

Further dimensions on request
Inserts for pliers see page 584A



Vogt Verbindungstechnik

Form	øD1 mm	S mm	L mm	Werkstoff Matière Material	Stand.-Packg.		Artikel-Nr. Numéro d'article Part-No.	Form	øD1 mm	S mm	L mm	Werkstoff Matière Material	Stand.-Packg.		Artikel-Nr. Numéro d'article Part-No.
					2'000	5'000							2'000	5'000	
A*	2.2	0.25	2.5	MS		•	A22025025.6()	B	2.5	0.25	4	MS		•	B25040025.6()
B*	2.2	0.25	2.5	MS		•	B22025025.6()	A	2.5	0.3	4	AL		•	A25040030.10
B*	2.2	0.25	3	MS		•	B22030025.6()	A	2.5	0.3	4	MS		•	A25040030.6()
B*	2.2	0.2	3.5	CU		•	B22035020.4()	B	2.5	0.3	4	MS		•	B25040030.6()
B*	2.2	0.25	3.5	MS		•	B22035025.6()	B*	2.5	0.25	4.5	MS		•	B25045025.6()
A*	2.2	0.25	4	MS		•	A22040025.6()	A*	2.5	0.3	4.5	AL		•	A25045030.10
B*	2.2	0.25	4	MS		•	B22040025.6()	B*	2.5	0.3	4.5	AL		•	B25045030.10
B*	2.2	0.25	4.5	MS		•	B22045025.6()	A*	2.5	0.3	4.5	MS		•	A25045030.6()
A*	2.2	0.3	4.5	MS		•	A22045030.6()	B*	2.5	0.3	4.5	MS		•	B25045030.6()
B*	2.2	0.2	4.7	MS		•	B22047020.6()	A*	2.5	0.3	4.5	ST		•	A25045030.9()
A*	2.2	0.25	5	MS		•	A22050025.6()	A*	2.5	0.2	5	MS		•	A25050020.6()
B*	2.2	0.25	5	MS		•	B22050025.6()	A	2.5	0.25	5	MS		•	A25050025.6()
B*	2.2	0.25	5.5	MS		•	B22055025.6()	B	2.5	0.25	5	MS		•	B25050025.6()
B*	2.2	0.25	6	MS		•	B22060025.6()	A	2.5	0.3	5	MS		•	A25050030.6()
B*	2.2	0.25	6.5	MS		•	B22065025.6()	A	2.5	0.4	5	MS		•	A25050040.6()
B*	2.2	0.25	7	MS		•	B22070025.6()	A*	2.5	0.25	5.5	MS		•	A25055025.6()
A*	2.2	0.2	8	MS		•	A22080020.6()	A*	2.5	0.3	5.5	MS		•	A25055030.6()
B*	2.2	0.25	8	MS		•	B22080025.6()	B*	2.5	0.3	5.5	MS		•	B25055030.6()
B*	2.2	0.25	8.5	MS		•	B22085025.6()	B	2.5	0.25	6	MS		•	B25060025.6()
B*	2.2	0.25	9	MS		•	B22090025.6()	A	2.5	0.3	6	MS		•	A25060030.6()
B*	2.2	0.25	9.5	MS		•	B22095025.6()	B	2.5	0.3	6	MS		•	B25060030.6()
B*	2.2	0.25	10	MS		•	B22100025.6()	B*	2.5	0.25	6.5	MS		•	B25065025.6()
A*	2.2	0.25	11	MS		•	A22110025.6()	A*	2.5	0.3	6.5	MS		•	A25065030.6()
A*	2.2	0.25	15	MS		•	A22150025.6()	B*	2.5	0.3	6.5	MS		•	B25065030.6()
B*	2.2	0.25	17	MS		•	B22170025.6()	B	2.5	0.25	7	MS		•	B25070025.6()
B*	2.2	0.25	55.2	MS	500	•	B22552025.6()	A	2.5	0.3	7	MS		•	A25070030.6()
A*	2.2	0.3	86.3	MS	500	•	A22863030.6()	B	2.5	0.3	7	MS		•	B25070030.6()
B*	2.3	0.25	3.5	MS		•	B23035025.6()	B	2.5	0.4	7	CU		•	B25070040.4()
B*	2.3	0.25	4	MS		•	B23040025.6()	A	2.5	0.4	7	MS		•	A25070040.6()
B*	2.3	0.3	4	MS		•	B23040030.6()	B	2.5	0.4	7	MS		•	B25070040.6()
B*	2.3	0.25	5	MS		•	B23050025.6()	A*	2.5	0.25	7.5	MS		•	A25075025.6()
B*	2.3	0.25	10	MS		•	B23100025.6()	B*	2.5	0.25	7.5	MS		•	B25075025.6()
A*	2.3	0.25	11.7	MS		•	A23117025.6()	B	2.5	0.25	8	MS		•	B25080025.6()
A*	2.3	0.25	35	MS	1000	•	A23350025.6()	A	2.5	0.3	8	MS		•	A25080030.6()
A*	2.3	0.25	35.7	MS	1000	•	A23357025.6()	A	2.5	0.4	8	MS		•	A25080040.6()
A*	2.3	0.25	36.5	MS	1000	•	A23365025.6()	B	2.5	0.4	8	MS		•	B25080040.6()
A*	2.3	0.25	48.6	MS	1000	•	A23486025.6()	A*	2.5	0.3	8.5	MS		•	A25085030.6()
A*	2.3	0.25	52.5	MS	1000	•	A23525025.6()	B*	2.5	0.3	8.5	MS		•	B25085030.6()
A*	2.3	0.25	60.7	MS	500	•	A23607025.6()	B*	2.5	0.15	9	MS		•	B25090015.6()
A*	2.3	0.25	70.1	MS	500	•	A23701025.6()	A*	2.5	0.25	9	MS		•	A25090025.6()
A*	2.3	0.25	73.5	MS	500	•	A23735025.6()	B*	2.5	0.25	9	MS		•	B25090025.6()
A*	2.3	0.25	83	MS	500	•	A23830025.6()	A*	2.5	0.3	9	MS		•	A25090030.6()
A*	2.3	0.25	85.6	MS	500	•	A23856025.6()	B*	2.5	0.3	9	MS		•	B25090030.6()
A*	2.3	0.25	86.7	MS	500	•	A23867025.6()	A*	2.5	0.4	9	MS		•	A25090040.6()
A*	2.3	0.3	92	MS	500	•	A23920030.6()	A*	2.5	0.3	9.5	MS		•	A25095030.6()
A*	2.3	0.25	98.4	MS	500	•	A23984025.6()	B*	2.5	0.3	9.5	MS		•	B25095030.6()
B*	2.4	0.25	2.5	MS		•	B24025025.6()	B*	2.5	0.4	9.5	AL		•	B25095040.10
B*	2.4	0.3	4.5	MS		•	B24045030.6()	B*	2.5	0.15	10	MS		•	B25095040.6()
A*	2.4	0.25	5.5	MS		•	A24055025.6()	A	2.5	0.25	10	MS		•	A25100015.6()
B*	2.4	0.25	6.5	MS		•	B24065025.6()	B	2.5	0.25	10	MS		•	B25100025.6()
B*	2.4	0.25	7	MS		•	B24070025.6()	A	2.5	0.3	10	MS		•	A25100030.6()
B*	2.4	0.25	9	MS		•	B24090025.6()	B	2.5	0.3	10	MS		•	B25100030.6()
B*	2.4	0.25	10	MS		•	B24100025.6()	A	2.5	0.4	10	MS		•	A25100040.6()
A*	2.4	0.25	15	MS		•	A24150025.6()	B	2.5	0.4	10	MS		•	B25100040.6()
B*	2.4	0.25	15	MS		•	B24150025.6()	A*	2.5	0.25	11	MS		•	A25110025.6()
B*	2.4	0.3	15	MS		•	B24150030.6()	A*	2.5	0.3	11	MS		•	A25110030.6()
B*	2.4	0.25	20	MS		•	B24200025.6()	A*	2.5	0.3	11.5	MS		•	A25115030.6()
B*	2.4	0.3	20	MS		•	B24200030.6()	B	2.5	0.25	12	MS		•	B25120025.6()
A*	2.5	0.15	1.9	MS		•	A25019015.6()	A	2.5	0.3	12	MS		•	A25120030.6()
C*	2.5	0.25	2	MS		•	C25020025.6()	B*	2.5	0.25	13	MS		•	B25130025.6()
B*	2.5	0.25	2.5	MS		•	B25025025.6()	B*	2.5	0.3	14	MS		•	B25140030.6()
A*	2.5	0.3	2.5	MS		•	A25025030.6()	B*	2.5	0.4	14	MS		•	B25140040.6()
B	2.5	0.25	3	MS		•	B25030025.6()	B	2.5	0.25	15	MS		•	B25150025.6()
A	2.5	0.3	3	MS		•	A25030030.6()	A	2.5	0.3	15	MS		•	A25150030.6()
B	2.5	0.3	3	MS		•	B25030030.6()	A	2.5	0.4	15	MS		•	A25150040.6()
A	2.5	0.4	3	MS		•	A25030040.6()	A*	2.5	0.3	16	MS		•	A25160030.6()
A	2.5	0.25	3.5	MS		•	A25035025.6()	B*	2.5	0.4	16	MS		•	B25160040.6()
B	2.5	0.25	3.5	MS		•	B25035025.6()	B*	2.5	0.25	17	MS		•	B25170025.6()
A	2.5	0.3	3.5	MS		•	A25035030.6()	B*	2.5	0.3	17	MS		•	B25170030.6()
B	2.5	0.3	3.5	MS		•	B25035030.6()	C*	2.5	0.3	17	MS		•	C25170030.6()
B	2.5	0.3	3.5	MS		•	B25035030.6()	B*	2.5	0.25	17.5	MS		•	B25175025.6()

Andere Abmessungen auf Anfrage
 Nieteinsätze siehe Seite 584A

Autres dimensions sur demande
 Pièces de rechange voir page 584A

Further dimensions on request
 Inserts for pliers see page 584A



Rohrnieten

Aluminium, Kupfer,
Messing, Stahl
DIN 7340, ausgenommen*

Rivets tubulaires

aluminium, cuivre
laiton, acier
DIN 7340, *excepté

Tubular rivets

aluminium, copper
brass, steel
DIN 7340, *excepted

Werkstoff:

AL = Aluminium
CU = Kupfer
MS = Messing
ST = Stahl

Matière:

AL = aluminium
CU = cuivre
MS = laiton
ST = acier

Material:

AL = aluminium
CU = copper
MS = brass
ST = steel

Oberflächenbehandlung:

bl = blank (0)
ag = versilbert (1)
au = vergoldet (2)
ni = vernickelt (5)
sn = verzinkt (8)

Traitements de surface:

bl = brut (0)
ag = argenté (1)
au = doré (2)
ni = nickelé (5)
sn = étamé (8)

Surface-plating:

bl = clean (0)
ag = silver-plated (1)
au = gold-plated (2)
ni = nickel-plated (5)
sn = tin-plated (8)

Bestellbeispiel:
Exemple de commande:
Example of order:

A25180025.65
(A2.5 x 0.25 x 18.0 MS ni)

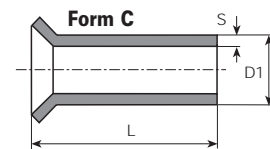
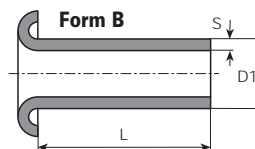
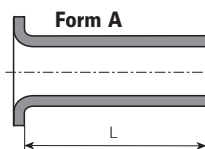

Form	øD1 mm	S mm	L mm	Werkstoff Matière Material	Stand.-Packg.		Artikel-Nr. Numéro d'article Part-No.
					2'000	5'000	
A	2.5	0.25	18	MS	•		A25180025.6()
B	2.5	0.25	18	MS	•		B25180025.6()
B	2.5	0.4	18	MS	•		B25180040.6()
A	2.5	0.3	20	MS	•		A25200030.6()
B	2.5	0.3	20	MS	•		B25200030.6()
B	2.5	0.3	22	MS	1000		B25220030.6()
A	2.5	0.4	22	MS	1000		A25220040.6()
B*	2.5	0.3	23	MS	1000		B25230030.6()
A*	2.5	0.3	23.5	MS	1000		A25235030.6()
A	2.5	0.3	25	MS	1000		A25250030.6()
B*	2.5	0.3	26	MS	1000		B25260030.6()
A*	2.5	0.3	27	MS	1000		A25270030.6()
A	2.5	0.4	30	MS	1000		A25300040.6()
B*	2.5	0.3	33	MS	1000		B25330030.6()
A*	2.5	0.3	38.5	MS	1000		A25385030.6()
A*	2.5	0.3	43	MS	1000		A25430030.6()
A*	2.5	0.3	45	MS	1000		A25450030.6()
B*	2.5	0.3	46.5	MS	1000		B25465030.6()
A*	2.5	0.3	50	MS	1000		A25500030.6()
A*	2.5	0.4	50	MS	1000		A25500040.6()
A*	2.5	0.3	55	MS	1000		A25550030.6()
B*	2.6	0.2	2.6	MS	•		B26026020.6()
B*	2.6	0.2	3	MS	•		B26030020.6()
A*	2.6	0.2	4	MS	•		A26040020.6()
B*	2.6	0.25	4	MS	•		B26040025.6()
B*	2.6	0.2	4.5	MS	•		B26045020.6()
B*	2.6	0.2	5	MS	•		B26050020.6()
B*	2.6	0.2	5.5	MS	•		B26055020.6()
B*	2.6	0.4	5.5	MS	•		B26055040.6()
B*	2.6	0.2	6	MS	•		B26060020.6()
B*	2.6	0.2	7	MS	•		B26070020.6()
B*	2.6	0.4	7	MS	•		B26070040.6()
B*	2.6	0.2	8	MS	•		B26080020.6()
B*	2.6	0.4	9	MS	•		B26090040.6()
B*	2.6	0.2	9.5	MS	•		B26095020.6()
A*	2.6	0.2	9.6	MS	•		A26096020.6()
B*	2.6	0.25	10	MS	•		B26100025.6()
B*	2.6	0.2	13.2	MS	•		B26132020.6()
A*	2.6	0.2	22.3	MS	1000		A26223020.6()
A*	2.6	0.2	31.3	MS	1000		A26313020.6()
A*	2.6	0.2	41.3	MS	1000		A26413020.6()
A*	2.6	0.2	51.3	MS	1000		A26513020.6()

Form	øD1 mm	S mm	L mm	Werkstoff Matière Material	Stand.-Packg.		Artikel-Nr. Numéro d'article Part-No.
					2'000	5'000	
A*	2.8	0.3	3.5	MS	•		A28035030.6()
A*	2.8	0.3	4.5	MS	•		A28045030.6()
B*	2.8	0.3	6	MS	•		B28060030.6()
A*	2.8	0.3	15.5	MS	•		A28155030.6()
B*	2.8	0.3	21.5	MS	1000		B28215030.6()
A*	2.8	0.3	36	MS	1000		A28360030.6()
B*	3	0.25	2	MS	•		B30020025.6()
A*	3	0.25	2.5	MS	•		A30025025.6()
B*	3	0.3	2.5	MS	•		B30025030.6()
B*	3	0.25	3	MS	•		B30030025.6()
A	3	0.3	3	MS	•		A30030030.6()
B	3	0.25	3.5	MS	•		B30035025.6()
A	3	0.3	3.5	MS	•		A30035030.6()
B	3	0.3	3.5	MS	•		B30035030.6()
A	3	0.5	3.5	MS	•		A30035050.6()
A	3	0.25	4	MS	•		A30040025.6()
B	3	0.3	4	AL	•		B30040030.10
A	3	0.3	4	MS	•		A30040030.6()
B	3	0.3	4	MS	•		B30040030.6()
B*	3	0.25	4.5	MS	•		B30045025.6()
A*	3	0.3	4.5	MS	•		A30045030.6()
B*	3	0.5	4.5	MS	•		B30045050.6()
A	3	0.25	5	MS	•		A30050025.6()
B	3	0.25	5	MS	•		B30050025.6()
A	3	0.3	5	MS	•		A30050030.6()
B	3	0.3	5	MS	•		B30050030.6()
A	3	0.3	5	ST	•		A30050030.9()
A*	3	0.4	5	MS	•		A30050040.6()
B*	3	0.4	5	MS	•		B30050040.6()
A	3	0.5	5	MS	•		A30050050.6()
B	3	0.5	5	MS	•		B30050050.6()
A*	3	0.3	5.5	MS	•		A30055030.6()
B*	3	0.3	5.5	MS	•		B30055030.6()
B	3	0.25	6	MS	•		B30060025.6()
A	3	0.3	6	MS	•		A30060030.6()
B	3	0.3	6	MS	•		B30060030.6()
B	3	0.3	6	ST	•		B30060030.9()
A*	3	0.4	6	MS	•		A30060040.6()
B	3	0.5	6	MS	•		B30060050.6()
B*	3	0.2	6.5	MS	•		B30065020.6()
A*	3	0.3	6.5	MS	•		A30065030.6()
B*	3	0.3	6.5	MS	•		B30065030.6()
B*	3	0.5	6.5	MS	•		B30065050.6()

Andere Abmessungen auf Anfrage
Nieteinsätze siehe Seite 584A

Autres dimensions sur demande
Pièces de rechange voir page 584A

Further dimensions on request
Inserts for pliers see page 584A



Form	øD1 mm	S mm	L mm	Werkstoff Matière Material	Stand.-Packg.		Artikel-Nr. Numéro d'article Part-No.
					1'000	2'000	
B*	3	0.2	7	MS		•	B30070020.6()
B	3	0.25	7	MS		•	B30070025.6()
A	3	0.3	7	AL		•	A30070030.10
B	3	0.3	7	AL		•	B30070030.10
A	3	0.3	7	MS		•	A30070030.6()
B	3	0.3	7	MS		•	B30070030.6()
A*	3	0.4	7	MS		•	A30070040.6()
B*	3	0.3	7.1	MS		•	B30071030.6()
B*	3	0.25	7.5	MS		•	B30075025.6()
A*	3	0.3	7.5	CU		•	A30075030.4()
A*	3	0.3	7.5	MS		•	A30075030.6()
B*	3	0.3	7.5	MS		•	B30075030.6()
B	3	0.25	8	MS		•	B30080025.6()
A	3	0.3	8	MS		•	A30080030.6()
B	3	0.3	8	MS		•	B30080030.6()
A*	3	0.3	8.5	MS		•	A30085030.6()
B*	3	0.3	8.5	MS		•	B30085030.6()
A*	3	0.3	8.8	CU		•	A30088030.4()
B*	3	0.25	9	MS		•	B30090025.6()
A*	3	0.3	9	MS		•	A30090030.6()
B*	3	0.3	9	MS		•	B30090030.6()
B*	3	0.25	9.5	MS		•	B30095025.6()
A	3	0.25	10	MS		•	A30100025.6()
B	3	0.25	10	MS		•	B30100025.6()
A	3	0.3	10	MS		•	A30100030.6()
B	3	0.3	10	MS		•	B30100030.6()
A	3	0.3	10	ST		•	A30100030.9()
B	3	0.3	10	ST		•	B30100030.9()
A	3	0.5	10	CU		•	A30100050.4()
A	3	0.5	10	MS		•	A30100050.6()
B	3	0.5	10	MS		•	B30100050.6()
A*	3	0.3	11	MS		•	A30110030.6()
B*	3	0.3	11	MS		•	B30110030.6()
A	3	0.3	12	MS		•	A30120030.6()
B	3	0.3	12	MS		•	B30120030.6()
A	3	0.3	12	ST		•	A30120030.9()
A	3	0.5	12	MS		•	A30120050.6()
A*	3	0.3	13	MS		•	A30130030.6()
B*	3	0.3	13	MS		•	B30130030.6()
A*	3	0.3	13	ST		•	A30130030.9()
A*	3	0.2	14	MS		•	A30140020.6()
A*	3	0.3	14	MS		•	A30140030.6()
B*	3	0.3	14	MS		•	B30140030.6()
B*	3	0.25	14.5	MS		•	B30145025.6()
A	3	0.3	15	MS		•	A30150030.6()
B	3	0.3	15	MS		•	B30150030.6()
B	3	0.5	15	MS		•	B30150050.6()
A*	3	0.3	16	MS		•	A30160030.6()
B*	3	0.3	16	MS		•	B30160030.6()
A*	3	0.25	16.5	MS		•	A30165025.6()
A*	3	0.3	17	MS		•	A30170030.6()
B*	3	0.3	17	MS		•	B30170030.6()
B	3	0.3	18	CU		•	B30180030.4()
A	3	0.3	18	MS		•	A30180030.6()
B	3	0.3	18	MS		•	B30180030.6()
B	3	0.5	18	MS		•	B30180050.6()
A*	3	0.2	18.8	MS		•	A30188020.6()
A*	3	0.3	19	MS		•	A30190030.6()
B*	3	0.3	19	MS		•	B30190030.6()
A	3	0.3	20	MS		•	A30200030.6()
B	3	0.3	20	MS		•	B30200030.6()
A*	3	0.3	21	MS		•	A30210030.6()
B*	3	0.3	21	MS		•	B30210030.6()
A	3	0.3	22	MS		•	A30220030.6()
B	3	0.3	22	MS		•	B30220030.6()
B	3	0.5	22	MS		•	B30220050.6()
B*	3	0.2	22.3	MS		•	B30223020.6()
A*	3	0.3	22.5	MS		•	A30225030.6()
A*	3	0.3	23	MS		•	A30230030.6()
B*	3	0.3	23	MS		•	B30230030.6()
A*	3	0.3	23.7	MS		•	A30237030.6()

Form	øD1 mm	S mm	L mm	Werkstoff Matière Material	Stand.-Packg.		Artikel-Nr. Numéro d'article Part-No.
					1'000	2'000	
A*	3	0.3	24	MS		•	A30240030.6()
B*	3	0.3	24	MS		•	B30240030.6()
B*	3	0.35	24	MS		•	B30240035.6()
A*	3	0.5	24.2	MS		•	A30242050.6()
A	3	0.25	25	MS		•	A30250025.6()
B	3	0.3	25	MS		•	B30250030.6()
B	3	0.5	25	MS		•	B30250050.6()
B*	3	0.2	26	MS		•	B30260020.6()
B*	3	0.3	26	MS		•	B30260030.6()
B*	3	0.25	27	MS		•	B30270025.6()
A*	3	0.3	27	MS		•	A30270030.6()
B*	3	0.3	27	MS		•	B30270030.6()
B	3	0.3	28	MS		•	B30280030.6()
A*	3	0.3	29	MS		•	A30290030.6()
B	3	0.3	30	MS		•	B30300030.6()
A*	3	0.3	31	MS		•	A30310030.6()
A	3	0.3	35	MS		•	A30350030.6()
B	3	0.5	35	MS	500	•	B30350050.6()
B	3	0.3	40	MS	500	•	B30400030.6()
B*	3	0.35	42.5	MS	500	•	B30425035.6()
A*	3	0.3	48	MS	500	•	A30480030.6()
B	3	0.3	50	MS	500	•	B30500030.6()
B*	3	0.35	74.5	MS	500	•	B30745035.6()
B*	3.2	0.2	5	MS		•	B32050020.6()
B*	3.2	0.2	8	MS		•	B32080020.6()
B*	3.2	0.2	11	MS		•	B32110020.6()
B*	3.2	0.2	13	MS		•	B32130020.6()
B*	3.2	0.2	17	MS		•	B32170020.6()
B*	3.2	0.2	18	MS		•	B32180020.6()
A*	3.2	0.2	18.5	MS		•	A32185020.6()
B*	3.2	0.2	23.2	MS		•	B32232020.6()
B*	3.2	0.2	24.2	MS		•	B32242030.6()
C*	3.2	0.2	25	MS		•	C32250020.6()
B*	3.2	0.2	32	MS		•	B32320020.6()
B*	3.2	0.2	34	MS		•	B32340020.6()
B*	3.5	0.3	2	AL		•	B35020030.10
B*	3.5	0.3	3	MS		•	B35030030.6()
B*	3.5	0.3	3.5	MS		•	B35035030.6()
B*	3.5	0.25	4	MS		•	B35040025.6()
A*	3.5	0.3	4	MS		•	A35040030.6()
B*	3.5	0.3	4	MS		•	B35040030.6()
B*	3.5	0.3	4.5	MS		•	B35045030.6()
A*	3.5	0.3	5	MS		•	A35050030.6()
B*	3.5	0.3	5	MS		•	B35050030.6()
B*	3.5	0.3	5.5	MS		•	B35055030.6()
A*	3.5	0.3	6	MS		•	A35060030.6()
B*	3.5	0.3	6	MS		•	B35060030.6()
B*	3.5	0.3	7	MS		•	B35070030.6()
A*	3.5	0.3	8	MS		•	A35080030.6()
B*	3.5	0.3	8	MS		•	B35080030.6()
B*	3.5	0.3	9	MS		•	B35090030.6()
B*	3.5	0.3	10	MS		•	B35100030.6()
B*	3.5	0.3	11	MS		•	B35110030.6()
A*	3.5	0.3	13	MS		•	A35130030.6()
A*	3.5	0.3	15	MS		•	A35150030.6()
B*	3.5	0.3	15	MS		•	B35150030.6()
A*	3.5	0.3	16	MS		•	A35160030.6()
A*	3.5	0.3	17	MS		•	A35170030.6()
A*	3.5	0.3	18	MS		•	A35180030.6()
A*	3.5	0.3	18.5	MS		•	A35185030.6()
A*	3.5	0.3	40	MS		•	A35400030.6()
A*	3.5	0.3	50	MS	500	•	A35500030.6()
A*	3.8	0.3	9.5	MS		•	A38095030.6()
A*	3.8	0.3	10.2	MS		•	A38102030.6()
A*	3.8	0.3	14.2	MS		•	A38142030.6()

Andere Abmessungen auf Anfrage
Nieteinsätze siehe Seite 584A

Autres dimensions sur demande
Pièces de rechange voir page 584A

Further dimensions on request
Inserts for pliers see page 584A